

PARTS LIST

CONTENTS

■ USING PW BOARD & REMOTE CONTROL UNIT	21
■ EXPLODED VIEW PARTS LIST	22
■ EXPLODED VIEW	23
■ PRINTED WIRING BOARD PARTS LIST	

[AV-21BF11ENS]

● MAIN PW BOARD ASS'Y	24
● FRONT AV & HEADPHONE PW BOARD ASS'Y	27

[AV-21BF11EES]

● MAIN PW BOARD ASS'Y	28
● FRONT AV & HEADPHONE PW BOARD ASS'Y	31

[AV-21BF11EPS]

● MAIN PW BOARD ASS'Y	32
● FRONT AV & HEADPHONE PW BOARD ASS'Y	35

[AV-21BF11EJS]

● MAIN PW BOARD ASS'Y	36
● FRONT AV & HEADPHONE PW BOARD ASS'Y	39

■ PACKING / PACKING PARTS LIST	40
--------------------------------------	----

USING PW BOARD & REMOTE CONTROL UNIT

PWB ASS'Y / Model	AV-21BF11ENS	AV-21BF11EES	AV-21BF11EPS	AV-21BF11EJS
MAIN PWB (within CRT SOCKET PWB)	VE-20101119	VE-20101113	VE-20101120	VE-20101540
FRONT AV & HEADPHONE PWB	VE-20101564	←	←	←
REMOTE CONTROL UNIT	VE-30017763 (RM-C1100)	←	←	←

AV-21BF11ENS
 AV-21BF11EES
 AV-21BF11EPS
 AV-21BF11EJS

EXPLODED VIEW PARTS LIST

△ Ref.No.	Part No.	Part Name	Description
△ V01	VE-30017634	PICTURE TUBE (ITC)	
△ L01	VE-30015162	DEG COIL & EARTH CB.	
1	VE-35000013	SPRING ON/OFF SWITCH	
2	VE-20069092	BUTTON ON/OFF SILVER	
3	VE-40000026	EJECTOR CLIP-CLAP	
4	VE-20093213	FRONT PANEL DOOR	
△ 5	VE-20085992	FRONT CABINET	
△ 6	VE-20083702	LENS LED PREAMP	
△ 7	VE-20069080	BUTTON FUNCTION SILVER	
8	VE-35004951	SB HOLDER BRACKET	
9	VE-35000224	SCREW (2.9X9.5)	(X1)
10	VE-30001946	SPEAKER 8R 15W (57X160)	(X2)
11	VE-25000224	SCREW (2.9X9.5)	(X4)
12	VE-35001777	SCREW (5X30)	(X4)
△ 13	VE-30017848	SWITCH ON/OFF 2.5A/100A	
14	VE-35000224	SCREW (2.9X9.5)	(X1)
△ 15	VE-20096926	REAR COVER	
16	VE-35004572	SCREW (4X20)	(X6)
△ 17	VE-20101395	RATING LABEL	(AV-21BF11ENS)
△ 17	VE-20101548	RATING LABEL	(AV-21BF11EPS)
△ 17	VE-20101660	RATING LABEL	(AV-21BF11EES)
△ 17	VE-20101560	RATING LABEL	(AV-21BF11EES POLAND)
△ 17	VE-20101872	RATING LABEL	(AV-21BF11EJS)
18	VE-40009153	LOGO JVC	

EXPLODED VIEW

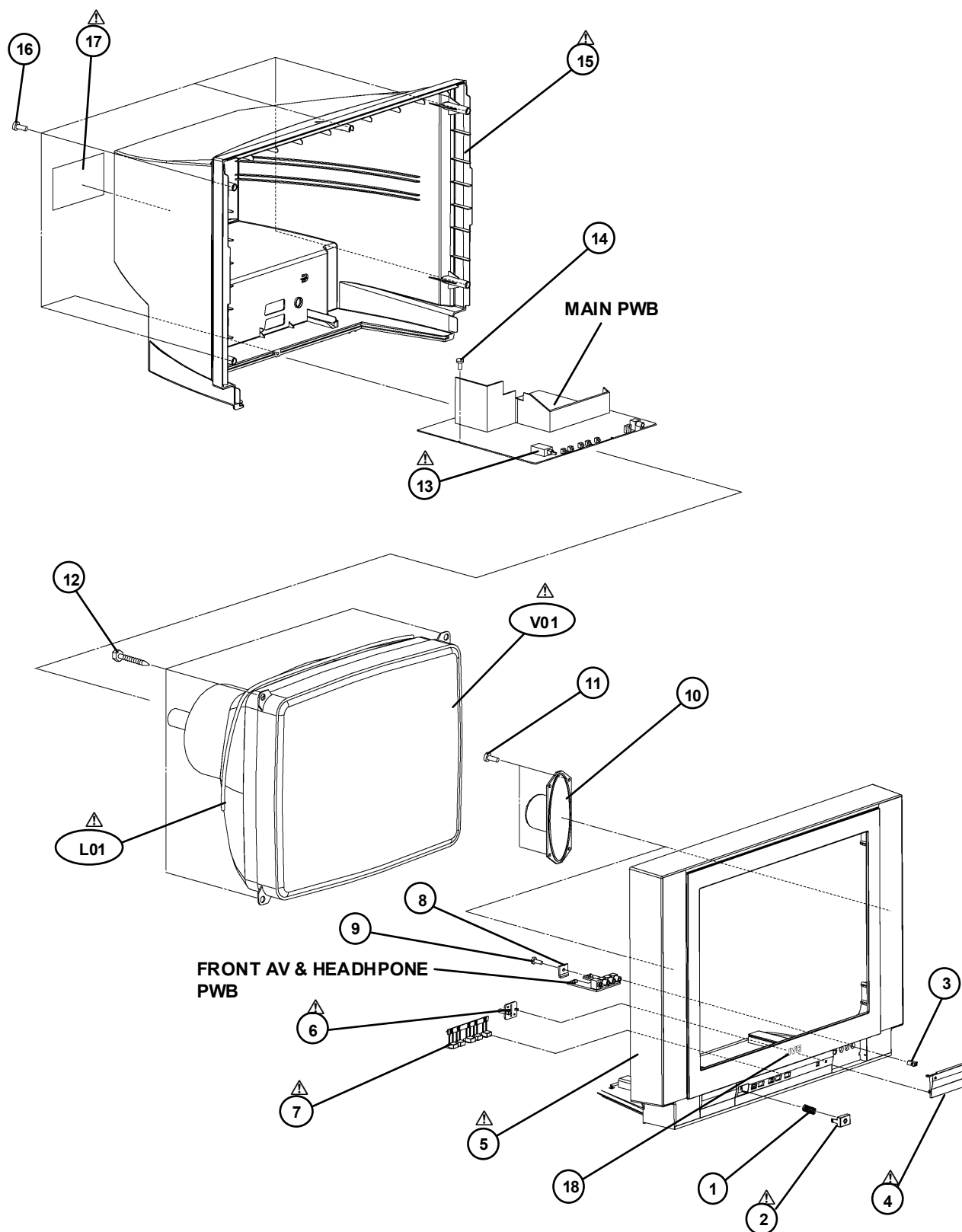

PRINTED WIRING BOARD PARTS LIST

[AV-21BF11ENS]

MAIN P.W. BOARD ASS'Y (VE-20101119)

△ Symbol No.	Part No.	Part Name	Description
RESISTOR			
R105	VE-30000792	CF RES.	1/4W 75R J
R109	VE-30012713	SMD RES.	1/16W 75R J
R110	VE-30012713	SMD RES.	1/16W 75R J
R113	VE-30012713	SMD RES.	1/16W 75R J
R114	VE-30012713	SMD RES.	1/16W 75R J
R115	VE-30012713	SMD RES.	1/16W 75R J
R116	VE-30012987	SMD RES.	1/16W 56R J
R117	VE-30012713	SMD RES.	1/16W 75R J
R118	VE-30000792	CF RES.	1/4W 75R J
R122	VE-30000792	CF RES.	1/4W 75R J
R123	VE-30000792	CF RES.	1/4W 75R J
R126	VE-30012695	SMD RES.	1/16W 470R J
R127	VE-30000459	CF RES.	1/4W 100R J
R129	VE-30012713	SMD RES.	1/16W 75R J
R135	VE-30012657	SMD RES.	1/16W 1K J
R139	VE-30012713	SMD RES.	1/16W 75R J
R140	VE-30012987	SMD RES.	1/16W 56R J
R141	VE-30012695	SMD RES.	1/16W 470R J
R142	VE-30000459	CF RES.	1/4W 100R J
R145	VE-30012713	SMD RES.	1/16W 75R J
R149	VE-30000752	CF RES.	1/4W 56K J
R151	VE-30012696	SMD RES.	1/16W 47K J
R152	VE-30000752	CF RES.	1/4W 56K J
R153	VE-30012657	SMD RES.	1/16W 1K J
R154	VE-30000723	CF RES.	1/4W 47K J
R155	VE-30012649	SMD RES.	1/16W 150R J
R201	VE-30012674	SMD RES.	1/16W 27K J
R202	VE-30012692	SMD RES.	1/16W 4.7K J
R204	VE-30000459	CF RES.	1/4W 100R J
R206	VE-30000459	CF RES.	1/4W 100R J
R301	VE-30000471	CF RES.	1/4W 10K J
R302	VE-30000471	CF RES.	1/4W 10K J
R303	VE-30012641	SMD RES.	1/16W 10K J
R305	VE-30012641	SMD RES.	1/16W 10K J
R306	VE-30012509	SMD RES.	1/16W 100K J
R417	VE-30012510	SMD RES.	1/16W 100R J
R418	VE-30012510	SMD RES.	1/16W 100R J
R419	VE-30012649	SMD RES.	1/16W 150R J
R420	VE-30000466	CF RES.	1/4W 1K J
R421	VE-30012650	SMD RES.	1/16W 15K J
R422	VE-30012659	SMD RES.	1/16W 2.2K J
R423	VE-30012712	SMD RES.	1/16W 8.2K J
R424	VE-30000712	CF RES.	1/4W 470R J
R425	VE-30000583	CF RES.	1/4W 220R J
R426	VE-30012659	SMD RES.	1/16W 2.2K J
R427	VE-30012674	SMD RES.	1/16W 27K J
R428	VE-30000792	CF RES.	1/4W 75R J
R431	VE-30012674	SMD RES.	1/16W 27K J
R432	VE-30012657	SMD RES.	1/16W 1K J
R433	VE-30012667	SMD RES.	1/16W 220K J
R437	VE-30000466	CF RES.	1/4W 1K J
R438	VE-30000466	CF RES.	1/4W 1K J
R439	VE-30012657	SMD RES.	1/16W 1K J
R440	VE-30012714	SMD RES.	1/16W 820R J
R441	VE-30012656	SMD RES.	1/16W 18K J
R442	VE-30000466	CF RES.	1/4W 1K J
R446	VE-30012714	SMD RES.	1/16W 820R J
R447	VE-30012714	SMD RES.	1/16W 820R J
R448	VE-30012683	SMD RES.	1/16W 330K J
R449	VE-30012662	SMD RES.	1/16W 2.7K J
R450	VE-30000712	CF RES.	1/4W 470R J
R455	VE-30012650	SMD RES.	1/16W 15K J
R458	VE-30012662	SMD RES.	1/16W 2.7K J
R459	VE-30012510	SMD RES.	1/16W 100R J
R460	VE-30012510	SMD RES.	1/16W 100R J
R461	VE-30012510	SMD RES.	1/16W 100R J
R463	VE-30012692	SMD RES.	1/16W 4.7K J
R464	VE-30012650	SMD RES.	1/16W 15K J
R469	VE-30000670	CF RES.	1/4W 330K J
R470	VE-30012683	SMD RES.	1/16W 330K J
R474	VE-30012692	SMD RES.	1/16W 4.7K J
R475	VE-30012510	SMD RES.	1/16W 100R J
R476	VE-30012707	SMD RES.	1/16W 680R J
R477	VE-30014022	SMD RES.	1/16W 47R J
R502	VE-30012695	SMD RES.	1/16W 470R J
R503	VE-30012707	SMD RES.	1/16W 680R J
R504	VE-30012679	SMD RES.	1/16W 3.9K J
R505	VE-30012673	SMD RES.	1/16W 270R J
R506	VE-30012506	SMD RES.	1/16W 1.5K J

△ Symbol No.	Part No.	Part Name	Description
RESISTOR			
R507	VE-30012657	SMD RES.	1/16W 1K J
R508	VE-30000706	CF RES.	1/4W 47R J
R509	VE-30012641	SMD RES.	1/16W 10K J
R510	VE-30000622	CF RES.	1/4W 270R J
R511	VE-30012657	SMD RES.	1/16W 1K J
R512	VE-30012504	SMD RES.	1/16W 1.2K J
R513	VE-30000459	CF RES.	1/4W 100R J
R514	VE-30000459	CF RES.	1/4W 100R J
R515	VE-30012692	SMD RES.	1/16W 4.7K J
R516	VE-30012692	SMD RES.	1/16W 4.7K J
R517	VE-30012692	SMD RES.	1/16W 4.7K J
R518	VE-30000471	CF RES.	1/4W 10K J
R519	VE-30012698	SMD RES.	1/16W 5.6K J
R525	VE-30000583	CF RES.	1/4W 220R J
R526	VE-30012641	SMD RES.	1/16W 10K J
R527	VE-30000718	CF RES.	1/4W 4.7K J
R528	VE-30012698	SMD RES.	1/16W 5.6K J
R530	VE-30012698	SMD RES.	1/16W 5.6K J
R531	VE-30012692	SMD RES.	1/16W 4.7K J
R532	VE-30012659	SMD RES.	1/16W 2.2K J
R533	VE-30012644	SMD RES.	1/16W 12K J
R534	VE-30000526	CF RES.	1/4W 1.5K J
R535	VE-30000718	CF RES.	1/4W 4.7K J
R536	VE-30000471	CF RES.	1/4W 10K J
R537	VE-30012641	SMD RES.	1/16W 10K J
R538	VE-30012698	SMD RES.	1/16W 5.6K J
R539	VE-30012659	SMD RES.	1/16W 2.2K J
R540	VE-30012644	SMD RES.	1/16W 12K J
R545	VE-30012644	SMD RES.	1/16W 12K J
R546	VE-30000560	CF RES.	1/4W 1.8K J
R547	VE-30012659	SMD RES.	1/16W 2.2K J
R548	VE-30012641	SMD RES.	1/16W 10K J
R555	VE-30012659	SMD RES.	1/16W 2.2K J
R556	VE-30012657	SMD RES.	1/16W 1K J
R559	VE-30000470	CF RES.	1/2W 10K J
R560	VE-30012669	SMD RES.	1/16W 22K J
R561	VE-30012692	SMD RES.	1/16W 4.7K J
R562	VE-30000471	CF RES.	1/4W 10K J
R564	VE-30012641	SMD RES.	1/16W 10K J
R601	VE-30000752	CF RES.	1/4W 56K J
R602	VE-30000820	CF RES.	1/4W 82K J
R605	VE-30000477	CF RES.	1/4W 100K J
R612	VE-30012692	SMD RES.	1/16W 4.7K J
R613	VE-30012692	SMD RES.	1/16W 4.7K J
R618	VE-30012508	SMD RES.	1/16W 1.8K J
R619	VE-30012641	SMD RES.	1/16W 10K J
R623	VE-30000607	CF RES.	1/4W 2.2R J
R624	VE-30001120	MO RES.	2W 22R J
R625	VE-30000900	MF RES.	1/4W 1.8K J
R627	VE-30000929	MF RES.	1/2W 2.2R G
R630	VE-30000828	CF RES.	1/4W 8.2M J
R631	VE-30000885	MF RES.	1/4W 1.5K J
R633	VE-30000650	CF RES.	1/4W 33R J
R634	VE-30012641	SMD RES.	1/16W 10K J
R637	VE-30000621	CF RES.	1/2W 270R J
R638	VE-30000612	CF RES.	1/4W 2.4K J
R639	VE-30000718	CF RES.	1/4W 4.7K J
R640	VE-30012662	SMD RES.	1/16W 2.7K J
R641	VE-30012649	SMD RES.	1/16W 150R J
R645	VE-30018904	MO RES.	5W 4.7K J
R646	VE-30014941	CF RES.	1/4W 16K J
R647	VE-30000466	CF RES.	1/4W 1K J
△ R648	VE-30001249	FUSE RES.	1W 4.7R J
R649	VE-30000500	CF RES.	1/4W 12K J
R650	VE-30000744	CF RES.	1/4W 560R J
R654	VE-30000458	CF RES.	1/2W 100R J
R655	VE-30000705	CF RES.	1/2W 47R J
R657	VE-30012656	SMD RES.	1/16W 18K J
R659	VE-30001151	MO RES.	3W 330R J
R660	VE-30012669	SMD RES.	1/16W 22K J
R661	VE-30012674	SMD RES.	1/16W 27K J
R662	VE-30000712	CF RES.	1/4W 470R J
R663	VE-30000459	CF RES.	1/4W 100R J
R664	VE-30007779	MO RES.	5W 47R J (RADIAL)
R665	VE-30012708	SMD RES.	1/16W 68K J
R666	VE-30001099	MO RES.	2W 15R J
R701	VE-30000459	CF RES.	1/4W 100R J
R703	VE-30000459	CF RES.	1/4W 100R J
R705	VE-30000459	CF RES.	1/4W 100R J

[AV-21BF11ENS]

△ Symbol No.	Part No.	Part Name	Description
RESISTOR			
R715	VE-30012695	SMD RES.	1/16W 470R J
R717	VE-30012695	SMD RES.	1/16W 470R J
R719	VE-30012657	SMD RES.	1/16W 1K J
R721	VE-30000459	CF RES.	1/4W 100R J
R722	VE-30000459	CF RES.	1/4W 100R J
R723	VE-30012510	SMD RES.	1/16W 100R J
R724	VE-30012510	SMD RES.	1/16W 100R J
R725	VE-30012657	SMD RES.	1/16W 1K J
R726	VE-30012657	SMD RES.	1/16W 1K J
R727	VE-30012657	SMD RES.	1/16W 1K J
R728	VE-30012657	SMD RES.	1/16W 1K J
R729	VE-30012657	SMD RES.	1/16W 1K J
R730	VE-30012657	SMD RES.	1/16W 1K J
R731	VE-30012657	SMD RES.	1/16W 1K J
R801	VE-30000466	CF RES.	1/4W 1K J
R803	VE-30012659	SMD RES.	1/16W 2.2K J
R804	VE-30000477	CF RES.	1/4W 100K J
R805	VE-30000452	CF RES.	1/4W 10R J
R806	VE-30007199	MF RES.	1/4W 4.3K F
R807	VE-30001130	MO RES.	1/2W 0.22R J
R809	VE-30007784	MO RES.	5W 33K J (RADIAL)
△ R810	VE-30001257	MG RES.	1/2W 4.7M J
R811	VE-30000594	CF RES.	1/4W 22K J
R813	VE-30000718	CF RES.	1/4W 4.7K J
R814	VE-30012662	SMD RES.	1/16W 2.7K J
R815	VE-30000452	CF RES.	1/4W 10R J
R817	VE-30001037	MF RES.	1/4W 99K F
R818	VE-30006463	MF RES.	1/4W 2K F
R819	VE-30000810	CF RES.	1/4W 820R J
R821	VE-30000470	CF RES.	1/2W 10K J
R828	VE-30001260	WW RES.	5W 2.2R J
R829	VE-30000718	CF RES.	1/4W 4.7K J
R830	VE-30012657	SMD RES.	1/16W 1K J
R831	VE-30012669	SMD RES.	1/16W 22K J
R834	VE-30012641	SMD RES.	1/16W 10K J
R835	VE-30016802	WW RES.	5W 5.6R J RAD.
R900	VE-30006712	FERRITE BEAD	3.5X4.7X0.8
R901	VE-30006712	FERRITE BEAD	3.5X4.7X0.8
R902	VE-30006712	FERRITE BEAD	3.5X4.7X0.8
R903	VE-30000525	CF RES.	1/2W 1.5K J
R904	VE-30000525	CF RES.	1/2W 1.5K J
R905	VE-30000525	CF RES.	1/2W 1.5K J
△ R906	VE-30000525	CF RES.	1/2W 1.5K J
△ R919	VE-30001230	FUSE RES.	1/2W 27R J

CAPACITOR

C141	VE-30000384	EL CAP.	2.2UF 50V M
C142	VE-30000384	EL CAP.	2.2UF 50V M
C143	VE-30012589	SMD CAP.	4.7NF 50V K
C144	VE-30012589	SMD CAP.	4.7NF 50V K
C145	VE-30012589	SMD CAP.	4.7NF 50V K
C146	VE-30012589	SMD CAP.	4.7NF 50V K
C147	VE-30012589	SMD CAP.	4.7NF 50V K
C148	VE-30012589	SMD CAP.	4.7NF 50V K
C149	VE-30012589	SMD CAP.	4.7NF 50V K
C150	VE-30012589	SMD CAP.	4.7NF 50V K
C155	VE-30012560	SMD CAP.	100PF 50V J
C157	VE-30012560	SMD CAP.	100PF 50V J
C159	VE-30012560	SMD CAP.	100PF 50V J
C160	VE-30000387	EL CAP.	33UF 50V M
C161	VE-30000362	EL CAP.	1UF 50V M
C162	VE-30000362	EL CAP.	1UF 50V M
C201	VE-30000400	EL CAP.	47UF 50V M
C205	VE-30000371	EL CAP.	22UF 50V M
C206	VE-30012610	SMD CAP.	10NF 50V J
C207	VE-30012610	SMD CAP.	10NF 50V J
C300	VE-30000400	EL CAP.	47UF 50V M
C302	VE-30000092	MKT CAP.	220NF 63V J
C305	VE-30000092	MKT CAP.	220NF 63V J
C404	VE-30000225	CER CAP.	220PF 50V J SL
C408	VE-30012586	SMD CAP.	22NF 50V K
C409	VE-30000345	EL CAP.	10UF 50V M
C410	VE-30000384	EL CAP.	2.2UF 50V M
C411	VE-30000345	EL CAP.	10UF 50V M
C412	VE-30012586	SMD CAP.	22NF 50V K
C413	VE-30000362	EL CAP.	1UF 50V M
C414	VE-30012585	SMD CAP.	2.2NF 50V K R
C415	VE-30012581	SMD CAP.	1NF 50V K R
C416	VE-30000362	EL CAP.	1UF 50V M
C417	VE-30000362	EL CAP.	1UF 50V M

△ Symbol No.	Part No.	Part Name	Description
CAPACITOR			
C418	VE-30012586	SMD CAP.	22NF 50V K
C419	VE-30000413	EL CAP.	4.7UF 50V M
C420	VE-30000100	MKT CAP.	330NF 63V J
C422	VE-30000400	EL CAP.	47UF 50V M
C423	VE-30000400	EL CAP.	47UF 50V M
C424	VE-30000345	EL CAP.	10UF 50V M
C425	VE-30012586	SMD CAP.	22NF 50V K
C426	VE-30016654	SMD CAP.	100NF 16V K R
C427	VE-30016654	SMD CAP.	100NF 16V K R
C429	VE-30012589	SMD CAP.	4.7NF 50V K
C431	VE-30000362	EL CAP.	1UF 50V M
C432	VE-30012586	SMD CAP.	22NF 50V K
C433	VE-30000345	EL CAP.	10UF 50V M
C434	VE-30016654	SMD CAP.	100NF 16V K R
C435	VE-30016654	SMD CAP.	100NF 16V K R
C436	VE-30000384	EL CAP.	2.2UF 50V M
C437	VE-30016654	SMD CAP.	100NF 16V K R
C438	VE-30016654	SMD CAP.	100NF 16V K R
C439	VE-30016654	SMD CAP.	100NF 16V K R
C440	VE-30000074	MKT CAP.	100NF 63V J
C441	VE-30012582	SMD CAP.	10NF 50V K R
C442	VE-30000384	EL CAP.	2.2UF 50V M
C443	VE-30000362	EL CAP.	1UF 50V M
C444	VE-30000384	EL CAP.	2.2UF 50V M
C448	VE-30012586	SMD CAP.	22NF 50V K
C449	VE-30012567	SMD CAP.	220PF 50V J
C451	VE-30012581	SMD CAP.	1NF 50V K R
C452	VE-30012581	SMD CAP.	1NF 50V K R
C454	VE-30012573	SMD CAP.	47PF 50V J
C455	VE-30012573	SMD CAP.	47PF 50V J
C456	VE-30012573	SMD CAP.	47PF 50V J
C459	VE-30012575	SMD CAP.	4.7PF 50V C GH
C460	VE-30000345	EL CAP.	10UF 50V M
C502	VE-30000396	EL CAP.	47UF 16V M
C504	VE-30012586	SMD CAP.	22NF 50V K
C505	VE-30012589	SMD CAP.	4.7NF 50V K
C510	VE-30012586	SMD CAP.	22NF 50V K
C511	VE-30012566	SMD CAP.	22PF 50V J
C513	VE-30000371	EL CAP.	22UF 50V M
C514	VE-30012586	SMD CAP.	22NF 50V K
C515	VE-30012579	SMD CAP.	82PF 50V J
C517	VE-30012586	SMD CAP.	22NF 50V K
C518	VE-30012586	SMD CAP.	22NF 50V K
C519	VE-30000352	EL CAP.	100UF 16V M
C520	VE-30012560	SMD CAP.	100PF 50V J
C521	VE-30012562	SMD CAP.	15PF 50V J
C522	VE-30012562	SMD CAP.	15PF 50V J
C523	VE-30012585	SMD CAP.	2.2NF 50V K R
C525	VE-30012566	SMD CAP.	22PF 50V J
C526	VE-30012586	SMD CAP.	22NF 50V K
C530	VE-30012589	SMD CAP.	4.7NF 50V K
C531	VE-30000384	EL CAP.	2.2UF 50V M
C532	VE-30012586	SMD CAP.	22NF 50V K
C536	VE-30000074	MKT CAP.	100NF 63V J
C541	VE-30000109	MKT CAP.	470NF 63V J
C542	VE-30000205	CER CAP.	150PF 50V J SL
C543	VE-30000205	CER CAP.	150PF 50V J SL
C545	VE-30012607	SMD CAP.	150PF 50V J
C603	VE-30000384	EL CAP.	2.2UF 50V M
C604	VE-30000400	EL CAP.	47UF 50V M
C608	VE-30000107	MKT CAP.	47NF 250V J
C610	VE-30018901	EL CAP.	100UF 50V M 105°
C611	VE-30000092	MKT CAP.	220NF 63V J
C613	VE-30016085	EL CAP.	10UF 63V 105°
C615	VE-30000359	EL CAP.	100UF 16V M
C616	VE-30000400	EL CAP.	47UF 50V M
△ C618	VE-30000134	MKP CAP.	11NF 2000V %3.5
C619	VE-30000131	MKP CAP.	100NF 250V J
C623	VE-30000404	EL CAP.	47UF 160V M (HR)
C624	VE-30000350	EL CAP.	10UF 250V M
C627	VE-30000150	MKP CAP.	270NF 250V J 15/22.5MM
C628	VE-30018380	EL CAP.	3.3UF 160V M (105°)
C631	VE-30000410	EL CAP.	470UF 50V M
C632	VE-30000100	MKT CAP.	330NF 63V J
C634	VE-30000409	EL CAP.	470UF 25V M
C635	VE-30000100	MKT CAP.	330NF 63V J
C636	VE-30000400	EL CAP.	47UF 50V M
C638	VE-30012581	SMD CAP.	1NF 50V K R
C639	VE-30000433	CER CAP.	1NF 1KV M B
C641	VE-30000345	EL CAP.	10UF 50V M
C642	VE-30012609	SMD CAP.	68NF 50V K
C643	VE-30000116	MKT CAP.	68NF 63V J

[AV-21BF11ENS]

Symbol No.	Part No.	Part Name	Description
------------	----------	-----------	-------------

CAPACITOR

C644	VE-30000362	EL CAP.	1UF 50V M
C700	VE-30012565	SMD CAP.	1.8PF 50V J CH
C701	VE-30012565	SMD CAP.	1.8PF 50V J CH
C702	VE-30012573	SMD CAP.	47PF 50V J
C703	VE-30012573	SMD CAP.	47PF 50V J
C704	VE-30012576	SMD CAP.	56PF 50V J CH
C705	VE-30000345	EL CAP.	10UF 50V M
C706	VE-30000345	EL CAP.	10UF 50V M
C707	VE-30012573	SMD CAP.	47PF 50V J
C708	VE-30012586	SMD CAP.	22NF 50V K
C710	VE-30012573	SMD CAP.	47PF 50V J
C712	VE-30000345	EL CAP.	10UF 50V M
C713	VE-30016654	SMD CAP.	100NF 16V K R
C714	VE-30016654	SMD CAP.	100NF 16V K R
C716	VE-30016654	SMD CAP.	100NF 16V K R
C717	VE-30016654	SMD CAP.	100NF 16V K R
C718	VE-30016654	SMD CAP.	100NF 16V K R
C719	VE-30012586	SMD CAP.	22NF 50V K
C720	VE-30000345	EL CAP.	10UF 50V M
C721	VE-30016654	SMD CAP.	100NF 16V K R
C723	VE-30016654	SMD CAP.	100NF 16V K R
C724	VE-30000345	EL CAP.	10UF 50V M
C729	VE-30016654	SMD CAP.	100NF 16V K R
C730	VE-30000393	EL CAP.	3.3UF 50V M
C733	VE-30000345	EL CAP.	10UF 50V M
C734	VE-30000345	EL CAP.	10UF 50V M
C735	VE-30012586	SMD CAP.	22NF 50V K
C736	VE-30000345	EL CAP.	10UF 50V M
C737	VE-30000109	MKT CAP.	470NF 63V J
C738	VE-30000109	MKT CAP.	470NF 63V J
C739	VE-30000109	MKT CAP.	470NF 63V J
C740	VE-30000109	MKT CAP.	470NF 63V J
C741	VE-30012585	SMD CAP.	2.2NF 50V K R
C742	VE-30012585	SMD CAP.	2.2NF 50V K R
C748	VE-30012560	SMD CAP.	100PF 50V J
△ C801	VE-30000094	MKT CAP.	220NF 275V M AC
△ C802	VE-30000094	MKT CAP.	220NF 275V M AC
△ C803	VE-30000433	CER CAP.	1NF 1KV M B
△ C804	VE-30000433	CER CAP.	1NF 1KV M B
C808	VE-30000295	CER CAP.	100NF 50V Z F
C809	VE-30000418	EL CAP.	100UF 400V M
C810	VE-30000400	EL CAP.	47UF 50V M
C811	VE-30000161	MKT CAP.	47NF 630V J
C812	VE-30007308	CER CAP.	220PF 1KV K (PULSE)
C813	VE-30000295	CER CAP.	100NF 50V Z F
△ C816	VE-30000447	CER CAP.	4.7NF 4KV M E
C817	VE-30000198	CER CAP.	120PF 500V J SL
C818	VE-30016654	SMD CAP.	100NF 16V K R
C819	VE-30012609	SMD CAP.	68NF 50V K
C822	VE-30009208	CER CAP.	470PF 1KV K (PULSE)
C824	VE-30000433	CER CAP.	1NF 1KV M B
C826	VE-30000404	EL CAP.	47UF 160V M (HR)
C827	VE-30000411	EL CAP.	470UF 16V M
C828	VE-30000295	CER CAP.	100NF 50V Z F
C829	VE-30000407	EL CAP.	470UF 16V M
C830	VE-30000382	EL CAP.	2200UF 16V M
C831	VE-30000431	CER CAP.	100PF 1KV M
C832	VE-30000295	CER CAP.	100NF 50V Z F
C833	VE-30000407	EL CAP.	470UF 16V M
C834	VE-30000295	CER CAP.	100NF 50V Z F
C836	VE-30000431	CER CAP.	100PF 1KV M
C838	VE-30000352	EL CAP.	100UF 16V M
C839	VE-30000352	EL CAP.	100UF 16V M
C840	VE-30000352	EL CAP.	100UF 16V M
C843	VE-30000431	CER CAP.	100PF 1KV M
C848	VE-30000352	EL CAP.	100UF 16V M
C849	VE-30000352	EL CAP.	100UF 16V M
C850	VE-30000352	EL CAP.	100UF 16V M
C855	VE-30000407	EL CAP.	470UF 16V M
C856	VE-30000433	CER CAP.	1NF 1KV M B
C858	VE-30007308	CER CAP.	220PF 1KV K (PULSE)
C859	VE-30013533	CER CAP.	100PF 1KV K (PULSE)
C907	VE-30000434	CER CAP.	1NF 2KV K B
C908	VE-30000415	EL CAP.	4.7UF 250V M
C912	VE-30000075	MKT CAP.	100NF 250V K (DC)

TRANSF

△ TR601	VE-30017788	FBT TRF
△ TR802	VE-30018592	SMPS TRF

Symbol No.	Part No.	Part Name	Description
------------	----------	-----------	-------------

COIL

L101	VE-30001971	FERRITE BEAT	
L102	VE-30001971	FERRITE BEAT	
L103	VE-30001971	FERRITE BEAT	
L106	VE-30001971	FERRITE BEAT	
L107	VE-30001971	FERRITE BEAT	
L108	VE-30001971	FERRITE BEAT	
L109	VE-30001971	FERRITE BEAT	
L110	VE-30001971	FERRITE BEAT	
L111	VE-30001971	FERRITE BEAT	
L112	VE-30001971	FERRITE BEAT	
L113	VE-30001971	FERRITE BEAT	
L114	VE-30001971	FERRITE BEAT	
L115	VE-30001971	FERRITE BEAT	
L201	VE-30001979	FIXD COIL	1UH
L210	VE-30001971	FERRITE BEAT	
L211	VE-30001971	FERRITE BEAT	
L401	VE-30001971	FERRITE BEAT	
L402	VE-30001992	FIXD COIL	10UH
L403	VE-30001971	FERRITE BEAT	
L404	VE-30001990	FIXD COIL	6.8UH
L405	VE-30014048	ADJ. COIL	44MHZ
L406	VE-30001971	FERRITE BEAT	
L603	VE-30018501	LINEARITY COIL	100UH
L604	VE-30001971	FERRITE BEAT	
L700	VE-30001971	FERRITE BEAT	
L701	VE-30001971	FERRITE BEAT	
L702	VE-30001996	FIXD COIL	22UH
L703	VE-30001979	FIXD COIL	1UH
L704	VE-30001979	FIXD COIL	1UH
L802	VE-30001971	FERRITE BEAT	
L803	VE-30000580	CF RES.	1/4W 22R J
L805	VE-30001971	FERRITE BEAT	
L806	VE-30001971	FERRITE BEAT	
L807	VE-30001992	FIXD COIL	10UH
L809	VE-30001971	FERRITE BEAT	
L810	VE-30001992	FIXD COIL	10UH
L900	VE-30002171	PEAKING COIL	22UH K

DIODE

D101	VE-30007760	ZENER DIODE	
D102	VE-30007760	ZENER DIODE	
D103	VE-30007760	ZENER DIODE	
D104	VE-30007762	ZENER DIODE	
D106	VE-30001377	ZENER DIODE	
D118	VE-30009366	DIODE	
D300	VE-30001285	DIODE	
D301	VE-30001285	DIODE	
D405	VE-30007763	ZENER DIODE	
D407	VE-30001284	DIODE	
D408	VE-30001285	DIODE	
D409	VE-30007760	ZENER DIODE	
D410	VE-30007760	ZENER DIODE	
D411	VE-30007760	ZENER DIODE	
D501	VE-30001285	DIODE	
D505	VE-30001285	DIODE	
D506	VE-30001284	DIODE	
D509	VE-30001279	LED RED/GREEN	
D512	VE-30001285	DIODE	
D513	VE-30001339	ZENER DIODE	
D602	VE-30001329	DIODE	
D603	VE-30001285	DIODE	
D608	VE-30001318	DIODE	
D609	VE-30001318	DIODE	
D610	VE-30001318	DIODE	
D611	VE-30001285	DIODE	
D614	VE-30001318	DIODE	
D615	VE-30001285	DIODE	
D616	VE-30009699	ZENER DIODE	
D617	VE-30001285	DIODE	
D618	VE-30001285	DIODE	
D619	VE-30009699	ZENER DIODE	
D700	VE-30001285	DIODE	
D701	VE-30001369	ZENER DIODE	
D800	VE-30001318	DIODE	
D801	VE-30001347	ZENER DIODE	
D802	VE-30001318	DIODE	
D803	VE-30001315	DIODE	
D804	VE-30001285	DIODE	
D805	VE-30009366	DIODE	
D806	VE-30001315	DIODE	
D808	VE-30007681	DIODE	
D809	VE-30001329	DIODE	

[AV-21BF11ENS]

Symbol No.	Part No.	Part Name	Description
------------	----------	-----------	-------------

DIODE

D810	VE-20068028	HE. ASY.	
Δ D811	VE-30001329	DIODE	
Δ D812	VE-30001285	DIODE	
Δ D813	VE-30001329	DIODE	
Δ D837	VE-30001329	DIODE	
Δ D838	VE-30001329	DIODE	
D889	VE-30001384	TR	
D890	VE-30001329	DIODE	
D900	VE-30001318	DIODE	
D901	VE-30001318	DIODE	
D902	VE-30001318	DIODE	
D903	VE-30001344	ZENER DIODE	
D904	VE-30007760	ZENER DIODE	
D905	VE-30007760	ZENER DIODE	
D906	VE-30007760	ZENER DIODE	

TRANSISTOR

Q104	VE-30001457	TR	
Q106	VE-30001457	TR	
Q141	VE-30001457	TR	
Q142	VE-30001457	TR	
Q301	VE-30001458	TR	
Q302	VE-30001457	TR	
Q406	VE-30001457	TR	
Q503	VE-30001457	TR	
Q504	VE-30001458	TR	
Q601	VE-30013656	POWER TR	
Δ Q603	VE-30001448	TR	H. OUT
Q604	VE-30001457	TR	
Q606	VE-30001457	TR	
Q700	VE-30001458	TR	
Q801	VE-30001386	TR	
Q802	VE-30001457	TR	
Q804	VE-30001454	TR	

IC

IC118	VE-30001506	IC	
IC301	VE-30011824	IC	
IC403	VE-30014521	IC	
IC500	VE-20103782	IC	(MEMORY)
IC501	VE-20099539	IC	(MICOM)
IC502	VE-30001670	PREAMPLIFIER	
Δ IC600	VE-30015306	IC	
IC700	VE-30013658	IC	
IC800	VE-30011968	IC	
Δ IC801	VE-30015087	IC	
IC803	VE-30001500	IC	
IC804	VE-30001622	IC	
IC806	VE-30014346	IC	
IC900	VE-30015857	IC	

OTHER

Δ F801	VE-30001731	FUSE	2.5A
Δ PL903	VE-30001855	CRT SOCKET	
SG900	VE-30000428	SPARK GAP	300V
SG901	VE-30000428	SPARK GAP	300V
SG902	VE-30000428	SPARK GAP	300V
SW501	VE-30002178	TACK SWITCH	
SW502	VE-30002178	TACK SWITCH	
SW503	VE-30002178	TACK SWITCH	
SW504	VE-30002178	TACK SWITCH	
SW505	VE-30002178	TACK SWITCH	
Δ SW801	VE-30017848	SWITCH ON/OFF	2.5A/100A
Δ TH800	VE-30001270	PTC	9 OHM
Δ TR801	VE-30002100	LINE FILTER	
TU201	VE-30009637	TUNER	
X401	VE-30001749	XTAL	
X402	VE-30015592	XTAL	
X403	VE-30000074	MKT CAP.	100NF 63V J
X501	VE-30002851	XTAL	
X700	VE-30001756	XTAL	
Z401	VE-30001705	SAW FILTER	
Z402	VE-30015591	SAW FILTER	

**FRONT AV & HEADPHONE P.W. BOARD ASS'Y
(VE-20101564)**

Symbol No.	Part No.	Part Name	Description
------------	----------	-----------	-------------

RESISTOR

R108	VE-30000712	CF RES.	1/4W 470R J
R110	VE-30000712	CF RES.	1/4W 470R J
R113	VE-30000744	CF RES.	1/4W 560R J
R114	VE-30000744	CF RES.	1/4W 560R J
R115	VE-30000712	CF RES.	1/4W 470R J
R116	VE-30000712	CF RES.	1/4W 470R J

CAPACITOR

C103	VE-30000213	CER CAP.	180PF 50V J
C104	VE-30000213	CER CAP.	180PF 50V J
C106	VE-30000190	CER CAP.	100PF 50V J

COIL

L103	VE-30001996	FIXED COIL	22UH Q40 K
L104	VE-30001996	FIXED COIL	22UH Q40 K

OTHERS

CON102	VE-30001893	RCA JACK	
CON103	VE-30001891	RCA JACK	
CON104	VE-30001892	RCA JACK	
CON106	VE-30001900	HEADPHONE JACK	HP01/2/3/4/5/6

PRINTED WIRING BOARD PARTS LIST

[AV-21BF11EES]

MAIN P.W. BOARD ASS'Y (VE- 20101113)

△ Symbol No.	Part No.	Part Name	Description
RESISTOR			
R105	VE-30000792	CF RES.	1/4W 75R J
R109	VE-30012713	SMD RES.	1/16W 75R J
R110	VE-30012713	SMD RES.	1/16W 75R J
R113	VE-30012713	SMD RES.	1/16W 75R J
R114	VE-30012713	SMD RES.	1/16W 75R J
R115	VE-30012713	SMD RES.	1/16W 75R J
R116	VE-30012987	SMD RES.	1/16W 56R J
R117	VE-30012713	SMD RES.	1/16W 75R J
R118	VE-30000792	CF RES.	1/4W 75R J
R122	VE-30000792	CF RES.	1/4W 75R J
R123	VE-30000792	CF RES.	1/4W 75R J
R126	VE-30012695	SMD RES.	1/16W 470R J
R127	VE-30000459	CF RES.	1/4W 100R J
R129	VE-30012713	SMD RES.	1/16W 75R J
R135	VE-30012657	SMD RES.	1/16W 1K J
R139	VE-30012713	SMD RES.	1/16W 75R J
R140	VE-30012987	SMD RES.	1/16W 56R J
R141	VE-30012695	SMD RES.	1/16W 470R J
R142	VE-30000459	CF RES.	1/4W 100R J
R145	VE-30012713	SMD RES.	1/16W 75R J
R149	VE-30000752	CF RES.	1/4W 56K J
R151	VE-30012696	SMD RES.	1/16W 47K J
R152	VE-30000752	CF RES.	1/4W 56K J
R153	VE-30012657	SMD RES.	1/16W 1K J
R154	VE-30000723	CF RES.	1/4W 47K J
R155	VE-30012649	SMD RES.	1/16W 150R J
R201	VE-30012674	SMD RES.	1/16W 27K J
R202	VE-30012692	SMD RES.	1/16W 4.7K J
R204	VE-30000459	CF RES.	1/4W 100R J
R206	VE-30000459	CF RES.	1/4W 100R J
R301	VE-30000471	CF RES.	1/4W 10K J
R302	VE-30000471	CF RES.	1/4W 10K J
R303	VE-30012641	SMD RES.	1/16W 10K J
R305	VE-30012641	SMD RES.	1/16W 10K J
R306	VE-30012509	SMD RES.	1/16W 100K J
R417	VE-30012510	SMD RES.	1/16W 100R J
R418	VE-30012510	SMD RES.	1/16W 100R J
R419	VE-30012649	SMD RES.	1/16W 150R J
R420	VE-30000466	CF RES.	1/4W 1K J
R421	VE-30012650	SMD RES.	1/16W 15K J
R422	VE-30012659	SMD RES.	1/16W 2.2K J
R423	VE-30012712	SMD RES.	1/16W 8.2K J
R424	VE-30000712	CF RES.	1/4W 470R J
R425	VE-30000583	CF RES.	1/4W 220R J
R426	VE-30012659	SMD RES.	1/16W 2.2K J
R427	VE-30012674	SMD RES.	1/16W 27K J
R428	VE-30000792	CF RES.	1/4W 75R J
R431	VE-30012674	SMD RES.	1/16W 27K J
R432	VE-30012657	SMD RES.	1/16W 1K J
R433	VE-30012667	SMD RES.	1/16W 220K J
R437	VE-30000466	CF RES.	1/4W 1K J
R438	VE-30000466	CF RES.	1/4W 1K J
R439	VE-30012657	SMD RES.	1/16W 1K J
R440	VE-30012714	SMD RES.	1/16W 820R J
R441	VE-30012656	SMD RES.	1/16W 18K J
R442	VE-30000466	CF RES.	1/4W 1K J
R446	VE-30012714	SMD RES.	1/16W 820R J
R447	VE-30012714	SMD RES.	1/16W 820R J
R448	VE-30012683	SMD RES.	1/16W 330K J
R449	VE-30012662	SMD RES.	1/16W 2.7K J
R450	VE-30000712	CF RES.	1/4W 470R J
R455	VE-30012650	SMD RES.	1/16W 15K J
R458	VE-30012662	SMD RES.	1/16W 2.7K J
R459	VE-30012510	SMD RES.	1/16W 100R J
R460	VE-30012510	SMD RES.	1/16W 100R J
R461	VE-30012510	SMD RES.	1/16W 100R J
R463	VE-30012692	SMD RES.	1/16W 4.7K J
R464	VE-30012650	SMD RES.	1/16W 15K J
R469	VE-30000670	CF RES.	1/4W 330K J
R470	VE-30012683	SMD RES.	1/16W 330K J
R474	VE-30012692	SMD RES.	1/16W 4.7K J
R475	VE-30012510	SMD RES.	1/16W 100R J
R476	VE-30012707	SMD RES.	1/16W 680R J
R477	VE-30014022	SMD RES.	1/16W 47R J
R502	VE-30012695	SMD RES.	1/16W 470R J
R503	VE-30012707	SMD RES.	1/16W 680R J
R504	VE-30012679	SMD RES.	1/16W 3.9K J
R505	VE-30012673	SMD RES.	1/16W 270R J
R506	VE-30012506	SMD RES.	1/16W 1.5K J

△ Symbol No.	Part No.	Part Name	Description
RESISTOR			
R507	VE-30012657	SMD RES.	1/16W 1K J
R508	VE-30000706	CF RES.	1/4W 47R J
R509	VE-30012641	SMD RES.	1/16W 10K J
R510	VE-30000622	CF RES.	1/4W 270R J
R511	VE-30012657	SMD RES.	1/16W 1K J
R512	VE-30012504	SMD RES.	1/16W 1.2K J
R513	VE-30000459	CF RES.	1/4W 100R J
R514	VE-30000459	CF RES.	1/4W 100R J
R515	VE-30012692	SMD RES.	1/16W 4.7K J
R516	VE-30012692	SMD RES.	1/16W 4.7K J
R517	VE-30012692	SMD RES.	1/16W 4.7K J
R518	VE-30000471	CF RES.	1/4W 10K J
R519	VE-30012698	SMD RES.	1/16W 5.6K J
R525	VE-30000583	CF RES.	1/4W 220R J
R526	VE-30012641	SMD RES.	1/16W 10K J
R527	VE-30000718	CF RES.	1/4W 4.7K J
R528	VE-30012698	SMD RES.	1/16W 5.6K J
R530	VE-30012698	SMD RES.	1/16W 5.6K J
R531	VE-30012692	SMD RES.	1/16W 4.7K J
R532	VE-30012659	SMD RES.	1/16W 2.2K J
R533	VE-30012644	SMD RES.	1/16W 12K J
R534	VE-30000526	CF RES.	1/4W 1.5K J
R535	VE-30000718	CF RES.	1/4W 4.7K J
R536	VE-30000471	CF RES.	1/4W 10K J
R537	VE-30012641	SMD RES.	1/16W 10K J
R538	VE-30012698	SMD RES.	1/16W 5.6K J
R539	VE-30012659	SMD RES.	1/16W 2.2K J
R540	VE-30012644	SMD RES.	1/16W 12K J
R545	VE-30012644	SMD RES.	1/16W 12K J
R546	VE-30000560	CF RES.	1/4W 1.8K J
R547	VE-30012659	SMD RES.	1/16W 2.2K J
R548	VE-30012641	SMD RES.	1/16W 10K J
R555	VE-30012659	SMD RES.	1/16W 2.2K J
R556	VE-30012657	SMD RES.	1/16W 1K J
R559	VE-30000470	CF RES.	1/2W 10K J
R560	VE-30012669	SMD RES.	1/16W 22K J
R561	VE-30012692	SMD RES.	1/16W 4.7K J
R562	VE-30000471	CF RES.	1/4W 10K J
R564	VE-30012641	SMD RES.	1/16W 10K J
R601	VE-30000752	CF RES.	1/4W 56K J
R602	VE-30000820	CF RES.	1/4W 82K J
R605	VE-30000477	CF RES.	1/4W 100K J
R612	VE-30012692	SMD RES.	1/16W 4.7K J
R613	VE-30012692	SMD RES.	1/16W 4.7K J
R618	VE-30012508	SMD RES.	1/16W 1.8K J
R619	VE-30012641	SMD RES.	1/16W 10K J
R623	VE-30000607	CF RES.	1/4W 2.2R J
R624	VE-30001120	MO RES.	2W 22R J
R625	VE-30000900	MF RES.	1/4W 1.8K J
R627	VE-30000929	MF RES.	1/2W 2.2R G
R630	VE-30000828	CF RES.	1/4W 8.2M J
R631	VE-30000885	MF RES.	1/4W 1.5K J
R633	VE-30000650	CF RES.	1/4W 33R J
R634	VE-30012641	SMD RES.	1/16W 10K J
R637	VE-30000621	CF RES.	1/2W 270R J
R638	VE-30000612	CF RES.	1/4W 2.4K J
R639	VE-30000718	CF RES.	1/4W 4.7K J
R640	VE-30012662	SMD RES.	1/16W 2.7K J
R641	VE-30012649	SMD RES.	1/16W 150R J
R645	VE-30018904	MO RES.	5W 4.7K J
R646	VE-30014941	CF RES.	1/4W 16K J
R647	VE-30000466	CF RES.	1/4W 1K J
△ R648	VE-30001249	FUSE RES.	1W 4.7R J
R649	VE-30000500	CF RES.	1/4W 12K J
R650	VE-30000744	CF RES.	1/4W 560R J
R654	VE-30000458	CF RES.	1/2W 100R J
R655	VE-30000705	CF RES.	1/2W 47R J
R657	VE-30012656	SMD RES.	1/16W 18K J
R659	VE-30001151	MO RES.	3W 330R J
R660	VE-30012669	SMD RES.	1/16W 22K J
R661	VE-30012674	SMD RES.	1/16W 27K J
R662	VE-30000712	CF RES.	1/4W 470R J
R663	VE-30000459	CF RES.	1/4W 100R J
R664	VE-30007779	MO RES.	5W 47R J (RADIAL)
R665	VE-30012708	SMD RES.	1/16W 68K J
R666	VE-30001099	MO RES.	2W 15R J
R701	VE-30000459	CF RES.	1/4W 100R J
R703	VE-30000459	CF RES.	1/4W 100R J
R705	VE-30000459	CF RES.	1/4W 100R J

[AV-21BF11EES]

△ Symbol No.	Part No.	Part Name	Description
RESISTOR			
R715	VE-30012695	SMD RES.	1/16W 470R J
R717	VE-30012695	SMD RES.	1/16W 470R J
R719	VE-30012657	SMD RES.	1/16W 1K J
R721	VE-30000459	CF RES.	1/4W 100R J
R722	VE-30000459	CF RES.	1/4W 100R J
R723	VE-30012510	SMD RES.	1/16W 100R J
R724	VE-30012510	SMD RES.	1/16W 100R J
R725	VE-30012657	SMD RES.	1/16W 1K J
R726	VE-30012657	SMD RES.	1/16W 1K J
R727	VE-30012657	SMD RES.	1/16W 1K J
R728	VE-30012657	SMD RES.	1/16W 1K J
R729	VE-30012657	SMD RES.	1/16W 1K J
R730	VE-30012657	SMD RES.	1/16W 1K J
R731	VE-30012657	SMD RES.	1/16W 1K J
R801	VE-30000466	CF RES.	1/4W 1K J
R803	VE-30012659	SMD RES.	1/16W 2.2K J
R804	VE-30000477	CF RES.	1/4W 100K J
R805	VE-30000452	CF RES.	1/4W 10R J
R806	VE-30007199	MF RES.	1/4W 4.3K F
R807	VE-30001130	MO RES.	1/2W 0.22R J
R809	VE-30007784	MO RES.	5W 33K J (RADIAL)
△ R810	VE-30001257	MG RES.	1/2W 4.7M J
R811	VE-30000594	CF RES.	1/4W 22K J
R813	VE-30000718	CF RES.	1/4W 4.7K J
R814	VE-30012662	SMD RES.	1/16W 2.7K J
R815	VE-30000452	CF RES.	1/4W 10R J
R817	VE-30001037	MF RES.	1/4W 99K F
R818	VE-30006463	MF RES.	1/4W 2K F
R819	VE-30000810	CF RES.	1/4W 820R J
R821	VE-30000470	CF RES.	1/2W 10K J
R828	VE-30001260	WW RES.	5W 2.2R J
R829	VE-30000718	CF RES.	1/4W 4.7K J
R830	VE-30012657	SMD RES.	1/16W 1K J
R831	VE-30012669	SMD RES.	1/16W 22K J
R834	VE-30012641	SMD RES.	1/16W 10K J
R835	VE-30016802	WW RES.	5W 5.6R J RAD.
R900	VE-30006712	FERRITE BEAD	3.5X4.7X0.8
R901	VE-30006712	FERRITE BEAD	3.5X4.7X0.8
R902	VE-30006712	FERRITE BEAD	3.5X4.7X0.8
R903	VE-30000525	CF RES.	1/2W 1.5K J
R904	VE-30000525	CF RES.	1/2W 1.5K J
R905	VE-30000525	CF RES.	1/2W 1.5K J
△ R906	VE-30000525	CF RES.	1/2W 1.5K J
△ R919	VE-30001230	FUSE RES.	1/2W 27R J

CAPACITOR

C141	VE-30000384	EL CAP.	2.2UF 50V M
C142	VE-30000384	EL CAP.	2.2UF 50V M
C143	VE-30012589	SMD CAP.	4.7NF 50V K
C144	VE-30012589	SMD CAP.	4.7NF 50V K
C145	VE-30012589	SMD CAP.	4.7NF 50V K
C146	VE-30012589	SMD CAP.	4.7NF 50V K
C147	VE-30012589	SMD CAP.	4.7NF 50V K
C148	VE-30012589	SMD CAP.	4.7NF 50V K
C149	VE-30012589	SMD CAP.	4.7NF 50V K
C150	VE-30012589	SMD CAP.	4.7NF 50V K
C155	VE-30012560	SMD CAP.	100PF 50V J
C157	VE-30012560	SMD CAP.	100PF 50V J
C159	VE-30012560	SMD CAP.	100PF 50V J
C160	VE-30000387	EL CAP.	33UF 50V M
C161	VE-30000362	EL CAP.	1UF 50V M
C162	VE-30000362	EL CAP.	1UF 50V M
C201	VE-30000400	EL CAP.	47UF 50V M
C205	VE-30000371	EL CAP.	22UF 50V M
C206	VE-30012610	SMD CAP.	10NF 50V J
C207	VE-30012610	SMD CAP.	10NF 50V J
C300	VE-30000400	EL CAP.	47UF 50V M
C302	VE-30000092	MKT CAP.	220NF 63V J
C305	VE-30000092	MKT CAP.	220NF 63V J
C404	VE-30000225	CER CAP.	220PF 50V J SL
C408	VE-30012586	SMD CAP.	22NF 50V K
C409	VE-30000345	EL CAP.	10UF 50V M
C410	VE-30000384	EL CAP.	2.2UF 50V M
C411	VE-30000345	EL CAP.	10UF 50V M
C412	VE-30012586	SMD CAP.	22NF 50V K
C413	VE-30000362	EL CAP.	1UF 50V M
C414	VE-30012585	SMD CAP.	2.2NF 50V K R
C415	VE-30012581	SMD CAP.	1NF 50V K R
C416	VE-30000362	EL CAP.	1UF 50V M
C417	VE-30000362	EL CAP.	1UF 50V M

△ Symbol No.	Part No.	Part Name	Description
CAPACITOR			
C418	VE-30012586	SMD CAP.	22NF 50V K
C419	VE-30000413	EL CAP.	4.7UF 50V M
C420	VE-30000100	MKT CAP.	330NF 63V J
C422	VE-30000400	EL CAP.	47UF 50V M
C423	VE-30000400	EL CAP.	47UF 50V M
C424	VE-30000345	EL CAP.	10UF 50V M
C425	VE-30012586	SMD CAP.	22NF 50V K
C426	VE-30016654	SMD CAP.	100NF 16V K R
C427	VE-30016654	SMD CAP.	100NF 16V K R
C429	VE-30012589	SMD CAP.	4.7NF 50V K
C431	VE-30000362	EL CAP.	1UF 50V M
C432	VE-30012586	SMD CAP.	22NF 50V K
C433	VE-30000345	EL CAP.	10UF 50V M
C434	VE-30016654	SMD CAP.	100NF 16V K R
C435	VE-30016654	SMD CAP.	100NF 16V K R
C436	VE-30000384	EL CAP.	2.2UF 50V M
C437	VE-30016654	SMD CAP.	100NF 16V K R
C438	VE-30016654	SMD CAP.	100NF 16V K R
C439	VE-30016654	SMD CAP.	100NF 16V K R
C440	VE-30000074	MKT CAP.	100NF 63V J
C441	VE-30012582	SMD CAP.	10NF 50V K R
C442	VE-30000384	EL CAP.	2.2UF 50V M
C443	VE-30000362	EL CAP.	1UF 50V M
C444	VE-30000384	EL CAP.	2.2UF 50V M
C448	VE-30012586	SMD CAP.	22NF 50V K
C449	VE-30012567	SMD CAP.	220PF 50V J
C451	VE-30012581	SMD CAP.	1NF 50V K R
C452	VE-30012581	SMD CAP.	1NF 50V K R
C454	VE-30012573	SMD CAP.	47PF 50V J
C455	VE-30012573	SMD CAP.	47PF 50V J
C456	VE-30012573	SMD CAP.	47PF 50V J
C459	VE-30012575	SMD CAP.	4.7PF 50V C GH
C460	VE-30000345	EL CAP.	10UF 50V M
C502	VE-30000396	EL CAP.	47UF 16V M
C504	VE-30012586	SMD CAP.	22NF 50V K
C505	VE-30012589	SMD CAP.	4.7NF 50V K
C510	VE-30012586	SMD CAP.	22NF 50V K
C511	VE-30012566	SMD CAP.	22PF 50V J
C513	VE-30000371	EL CAP.	22UF 50V M
C514	VE-30012586	SMD CAP.	22NF 50V K
C515	VE-30012579	SMD CAP.	82PF 50V J
C517	VE-30012586	SMD CAP.	22NF 50V K
C518	VE-30012586	SMD CAP.	22NF 50V K
C519	VE-30000352	EL CAP.	100UF 16V M
C520	VE-30012560	SMD CAP.	100PF 50V J
C521	VE-30012562	SMD CAP.	15PF 50V J
C522	VE-30012562	SMD CAP.	15PF 50V J
C523	VE-30012585	SMD CAP.	2.2NF 50V K R
C525	VE-30012566	SMD CAP.	22PF 50V J
C526	VE-30012586	SMD CAP.	22NF 50V K
C530	VE-30012589	SMD CAP.	4.7NF 50V K
C531	VE-30000384	EL CAP.	2.2UF 50V M
C532	VE-30012586	SMD CAP.	22NF 50V K
C536	VE-30000074	MKT CAP.	100NF 63V J
C541	VE-30000109	MKT CAP.	470NF 63V J
C542	VE-30000205	CER CAP.	150PF 50V J SL
C543	VE-30000205	CER CAP.	150PF 50V J SL
C545	VE-30012607	SMD CAP.	150PF 50V J
C603	VE-30000384	EL CAP.	2.2UF 50V M
C604	VE-30000400	EL CAP.	47UF 50V M
C608	VE-30000107	MKT CAP.	47NF 250V J
C610	VE-30018901	EL CAP.	100UF 50V M 105°
C611	VE-30000092	MKT CAP.	220NF 63V J
C613	VE-30016085	EL CAP.	10UF 63V 105°
C615	VE-30000359	EL CAP.	100UF 16V M
C616	VE-30000400	EL CAP.	47UF 50V M
△ C618	VE-30000134	MKP CAP.	11NF 2000V 3.5
C619	VE-30000131	MKP CAP.	100NF 250V J
C623	VE-30000404	EL CAP.	47UF 160V M (HR)
C624	VE-30000350	EL CAP.	10UF 250V M
C627	VE-30000150	MKP CAP.	270NF 250V J 15/22.5MM
C628	VE-30018380	EL CAP.	3.3UF 160V M (105°)
C631	VE-30000410	EL CAP.	470UF 50V M
C632	VE-30000100	MKT CAP.	330NF 63V J
C634	VE-30000409	EL CAP.	470UF 25V M
C635	VE-30000100	MKT CAP.	330NF 63V J
C636	VE-30000400	EL CAP.	47UF 50V M
C638	VE-30012581	SMD CAP.	1NF 50V K R
C639	VE-30000433	CER CAP.	1NF 1KV M B
C641	VE-30000345	EL CAP.	10UF 50V M
C642	VE-30012609	SMD CAP.	68NF 50V K
C643	VE-30000116	MKT CAP.	68NF 63V J

[AV-21BF11EES]

Symbol No.	Part No.	Part Name	Description
------------	----------	-----------	-------------

CAPACITOR

C644	VE-30000362	EL CAP.	1UF 50V M
C700	VE-30012565	SMD CAP.	1.8PF 50V J CH
C701	VE-30012565	SMD CAP.	1.8PF 50V J CH
C702	VE-30012573	SMD CAP.	47PF 50V J
C703	VE-30012573	SMD CAP.	47PF 50V J
C704	VE-30012576	SMD CAP.	56PF 50V J CH
C705	VE-30000345	EL CAP.	10UF 50V M
C706	VE-30000345	EL CAP.	10UF 50V M
C707	VE-30012573	SMD CAP.	47PF 50V J
C708	VE-30012586	SMD CAP.	22NF 50V K
C710	VE-30012573	SMD CAP.	47PF 50V J
C712	VE-30000345	EL CAP.	10UF 50V M
C713	VE-30016654	SMD CAP.	100NF 16V K R
C714	VE-30016654	SMD CAP.	100NF 16V K R
C716	VE-30016654	SMD CAP.	100NF 16V K R
C717	VE-30016654	SMD CAP.	100NF 16V K R
C718	VE-30016654	SMD CAP.	100NF 16V K R
C719	VE-30012586	SMD CAP.	22NF 50V K
C720	VE-30000345	EL CAP.	10UF 50V M
C721	VE-30016654	SMD CAP.	100NF 16V K R
C723	VE-30016654	SMD CAP.	100NF 16V K R
C724	VE-30000345	EL CAP.	10UF 50V M
C729	VE-30016654	SMD CAP.	100NF 16V K R
C730	VE-30000393	EL CAP.	3.3UF 50V M
C733	VE-30000345	EL CAP.	10UF 50V M
C734	VE-30000345	EL CAP.	10UF 50V M
C735	VE-30012586	SMD CAP.	22NF 50V K
C736	VE-30000345	EL CAP.	10UF 50V M
C737	VE-30000109	MKT CAP.	470NF 63V J
C738	VE-30000109	MKT CAP.	470NF 63V J
C739	VE-30000109	MKT CAP.	470NF 63V J
C740	VE-30000109	MKT CAP.	470NF 63V J
C741	VE-30012585	SMD CAP.	2.2NF 50V K R
C742	VE-30012585	SMD CAP.	2.2NF 50V K R
C748	VE-30012560	SMD CAP.	100PF 50V J
△ C801	VE-30000094	MKT CAP.	220NF 275V M AC
△ C802	VE-30000094	MKT CAP.	220NF 275V M AC
△ C803	VE-30000433	CER CAP.	1NF 1KV M B
△ C804	VE-30000433	CER CAP.	1NF 1KV M B
C808	VE-30000295	CER CAP.	100NF 50V Z F
C809	VE-30000418	EL CAP.	100UF 400V M
C810	VE-30000400	EL CAP.	47UF 50V M
C811	VE-30000161	MKT CAP.	47NF 630V J
C812	VE-30007308	CER CAP.	220PF 1KV K (PULSE)
C813	VE-30000295	CER CAP.	100NF 50V Z F
△ C816	VE-30000447	CER CAP.	4.7NF 4KV M E
C817	VE-30000198	CER CAP.	120PF 500V J SL
C818	VE-30016654	SMD CAP.	100NF 16V K R
C819	VE-30012609	SMD CAP.	68NF 50V K
C822	VE-30009208	CER CAP.	470PF 1KV K (PULSE)
C824	VE-30000433	CER CAP.	1NF 1KV M B
C826	VE-30000404	EL CAP.	47UF 160V M (HR)
C827	VE-30000411	EL CAP.	470UF 16V M
C828	VE-30000295	CER CAP.	100NF 50V Z F
C829	VE-30000407	EL CAP.	470UF 16V M
C830	VE-30000382	EL CAP.	2200UF 16V M
C831	VE-30000431	CER CAP.	100PF 1KV M
C832	VE-30000295	CER CAP.	100NF 50V Z F
C833	VE-30000407	EL CAP.	470UF 16V M
C834	VE-30000295	CER CAP.	100NF 50V Z F
C836	VE-30000431	CER CAP.	100PF 1KV M
C838	VE-30000352	EL CAP.	100UF 16V M
C839	VE-30000352	EL CAP.	100UF 16V M
C840	VE-30000352	EL CAP.	100UF 16V M
C843	VE-30000431	CER CAP.	100PF 1KV M
C848	VE-30000352	EL CAP.	100UF 16V M
C849	VE-30000352	EL CAP.	100UF 16V M
C850	VE-30000352	EL CAP.	100UF 16V M
C855	VE-30000407	EL CAP.	470UF 16V M
C856	VE-30000433	CER CAP.	1NF 1KV M B
C858	VE-30007308	CER CAP.	220PF 1KV K (PULSE)
C859	VE-30013533	CER CAP.	100PF 1KV K (PULSE)
C907	VE-30000434	CER CAP.	1NF 2KV K B
C908	VE-30000415	EL CAP.	4.7UF 250V M
C912	VE-30000075	MKT CAP.	100NF 250V K (DC)

TRANSF

△ TR601	VE-30017788	FBT TRF
△ TR802	VE-30018592	SMPS TRF

Symbol No.	Part No.	Part Name	Description
------------	----------	-----------	-------------

COIL

L101	VE-30001971	FERRITE BEAT	
L102	VE-30001971	FERRITE BEAT	
L103	VE-30001971	FERRITE BEAT	
L106	VE-30001971	FERRITE BEAT	
L107	VE-30001971	FERRITE BEAT	
L108	VE-30001971	FERRITE BEAT	
L109	VE-30001971	FERRITE BEAT	
L110	VE-30001971	FERRITE BEAT	
L111	VE-30001971	FERRITE BEAT	
L112	VE-30001971	FERRITE BEAT	
L113	VE-30001971	FERRITE BEAT	
L114	VE-30001971	FERRITE BEAT	
L115	VE-30001971	FERRITE BEAT	
L201	VE-30001979	FIXD COIL	1UH
L210	VE-30001971	FERRITE BEAT	
L211	VE-30001971	FERRITE BEAT	
L401	VE-30001971	FERRITE BEAT	
L402	VE-30001992	FIXD COIL	10UH
L403	VE-30001971	FERRITE BEAT	
L404	VE-30001990	FIXD COIL	6.8UH
L405	VE-30014048	ADJ. COIL	44MHZ
L406	VE-30001971	FERRITE BEAT	
L603	VE-30018501	LINEARITY COIL	100UH
L604	VE-30001971	FERRITE BEAT	
L700	VE-30001971	FERRITE BEAT	
L701	VE-30001971	FERRITE BEAT	
L702	VE-30001996	FIXD COIL	22UH
L703	VE-30001979	FIXD COIL	1UH
L704	VE-30001979	FIXD COIL	1UH
L802	VE-30001971	FERRITE BEAT	
L803	VE-30000580	CF RES.	1/4W 22R J
L805	VE-30001971	FERRITE BEAT	
L806	VE-30001971	FERRITE BEAT	
L807	VE-30001992	FIXD COIL	10UH
L809	VE-30001971	FERRITE BEAT	
L810	VE-30001992	FIXD COIL	10UH
L900	VE-30002171	PEAKING COIL	22UH K

DIODE

D101	VE-30007760	ZENER DIODE	
D102	VE-30007760	ZENER DIODE	
D103	VE-30007760	ZENER DIODE	
D104	VE-30007762	ZENER DIODE	
D106	VE-30001377	ZENER DIODE	
D118	VE-30009366	DIODE	
D300	VE-30001285	DIODE	
D301	VE-30001285	DIODE	
D405	VE-30007763	ZENER DIODE	
D407	VE-30001284	DIODE	
D408	VE-30001285	DIODE	
D409	VE-30007760	ZENER DIODE	
D410	VE-30007760	ZENER DIODE	
D411	VE-30007760	ZENER DIODE	
D501	VE-30001285	DIODE	
D505	VE-30001285	DIODE	
D506	VE-30001284	DIODE	
D509	VE-30001279	LED RED/GREEN	
D512	VE-30001285	DIODE	
D513	VE-30001339	ZENER DIODE	
D602	VE-30001329	DIODE	
D603	VE-30001285	DIODE	
D608	VE-30001318	DIODE	
D609	VE-30001318	DIODE	
D610	VE-30001318	DIODE	
D611	VE-30001285	DIODE	
D614	VE-30001318	DIODE	
D615	VE-30001285	DIODE	
D616	VE-30009699	ZENER DIODE	
D617	VE-30001285	DIODE	
D618	VE-30001285	DIODE	
D619	VE-30009699	ZENER DIODE	
D700	VE-30001285	DIODE	
D701	VE-30001369	ZENER DIODE	
D800	VE-30001318	DIODE	
D801	VE-30001347	ZENER DIODE	
D802	VE-30001318	DIODE	
D803	VE-30001315	DIODE	
D804	VE-30001285	DIODE	
D805	VE-30009366	DIODE	
D806	VE-30001315	DIODE	
D808	VE-30007681	DIODE	
D809	VE-30001329	DIODE	

[AV-21BF11EES]

Symbol No.	Part No.	Part Name	Description
------------	----------	-----------	-------------

DIODE

D810	VE-20068028	HE. ASY.	
Δ D811	VE-30001329	DIODE	
Δ D812	VE-30001285	DIODE	
Δ D813	VE-30001329	DIODE	
Δ D837	VE-30001329	DIODE	
Δ D838	VE-30001329	DIODE	
D889	VE-30001384	TR	
D890	VE-30001329	DIODE	
D900	VE-30001318	DIODE	
D901	VE-30001318	DIODE	
D902	VE-30001318	DIODE	
D903	VE-30001344	ZENER DIODE	
D904	VE-30007760	ZENER DIODE	
D905	VE-30007760	ZENER DIODE	
D906	VE-30007760	ZENER DIODE	

TRANSISTOR

Q104	VE-30001457	TR	
Q106	VE-30001457	TR	
Q141	VE-30001457	TR	
Q142	VE-30001457	TR	
Q301	VE-30001458	TR	
Q302	VE-30001457	TR	
Q406	VE-30001457	TR	
Q503	VE-30001457	TR	
Q504	VE-30001458	TR	
Q601	VE-30013656	POWER TR	
Δ Q603	VE-30001448	TR	H. OUT
Q604	VE-30001457	TR	
Q606	VE-30001457	TR	
Q700	VE-30001458	TR	
Q801	VE-30001386	TR	
Q802	VE-30001457	TR	
Q804	VE-30001454	TR	

IC

IC118	VE-30001506	IC	
IC301	VE-30011824	IC	
IC403	VE-30014510	IC	
IC500	VE-20103787	IC	(MEMORY)
IC501	VE-20104642	IC	(MICOM)
IC502	VE-30001670	PREAMPLIFIER	
Δ IC600	VE-30015306	IC	
IC700	VE-30013658	IC	
IC800	VE-30011968	IC	
Δ IC801	VE-30015087	IC	
IC803	VE-30001500	IC	
IC804	VE-30001622	IC	
IC806	VE-30014346	IC	
IC900	VE-30015857	IC	

OTHER

Δ F801	VE-30001731	FUSE	2.5A
Δ PL903	VE-30001855	CRT SOCKET	
SG900	VE-30000428	SPARK GAP	300V
SG901	VE-30000428	SPARK GAP	300V
SG902	VE-30000428	SPARK GAP	300V
SW501	VE-30002178	TACK SWITCH	
SW502	VE-30002178	TACK SWITCH	
SW503	VE-30002178	TACK SWITCH	
SW504	VE-30002178	TACK SWITCH	
SW505	VE-30002178	TACK SWITCH	
Δ SW801	VE-30017848	SWITCH ON/OFF	2.5A/100A
Δ TH800	VE-30001270	PTC	9 OHM
Δ TR801	VE-30002100	LINE FILTER	
TU201	VE-30009637	TUNER	
X401	VE-30001749	XTAL	
X402	VE-30015592	XTAL	
X403	VE-30000074	MKT CAP.	100NF 63V J
X501	VE-30002851	XTAL	
X700	VE-30001756	XTAL	
Z401	VE-30013163	SAW FILTER	
Z402	VE-30014261	SAW FILTER	
Z404	VE-30001724	SAW FILTER	

**FRONT AV & HEADPHONE P.W. BOARD ASS'Y
(VE-20101564)**

Symbol No.	Part No.	Part Name	Description
------------	----------	-----------	-------------

RESISTOR

R108	VE-30000712	CF RES.	1/4W 470R J
R110	VE-30000712	CF RES.	1/4W 470R J
R113	VE-30000744	CF RES.	1/4W 560R J
R114	VE-30000744	CF RES.	1/4W 560R J
R115	VE-30000712	CF RES.	1/4W 470R J
R116	VE-30000712	CF RES.	1/4W 470R J

CAPACITOR

C103	VE-30000213	CER CAP.	180PF 50V J
C104	VE-30000213	CER CAP.	180PF 50V J
C106	VE-30000190	CER CAP.	100PF 50V J

COIL

L103	VE-30001996	FIXED COIL	22UH Q40 K
L104	VE-30001996	FIXED COIL	22UH Q40 K

OTHERS

CON102	VE-30001893	RCA JACK	
CON103	VE-30001891	RCA JACK	
CON104	VE-30001892	RCA JACK	
CON106	VE-30001900	HEADPHONE JACK	HP01/2/3/4/5/6

PRINTED WIRING BOARD PARTS LIST

[AV-21BF11EPS]

MAIN P.W. BOARD ASS'Y (VE-20101120)

△ Symbol No.	Part No.	Part Name	Description
RESISTOR			
R105	VE-30000792	CF RES.	1/4W 75R J
R109	VE-30012713	SMD RES.	1/16W 75R J
R110	VE-30012713	SMD RES.	1/16W 75R J
R113	VE-30012713	SMD RES.	1/16W 75R J
R114	VE-30012713	SMD RES.	1/16W 75R J
R115	VE-30012713	SMD RES.	1/16W 75R J
R116	VE-30012987	SMD RES.	1/16W 56R J
R117	VE-30012713	SMD RES.	1/16W 75R J
R118	VE-30000792	CF RES.	1/4W 75R J
R122	VE-30000792	CF RES.	1/4W 75R J
R123	VE-30000792	CF RES.	1/4W 75R J
R126	VE-30012695	SMD RES.	1/16W 470R J
R127	VE-30000459	CF RES.	1/4W 100R J
R129	VE-30012713	SMD RES.	1/16W 75R J
R135	VE-30012657	SMD RES.	1/16W 1K J
R139	VE-30012713	SMD RES.	1/16W 75R J
R140	VE-30012987	SMD RES.	1/16W 56R J
R141	VE-30012695	SMD RES.	1/16W 470R J
R142	VE-30000459	CF RES.	1/4W 100R J
R145	VE-30012713	SMD RES.	1/16W 75R J
R149	VE-30000752	CF RES.	1/4W 56K J
R151	VE-30012696	SMD RES.	1/16W 47K J
R152	VE-30000752	CF RES.	1/4W 56K J
R153	VE-30012657	SMD RES.	1/16W 1K J
R154	VE-30000723	CF RES.	1/4W 47K J
R155	VE-30012649	SMD RES.	1/16W 150R J
R201	VE-30012674	SMD RES.	1/16W 27K J
R202	VE-30012692	SMD RES.	1/16W 4.7K J
R204	VE-30000459	CF RES.	1/4W 100R J
R206	VE-30000459	CF RES.	1/4W 100R J
R301	VE-30000471	CF RES.	1/4W 10K J
R302	VE-30000471	CF RES.	1/4W 10K J
R303	VE-30012641	SMD RES.	1/16W 10K J
R305	VE-30012641	SMD RES.	1/16W 10K J
R306	VE-30012509	SMD RES.	1/16W 100K J
R407	VE-30000590	CF RES.	1/4W 2.2K J
R410	VE-30000471	CF RES.	1/4W 10K J
R412	VE-30012696	SMD RES.	1/16W 47K J
R417	VE-30012510	SMD RES.	1/16W 100R J
R418	VE-30012510	SMD RES.	1/16W 100R J
R419	VE-30012649	SMD RES.	1/16W 150R J
R420	VE-30000466	CF RES.	1/4W 1K J
R421	VE-30012650	SMD RES.	1/16W 15K J
R422	VE-30012659	SMD RES.	1/16W 2.2K J
R423	VE-30012712	SMD RES.	1/16W 8.2K J
R424	VE-30000712	CF RES.	1/4W 470R J
R425	VE-30000583	CF RES.	1/4W 220R J
R426	VE-30012659	SMD RES.	1/16W 2.2K J
R427	VE-30012674	SMD RES.	1/16W 27K J
R428	VE-30000792	CF RES.	1/4W 75R J
R431	VE-30012674	SMD RES.	1/16W 27K J
R432	VE-30012657	SMD RES.	1/16W 1K J
R433	VE-30012667	SMD RES.	1/16W 220K J
R437	VE-30000466	CF RES.	1/4W 1K J
R438	VE-30000466	CF RES.	1/4W 1K J
R439	VE-30012657	SMD RES.	1/16W 1K J
R440	VE-30012714	SMD RES.	1/16W 820R J
R441	VE-30012656	SMD RES.	1/16W 18K J
R442	VE-30000466	CF RES.	1/4W 1K J
R446	VE-30012714	SMD RES.	1/16W 820R J
R447	VE-30012714	SMD RES.	1/16W 820R J
R448	VE-30012683	SMD RES.	1/16W 330K J
R449	VE-30012662	SMD RES.	1/16W 2.7K J
R450	VE-30000712	CF RES.	1/4W 470R J
R455	VE-30012650	SMD RES.	1/16W 15K J
R458	VE-30012662	SMD RES.	1/16W 2.7K J
R459	VE-30012510	SMD RES.	1/16W 100R J
R460	VE-30012510	SMD RES.	1/16W 100R J
R461	VE-30012510	SMD RES.	1/16W 100R J
R463	VE-30012692	SMD RES.	1/16W 4.7K J
R464	VE-30012650	SMD RES.	1/16W 15K J
R465	VE-30012692	SMD RES.	1/16W 4.7K J
R467	VE-30012641	SMD RES.	1/16W 10K J
R468	VE-30012641	SMD RES.	1/16W 10K J
R469	VE-30000670	CF RES.	1/4W 330K J
R470	VE-30012683	SMD RES.	1/16W 330K J
R474	VE-30012692	SMD RES.	1/16W 4.7K J
R475	VE-30012510	SMD RES.	1/16W 100R J
R476	VE-30012707	SMD RES.	1/16W 680R J

△ Symbol No.	Part No.	Part Name	Description
RESISTOR			
R477	VE-30014022	SMD RES.	1/16W 47R J
R502	VE-30012695	SMD RES.	1/16W 470R J
R503	VE-30012707	SMD RES.	1/16W 680R J
R504	VE-30012679	SMD RES.	1/16W 3.9K J
R505	VE-30012673	SMD RES.	1/16W 270R J
R506	VE-30012506	SMD RES.	1/16W 1.5K J
R507	VE-30012657	SMD RES.	1/16W 1K J
R508	VE-30000706	CF RES.	1/4W 47R J
R509	VE-30012641	SMD RES.	1/16W 10K J
R510	VE-30000622	CF RES.	1/4W 270R J
R511	VE-30012657	SMD RES.	1/16W 1K J
R512	VE-30012504	SMD RES.	1/16W 1.2K J
R513	VE-30000459	CF RES.	1/4W 100R J
R514	VE-30000459	CF RES.	1/4W 100R J
R515	VE-30012692	SMD RES.	1/16W 4.7K J
R516	VE-30012692	SMD RES.	1/16W 4.7K J
R517	VE-30012692	SMD RES.	1/16W 4.7K J
R518	VE-30000471	CF RES.	1/4W 10K J
R519	VE-30012698	SMD RES.	1/16W 5.6K J
R525	VE-30000583	CF RES.	1/4W 220R J
R526	VE-30012641	SMD RES.	1/16W 10K J
R527	VE-30000718	CF RES.	1/4W 4.7K J
R528	VE-30012698	SMD RES.	1/16W 5.6K J
R530	VE-30012698	SMD RES.	1/16W 5.6K J
R531	VE-30012692	SMD RES.	1/16W 4.7K J
R532	VE-30012659	SMD RES.	1/16W 2.2K J
R533	VE-30012644	SMD RES.	1/16W 12K J
R534	VE-30000526	CF RES.	1/4W 1.5K J
R535	VE-30000718	CF RES.	1/4W 4.7K J
R536	VE-30000471	CF RES.	1/4W 10K J
R537	VE-30012641	SMD RES.	1/16W 10K J
R538	VE-30012698	SMD RES.	1/16W 5.6K J
R539	VE-30012659	SMD RES.	1/16W 2.2K J
R540	VE-30012644	SMD RES.	1/16W 12K J
R545	VE-30012644	SMD RES.	1/16W 12K J
R546	VE-30000560	CF RES.	1/4W 1.8K J
R547	VE-30012659	SMD RES.	1/16W 2.2K J
R548	VE-30012641	SMD RES.	1/16W 10K J
R552	VE-30012692	SMD RES.	1/16W 4.7K J
R555	VE-30012659	SMD RES.	1/16W 2.2K J
R556	VE-30012657	SMD RES.	1/16W 1K J
R559	VE-30000470	CF RES.	1/2W 10K J
R560	VE-30012669	SMD RES.	1/16W 22K J
R561	VE-30012692	SMD RES.	1/16W 4.7K J
R562	VE-30000471	CF RES.	1/4W 10K J
R564	VE-30012641	SMD RES.	1/16W 10K J
R601	VE-30000752	CF RES.	1/4W 56K J
R602	VE-30000820	CF RES.	1/4W 82K J
R605	VE-30000477	CF RES.	1/4W 100K J
R612	VE-30012692	SMD RES.	1/16W 4.7K J
R613	VE-30012692	SMD RES.	1/16W 4.7K J
R618	VE-30012508	SMD RES.	1/16W 1.8K J
R619	VE-30012641	SMD RES.	1/16W 10K J
R623	VE-30000607	CF RES.	1/4W 2.2R J
R624	VE-30001120	MO RES.	2W 22R J
R625	VE-30000900	MF RES.	1/4W 1.8K J
R627	VE-30000929	MF RES.	1/2W 2.2R G
R630	VE-30000828	CF RES.	1/4W 8.2K J
R631	VE-30000885	MF RES.	1/4W 1.5K J
R633	VE-30000650	CF RES.	1/4W 33R J
R634	VE-30012641	SMD RES.	1/16W 10K J
R637	VE-30000621	CF RES.	1/2W 270R J
R638	VE-30000612	CF RES.	1/4W 2.4K J
R639	VE-30000718	CF RES.	1/4W 4.7K J
R640	VE-30012662	SMD RES.	1/16W 2.7K J
R641	VE-30012649	SMD RES.	1/16W 150R J
R645	VE-30018904	MO RES.	5W 4.7K J
R646	VE-30014941	CF RES.	1/4W 16K J
R647	VE-30000466	CF RES.	1/4W 1K J
R648	VE-30001249	FUSE RES.	1W 4.7R J
R649	VE-30000500	CF RES.	1/4W 12K J
R650	VE-30000744	CF RES.	1/4W 560R J
R654	VE-30000458	CF RES.	1/2W 100R J
R655	VE-30000705	CF RES.	1/2W 47R J
R657	VE-30012656	SMD RES.	1/16W 18K J
R659	VE-30001151	MO RES.	3W 330R J
R660	VE-30012669	SMD RES.	1/16W 22K J
R661	VE-30012674	SMD RES.	1/16W 27K J
R662	VE-30000712	CF RES.	1/4W 470R J

[AV-21BF11EPS]

△ Symbol No.	Part No.	Part Name	Description
RESISTOR			
R663	VE-30000459	CF RES.	1/4W 100R J
R664	VE-30007779	MO RES.	5W 47R J(RADIAL)
R665	VE-30012708	SMD RES.	1/16W 68K J
R666	VE-30001099	MO RES.	2W 15R J
R701	VE-30000459	CF RES.	1/4W 100R J
R703	VE-30000459	CF RES.	1/4W 100R J
R705	VE-30000459	CF RES.	1/4W 100R J
R715	VE-30012695	SMD RES.	1/16W 470R J
R717	VE-30012695	SMD RES.	1/16W 470R J
R719	VE-30012657	SMD RES.	1/16W 1K J
R721	VE-30000459	CF RES.	1/4W 100R J
R722	VE-30000459	CF RES.	1/4W 100R J
R723	VE-30012510	SMD RES.	1/16W 100R J
R724	VE-30012510	SMD RES.	1/16W 100R J
R725	VE-30012657	SMD RES.	1/16W 1K J
R726	VE-30012657	SMD RES.	1/16W 1K J
R727	VE-30012657	SMD RES.	1/16W 1K J
R728	VE-30012657	SMD RES.	1/16W 1K J
R729	VE-30012657	SMD RES.	1/16W 1K J
R730	VE-30012657	SMD RES.	1/16W 1K J
R731	VE-30012657	SMD RES.	1/16W 1K J
R801	VE-30000466	CF RES.	1/4W 1K J
R803	VE-30012659	SMD RES.	1/16W 2.2K J
R804	VE-30000477	CF RES.	1/4W 100K J
R805	VE-30000452	CF RES.	1/4W 10R J
R806	VE-30007199	MF RES.	1/4W 4.3K F
R807	VE-30001130	MO RES.	1/2W 0.22R J
R809	VE-30007784	MO RES.	5W 33K J(RADIAL)
R810	VE-30001257	MG RES.	1/2W 4.7M J
R811	VE-30000594	CF RES.	1/4W 22K J
R813	VE-30000718	CF RES.	1/4W 4.7K J
R814	VE-30012662	SMD RES.	1/16W 2.7K J
R815	VE-30000452	CF RES.	1/4W 10R J
R817	VE-30001037	MF RES.	1/4W 99K F
R818	VE-30006463	MF RES.	1/4W 2K F
R819	VE-30000810	CF RES.	1/4W 820R J
R821	VE-30000470	CF RES.	1/2W 10K J
R828	VE-30001260	WW RES.	5W 2.2R J
R829	VE-30000718	CF RES.	1/4W 4.7K J
R830	VE-30012657	SMD RES.	1/16W 1K J
R831	VE-30012669	SMD RES.	1/16W 22K J
R834	VE-30012641	SMD RES.	1/16W 10K J
R835	VE-30016802	WW RES.	5W 5.6R J RAD.
R900	VE-30006712	FERRITE BEAD	3.5X4.7X0.8
R901	VE-30006712	FERRITE BEAD	3.5X4.7X0.8
R902	VE-30006712	FERRITE BEAD	3.5X4.7X0.8
R903	VE-30000525	CF RES.	1/2W 1.5K J
R904	VE-30000525	CF RES.	1/2W 1.5K J
R905	VE-30000525	CF RES.	1/2W 1.5K J
R906	VE-30000525	CF RES.	1/2W 1.5K J
△ R919	VE-30001230	FUSE RES.	1/2W 27R J

CAPACITOR

C141	VE-30000384	EL CAP.	2.2UF 50V M
C142	VE-30000384	EL CAP.	2.2UF 50V M
C143	VE-30012589	SMD CAP.	4.7NF 50V K
C144	VE-30012589	SMD CAP.	4.7NF 50V K
C145	VE-30012589	SMD CAP.	4.7NF 50V K
C146	VE-30012589	SMD CAP.	4.7NF 50V K
C147	VE-30012589	SMD CAP.	4.7NF 50V K
C148	VE-30012589	SMD CAP.	4.7NF 50V K
C149	VE-30012589	SMD CAP.	4.7NF 50V K
C150	VE-30012589	SMD CAP.	4.7NF 50V K
C155	VE-30012560	SMD CAP.	100PF 50V J
C157	VE-30012560	SMD CAP.	100PF 50V J
C159	VE-30012560	SMD CAP.	100PF 50V J
C160	VE-30000387	EL CAP.	33UF 50V M
C161	VE-30000362	EL CAP.	1UF 50V M
C162	VE-30000362	EL CAP.	1UF 50V M
C201	VE-30000400	EL CAP.	47UF 50V M
C205	VE-30000371	EL CAP.	22UF 50V M
C206	VE-30012610	SMD CAP.	10NF 50V J
C207	VE-30012610	SMD CAP.	10NF 50V J
C300	VE-30000400	EL CAP.	47UF 50V M
C302	VE-30000092	MKT CAP.	220NF 63V J
C305	VE-30000092	MKT CAP.	220NF 63V J
C404	VE-30000225	CER CAP.	220PF 50V J SL
C408	VE-30012586	SMD CAP.	22NF 50V K
C409	VE-30000345	EL CAP.	10UF 50V M
C410	VE-30000384	EL CAP.	2.2UF 50V M
C411	VE-30000345	EL CAP.	10UF 50V M

△ Symbol No.	Part No.	Part Name	Description
CAPACITOR			
C412	VE-30012586	SMD CAP.	22NF 50V K
C413	VE-30000362	EL CAP.	1UF 50V M
C414	VE-30012585	SMD CAP.	2.2NF 50V K R
C415	VE-30012581	SMD CAP.	1NF 50V K R
C416	VE-30000362	EL CAP.	1UF 50V M
C417	VE-30000362	EL CAP.	1UF 50V M
C418	VE-30012586	SMD CAP.	22NF 50V K
C419	VE-30000413	EL CAP.	4.7UF 50V M
C420	VE-30000100	MKT CAP.	330NF 63V J
C422	VE-30000400	EL CAP.	47UF 50V M
C423	VE-30000400	EL CAP.	47UF 50V M
C424	VE-30000345	EL CAP.	10UF 50V M
C425	VE-30012586	SMD CAP.	22NF 50V K
C426	VE-30016654	SMD CAP.	100NF 16V K R
C427	VE-30016654	SMD CAP.	100NF 16V K R
C429	VE-30012589	SMD CAP.	4.7NF 50V K
C431	VE-30000362	EL CAP.	1UF 50V M
C432	VE-30012586	SMD CAP.	22NF 50V K
C433	VE-30000345	EL CAP.	10UF 50V M
C434	VE-30016654	SMD CAP.	100NF 16V K R
C435	VE-30016654	SMD CAP.	100NF 16V K R
C436	VE-30000384	EL CAP.	2.2UF 50V M
C437	VE-30016654	SMD CAP.	100NF 16V K R
C438	VE-30016654	SMD CAP.	100NF 16V K R
C439	VE-30016654	SMD CAP.	100NF 16V K R
C440	VE-30000074	MKT CAP.	100NF 63V J
C441	VE-30012582	SMD CAP.	10NF 50V K R
C442	VE-30000384	EL CAP.	2.2UF 50V M
C443	VE-30000362	EL CAP.	1UF 50V M
C444	VE-30000384	EL CAP.	2.2UF 50V M
C446	VE-30000345	EL CAP.	10UF 50V M
C448	VE-30012586	SMD CAP.	22NF 50V K
C449	VE-30012567	SMD CAP.	220PF 50V J
C451	VE-30012589	SMD CAP.	4.7NF 50V K
C452	VE-30012589	SMD CAP.	4.7NF 50V K
C453	VE-30012581	SMD CAP.	1NF 50V K R
C454	VE-30012573	SMD CAP.	47PF 50V J
C455	VE-30012573	SMD CAP.	47PF 50V J
C456	VE-30012573	SMD CAP.	47PF 50V J
C459	VE-30012575	SMD CAP.	4.7PF 50V C CH
C460	VE-30000345	EL CAP.	10UF 50V M
C502	VE-30000396	EL CAP.	47UF 16V M
C504	VE-30012586	SMD CAP.	22NF 50V K
C505	VE-30012589	SMD CAP.	4.7NF 50V K
C510	VE-30012586	SMD CAP.	22NF 50V K
C511	VE-30012566	SMD CAP.	22PF 50V J
C513	VE-30000371	EL CAP.	22UF 50V M
C514	VE-30012586	SMD CAP.	22NF 50V K
C515	VE-30012579	SMD CAP.	82PF 50V J
C517	VE-30012586	SMD CAP.	22NF 50V K
C518	VE-30012586	SMD CAP.	22NF 50V K
C519	VE-30000352	EL CAP.	100UF 16V M
C520	VE-30012560	SMD CAP.	100PF 50V J
C521	VE-30012562	SMD CAP.	15PF 50V J
C522	VE-30012562	SMD CAP.	15PF 50V J
C523	VE-30012585	SMD CAP.	2.2NF 50V K R
C525	VE-30012566	SMD CAP.	22PF 50V J
C526	VE-30012586	SMD CAP.	22NF 50V K
C530	VE-30012589	SMD CAP.	4.7NF 50V K
C531	VE-30000384	EL CAP.	2.2UF 50V M
C532	VE-30012586	SMD CAP.	22NF 50V K
C536	VE-30000074	MKT CAP.	100NF 63V J
C541	VE-30000109	MKT CAP.	470NF 63V J
C542	VE-30000205	CER CAP.	150PF 50V J SL
C543	VE-30000205	CER CAP.	150PF 50V J SL
C545	VE-30012607	SMD CAP.	150PF 50V J
C603	VE-30000384	EL CAP.	2.2UF 50V M
C604	VE-30000400	EL CAP.	47UF 50V M
C608	VE-30000107	MKT CAP.	47NF 250V J
C610	VE-30018901	EL CAP.	100UF 50V M 105°
C611	VE-30000092	MKT CAP.	220NF 63V J
C613	VE-30016085	EL CAP.	10UF 63V 105°
C615	VE-30000359	EL CAP.	1000UF 16V M
C616	VE-30000400	EL CAP.	47UF 50V M
△ C618	VE-30000134	MKP CAP.	11NF 2000V 33.5
C619	VE-30000131	MKP CAP.	100NF 250V J
C623	VE-30000404	EL CAP.	47UF 160V M (HR)
C624	VE-30000350	EL CAP.	10UF 250V M
C627	VE-30000150	MKP CAP.	270NF 250V J 15/22.5MM
C628	VE-30018380	EL CAP.	3.3UF 160V M (105°)
C631	VE-30000410	EL CAP.	470UF 50V M
C632	VE-30000100	MKT CAP.	330NF 63V J
C634	VE-30000409	EL CAP.	470UF 25V M

[AV-21BF11EPS]

Symbol No.	Part No.	Part Name	Description
------------	----------	-----------	-------------

CAPACITOR

C635	VE-30000100	MKT CAP.	330NF 63V J
C636	VE-30000400	EL CAP.	47UF 50V M
C638	VE-30012581	SMD CAP.	1NF 50V K R
C639	VE-30000433	CER CAP.	1NF 1KV M B
C641	VE-30000345	EL CAP.	10UF 50V M
C642	VE-30012609	SMD CAP.	68NF 50V K
C643	VE-30000116	MKT CAP.	68NF 63V J
C644	VE-30000362	EL CAP.	1UF 50V M
C700	VE-30012565	SMD CAP.	1.8PF 50V J CH
C701	VE-30012565	SMD CAP.	1.8PF 50V J CH
C702	VE-30012573	SMD CAP.	47PF 50V J
C703	VE-30012573	SMD CAP.	47PF 50V J
C704	VE-30012576	SMD CAP.	56PF 50V J CH
C705	VE-30000345	EL CAP.	10UF 50V M
C706	VE-30000345	EL CAP.	10UF 50V M
C707	VE-30012573	SMD CAP.	47PF 50V J
C708	VE-30012586	SMD CAP.	22NF 50V K
C710	VE-30012573	SMD CAP.	47PF 50V J
C712	VE-30000345	EL CAP.	10UF 50V M
C713	VE-30016654	SMD CAP.	100NF 16V K R
C714	VE-30016654	SMD CAP.	100NF 16V K R
C716	VE-30016654	SMD CAP.	100NF 16V K R
C717	VE-30016654	SMD CAP.	100NF 16V K R
C718	VE-30016654	SMD CAP.	100NF 16V K R
C719	VE-30012586	SMD CAP.	22NF 50V K
C720	VE-30000345	EL CAP.	10UF 50V M
C721	VE-30016654	SMD CAP.	100NF 16V K R
C723	VE-30016654	SMD CAP.	100NF 16V K R
C724	VE-30000345	EL CAP.	10UF 50V M
C729	VE-30016654	SMD CAP.	100NF 16V K R
C730	VE-30000393	EL CAP.	3.3UF 50V M
C733	VE-30000345	EL CAP.	10UF 50V M
C734	VE-30000345	EL CAP.	10UF 50V M
C735	VE-30012586	SMD CAP.	22NF 50V K
C736	VE-30000345	EL CAP.	10UF 50V M
C737	VE-30000109	MKT CAP.	470NF 63V J
C738	VE-30000109	MKT CAP.	470NF 63V J
C739	VE-30000109	MKT CAP.	470NF 63V J
C740	VE-30000109	MKT CAP.	470NF 63V J
C741	VE-30012585	SMD CAP.	2.2NF 50V K R
C742	VE-30012585	SMD CAP.	2.2NF 50V K R
C748	VE-30012560	SMD CAP.	100PF 50V J
C801	VE-30000094	MKT CAP.	220NF 275V M AC
C802	VE-30000094	MKT CAP.	220NF 275V M AC
C803	VE-30000433	CER CAP.	1NF 1KV M B
C804	VE-30000433	CER CAP.	1NF 1KV M B
C808	VE-30000295	CER CAP.	100NF 50V Z F
C809	VE-30000418	EL CAP.	100UF 400V M
C810	VE-30000400	EL CAP.	47UF 50V M
C811	VE-30000161	MKT CAP.	47NF 630V J
C812	VE-30007308	CER CAP.	220PF 1KV K (PULSE)
C813	VE-30000295	CER CAP.	100NF 50V Z F
C816	VE-30000447	CER CAP.	4.7NF 4KV M E
C817	VE-30000198	CER CAP.	120PF 500V J SL
C818	VE-30016654	SMD CAP.	100NF 16V K R
C819	VE-30012609	SMD CAP.	68NF 50V K
C822	VE-30009208	CER CAP.	470PF 1KV K (PULSE)
C824	VE-30000433	CER CAP.	1NF 1KV M B
C826	VE-30000404	EL CAP.	47UF 160V M (HR)
C827	VE-30000411	EL CAP.	4700UF 16V M
C828	VE-30000295	CER CAP.	100NF 50V Z F
C829	VE-30000407	EL CAP.	470UF 16V M
C830	VE-30000382	EL CAP.	2200UF 16V M
C831	VE-30000431	CER CAP.	100PF 1KV M
C832	VE-30000295	CER CAP.	100NF 50V Z F
C833	VE-30000407	EL CAP.	470UF 16V M
C834	VE-30000295	CER CAP.	100NF 50V Z F
C836	VE-30000431	CER CAP.	100PF 1KV M
C838	VE-30000352	EL CAP.	100UF 16V M
C839	VE-30000352	EL CAP.	100UF 16V M
C840	VE-30000352	EL CAP.	100UF 16V M
C843	VE-30000431	CER CAP.	100PF 1KV M
C848	VE-30000352	EL CAP.	100UF 16V M
C849	VE-30000352	EL CAP.	100UF 16V M
C850	VE-30000352	EL CAP.	100UF 16V M
C855	VE-30000407	EL CAP.	470UF 16V M
C856	VE-30000433	CER CAP.	1NF 1KV M B
C858	VE-30007308	CER CAP.	220PF 1KV K (PULSE)
C859	VE-30013533	CER CAP.	100PF 1KV K (PULSE)
C907	VE-30000434	CER CAP.	1NF 2KV K B
C908	VE-30000415	EL CAP.	4.7UF 250V M
C912	VE-30000075	MKT CAP.	100NF 250V K (DC)

Symbol No.	Part No.	Part Name	Description
------------	----------	-----------	-------------

TRANSF

TR601	VE-30017788	FBT TRF
TR802	VE-30018592	SMPS TRF

COIL

L101	VE-30001971	FERRITE BEAT
L102	VE-30001971	FERRITE BEAT
L103	VE-30001971	FERRITE BEAT
L106	VE-30001971	FERRITE BEAT
L107	VE-30001971	FERRITE BEAT
L108	VE-30001971	FERRITE BEAT
L109	VE-30001971	FERRITE BEAT
L110	VE-30001971	FERRITE BEAT
L111	VE-30001971	FERRITE BEAT
L112	VE-30001971	FERRITE BEAT
L113	VE-30001971	FERRITE BEAT
L114	VE-30001971	FERRITE BEAT
L115	VE-30001971	FERRITE BEAT
L201	VE-30001979	FIXD COIL
L210	VE-30001971	FERRITE BEAT
L211	VE-30001971	FERRITE BEAT
L401	VE-30001971	FERRITE BEAT
L402	VE-30001992	FIXD COIL
L403	VE-30001971	FERRITE BEAT
L404	VE-30001990	FIXD COIL
L405	VE-30014048	ADJ. COIL
L406	VE-30001971	FERRITE BEAT
L407	VE-30002002	FIXD COIL
L603	VE-30018501	LINEARITY COIL
L604	VE-30001971	FERRITE BEAT
L700	VE-30001971	FERRITE BEAT
L701	VE-30001971	FERRITE BEAT
L702	VE-30001996	FIXD COIL
L703	VE-30001979	FIXD COIL
L704	VE-30001979	FIXD COIL
L802	VE-30001971	FERRITE BEAT
L803	VE-30000580	CF RES.
L805	VE-30001971	FERRITE BEAT
L806	VE-30001971	FERRITE BEAT
L807	VE-30001992	FIXD COIL
L809	VE-30001971	FERRITE BEAT
L810	VE-30001992	FIXD COIL
L900	VE-30002171	PEAKING COIL

DIODE

D101	VE-30007760	ZENER DIODE
D102	VE-30007760	ZENER DIODE
D103	VE-30007760	ZENER DIODE
D104	VE-30007762	ZENER DIODE
D106	VE-30001377	ZENER DIODE
D118	VE-30009366	DIODE
D300	VE-30001285	DIODE
D301	VE-30001285	DIODE
D402	VE-30012411	DIODE
D405	VE-30007763	ZENER DIODE
D407	VE-30001284	DIODE
D408	VE-30001285	DIODE
D409	VE-30007760	ZENER DIODE
D410	VE-30007760	ZENER DIODE
D411	VE-30007760	ZENER DIODE
D501	VE-30001285	DIODE
D505	VE-30001285	DIODE
D506	VE-30001284	DIODE
D509	VE-30001279	LED RED/GREEN
D512	VE-30001285	DIODE
D513	VE-30001339	ZENER DIODE
D602	VE-30001329	DIODE
D603	VE-30001285	DIODE
D608	VE-30001318	DIODE
D609	VE-30001318	DIODE
D610	VE-30001318	DIODE
D611	VE-30001285	DIODE
D614	VE-30001318	DIODE
D615	VE-30001285	DIODE
D616	VE-30009699	ZENER DIODE
D617	VE-30001285	DIODE
D618	VE-30001285	DIODE
D619	VE-30009699	ZENER DIODE
D700	VE-30001285	DIODE

[AV-21BF11EPS]

△ Symbol No.	Part No.	Part Name	Description
DIODE			
D701	VE-30001369	DIODE ZENER	
D800	VE-30001318	DIODE	
D801	VE-30001347	DIODE ZENER	
D802	VE-30001318	DIODE	
D803	VE-30001315	DIODE	
D804	VE-30001285	DIODE	
D805	VE-30009366	DIODE	
D806	VE-30001315	DIODE	
D808	VE-30007681	DIODE	
D809	VE-30001329	DIODE	
D810	VE-30068028	HE. ASY.	
△ D811	VE-30001329	DIODE	
△ D812	VE-30001285	DIODE	
△ D813	VE-30001329	DIODE	
△ D837	VE-30001329	DIODE	
△ D838	VE-30001329	DIODE	
D889	VE-30001384	TR	
D890	VE-30001329	DIODE	
D900	VE-30001318	DIODE	
D901	VE-30001318	DIODE	
D902	VE-30001318	DIODE	
D903	VE-30001344	ZENER DIODE	
D904	VE-30007760	ZENER DIODE	
D905	VE-30007760	ZENER DIODE	
D906	VE-30007760	ZENER DIODE	

TRANSISTOR

Q104	VE-30001457	TR	
Q106	VE-30001457	TR	
Q141	VE-30001457	TR	
Q142	VE-30001457	TR	
Q301	VE-30001458	TR	
Q302	VE-30001457	TR	
Q402	VE-30001457	TR	
Q405	VE-30001457	TR	
Q406	VE-30001457	TR	
Q503	VE-30001457	TR	
Q504	VE-30001458	TR	
△ Q601	VE-30013656	POWER TR	H. OUT
Q603	VE-30001448	TR	
Q604	VE-30001457	TR	
Q606	VE-30001457	TR	
Q700	VE-30001458	TR	
Q801	VE-30001386	TR	
Q802	VE-30001457	TR	
Q804	VE-30001454	TR	

IC

IC118	VE-30001506	IC	
IC301	VE-30011824	IC	
IC403	VE-30014510	IC	
IC500	VE-20108788	IC	(MEMORY)
IC501	VE-20099539	IC	(MICOM)
IC502	VE-30001670	PREAMPLIFIER	
IC600	VE-30015306	IC	
IC700	VE-30013658	IC	
IC800	VE-30011968	IC	
△ IC801	VE-30015087	IC	
IC803	VE-30001500	IC	
IC804	VE-30001622	IC	
IC806	VE-30014346	IC	
IC900	VE-30015857	IC	

△ Symbol No.	Part No.	Part Name	Description
OTHER			
△ F801	VE-30001731	FUSE	2.5A
△ PL908	VE-30001855	CRT SOCKET	
SG900	VE-30000428	SPARK GAP	300V
SG901	VE-30000428	SPARK GAP	300V
SG902	VE-30000428	SPARK GAP	300V
SW501	VE-30002178	TACK SWITCH	
SW502	VE-30002178	TACK SWITCH	
SW503	VE-30002178	TACK SWITCH	
SW504	VE-30002178	TACK SWITCH	
SW505	VE-30002178	TACK SWITCH	
△ SW801	VE-30017848	SWITCH ON/OFF	2.5A/100A
△ TH800	VE-30001270	PTC	9 OHM
△ TR801	VE-30002100	LINE FILTER	
△ TU201	VE-30009637	TUNER	
X401	VE-30001749	XTAL	
X402	VE-30015592	XTAL	
X403	VE-30000074	MKT CAP.	100NF 63V J
X501	VE-30002851	XTAL	
X700	VE-30001756	XTAL	
Z401	VE-30012545	SAW FILTER	
Z402	VE-30014261	SAW FILTER	
Z404	VE-30001724	SER FILTER	

**FRONT AV & HEADPHONE P.W. BOARD ASS'Y
(VE-20101564)**

△ Symbol No.	Part No.	Part Name	Description
RESISTOR			
R108	VE-30000712	CF RES.	1/4W 470R J
R110	VE-30000712	CF RES.	1/4W 470R J
R113	VE-30000744	CF RES.	1/4W 560R J
R114	VE-30000744	CF RES.	1/4W 560R J
R115	VE-30000712	CF RES.	1/4W 470R J
R116	VE-30000712	CF RES.	1/4W 470R J

CAPACITOR

C103	VE-30000213	CER CAP.	180PF 50V J
C104	VE-30000213	CER CAP.	180PF 50V J
C106	VE-30000190	CER CAP.	100PF 50V J

COIL

L103	VE-30001996	FIXED COIL	22UH Q40 K
L104	VE-30001996	FIXED COIL	22UH Q40 K

OTHERS

CON102	VE-30001893	RCA JACK	
CON103	VE-30001891	RCA JACK	
CON104	VE-30001892	RCA JACK	
CON106	VE-30001900	HEADPHONE JACK	HP01/2/3/4/5/6

PRINTED WIRING BOARD PARTS LIST

[AV-21BF11EJS]

MAIN P.W. BOARD ASS'Y (VE-20101540)

△ Symbol No.	Part No.	Part Name	Description
RESISTOR			
R105	VE-30000792	CF RES.	1/4W 75R J
R109	VE-30012713	SMD RES.	1/16W 75R J
R110	VE-30012713	SMD RES.	1/16W 75R J
R113	VE-30012713	SMD RES.	1/16W 75R J
R114	VE-30012713	SMD RES.	1/16W 75R J
R115	VE-30012713	SMD RES.	1/16W 75R J
R116	VE-30012987	SMD RES.	1/16W 56R J
R117	VE-30012713	SMD RES.	1/16W 75R J
R118	VE-30000792	CF RES.	1/4W 75R J
R122	VE-30000792	CF RES.	1/4W 75R J
R123	VE-30000792	CF RES.	1/4W 75R J
R126	VE-30012695	SMD RES.	1/16W 470R J
R127	VE-30000459	CF RES.	1/4W 100R J
R129	VE-30012713	SMD RES.	1/16W 75R J
R135	VE-30012657	SMD RES.	1/16W 1K J
R139	VE-30012713	SMD RES.	1/16W 75R J
R140	VE-30012987	SMD RES.	1/16W 56R J
R141	VE-30012695	SMD RES.	1/16W 470R J
R142	VE-30000459	CF RES.	1/4W 100R J
R145	VE-30012713	SMD RES.	1/16W 75R J
R149	VE-30000752	CF RES.	1/4W 56K J
R151	VE-30012696	SMD RES.	1/16W 47K J
R152	VE-30000752	CF RES.	1/4W 56K J
R153	VE-30012657	SMD RES.	1/16W 1K J
R154	VE-30000723	CF RES.	1/4W 47K J
R155	VE-30012649	SMD RES.	1/16W 150R J
R201	VE-30012674	SMD RES.	1/16W 27K J
R202	VE-30012692	SMD RES.	1/16W 4.7K J
R204	VE-30000459	CF RES.	1/4W 100R J
R206	VE-30000459	CF RES.	1/4W 100R J
R301	VE-30000471	CF RES.	1/4W 10K J
R302	VE-30000471	CF RES.	1/4W 10K J
R303	VE-30012641	SMD RES.	1/16W 10K J
R305	VE-30012641	SMD RES.	1/16W 10K J
R306	VE-30012509	SMD RES.	1/16W 100K J
R417	VE-30012510	SMD RES.	1/16W 100R J
R418	VE-30012510	SMD RES.	1/16W 100R J
R419	VE-30012649	SMD RES.	1/16W 150R J
R420	VE-30000466	CF RES.	1/4W 1K J
R421	VE-30012650	SMD RES.	1/16W 15K J
R422	VE-30012659	SMD RES.	1/16W 2.2K J
R423	VE-30012712	SMD RES.	1/16W 8.2K J
R424	VE-30000712	CF RES.	1/4W 470R J
R425	VE-30000583	CF RES.	1/4W 220R J
R426	VE-30012659	SMD RES.	1/16W 2.2K J
R427	VE-30012674	SMD RES.	1/16W 27K J
R428	VE-30000792	CF RES.	1/4W 75R J
R431	VE-30012674	SMD RES.	1/16W 27K J
R432	VE-30012657	SMD RES.	1/16W 1K J
R433	VE-30012667	SMD RES.	1/16W 220K J
R437	VE-30000466	CF RES.	1/4W 1K J
R438	VE-30000466	CF RES.	1/4W 1K J
R439	VE-30012657	SMD RES.	1/16W 1K J
R440	VE-30012714	SMD RES.	1/16W 820R J
R441	VE-30012656	SMD RES.	1/16W 18K J
R442	VE-30000466	CF RES.	1/4W 1K J
R446	VE-30012714	SMD RES.	1/16W 820R J
R447	VE-30012714	SMD RES.	1/16W 820R J
R448	VE-30012683	SMD RES.	1/16W 330K J
R449	VE-30012662	SMD RES.	1/16W 2.7K J
R450	VE-30000712	CF RES.	1/4W 470R J
R455	VE-30012650	SMD RES.	1/16W 15K J
R458	VE-30012662	SMD RES.	1/16W 2.7K J
R459	VE-30012510	SMD RES.	1/16W 100R J
R460	VE-30012510	SMD RES.	1/16W 100R J
R461	VE-30012510	SMD RES.	1/16W 100R J
R463	VE-30012692	SMD RES.	1/16W 4.7K J
R464	VE-30012650	SMD RES.	1/16W 15K J
R469	VE-30000670	CF RES.	1/4W 330K J
R470	VE-30012683	SMD RES.	1/16W 330K J
R474	VE-30012692	SMD RES.	1/16W 4.7K J
R475	VE-30012510	SMD RES.	1/16W 100R J
R476	VE-30012707	SMD RES.	1/16W 680R J
R477	VE-30014022	SMD RES.	1/16W 47R J
R502	VE-30012695	SMD RES.	1/16W 470R J
R503	VE-30012707	SMD RES.	1/16W 680R J
R504	VE-30012679	SMD RES.	1/16W 3.9K J
R505	VE-30012673	SMD RES.	1/16W 270R J
R506	VE-30012506	SMD RES.	1/16W 1.5K J

△ Symbol No.	Part No.	Part Name	Description
RESISTOR			
R507	VE-30012657	SMD RES.	1/16W 1K J
R508	VE-30000706	CF RES.	1/4W 47R J
R509	VE-30012641	SMD RES.	1/16W 10K J
R510	VE-30000622	CF RES.	1/4W 270R J
R511	VE-30012657	SMD RES.	1/16W 1K J
R512	VE-30012504	SMD RES.	1/16W 1.2K J
R513	VE-30000459	CF RES.	1/4W 100R J
R514	VE-30000459	CF RES.	1/4W 100R J
R515	VE-30012692	SMD RES.	1/16W 4.7K J
R516	VE-30012692	SMD RES.	1/16W 4.7K J
R517	VE-30012692	SMD RES.	1/16W 4.7K J
R518	VE-30000471	CF RES.	1/4W 10K J
R519	VE-30012698	SMD RES.	1/16W 5.6K J
R525	VE-30000583	CF RES.	1/4W 220R J
R526	VE-30012641	SMD RES.	1/16W 10K J
R527	VE-30000718	CF RES.	1/4W 4.7K J
R528	VE-30012698	SMD RES.	1/16W 5.6K J
R530	VE-30012698	SMD RES.	1/16W 5.6K J
R531	VE-30012692	SMD RES.	1/16W 4.7K J
R532	VE-30012659	SMD RES.	1/16W 2.2K J
R533	VE-30012644	SMD RES.	1/16W 12K J
R534	VE-30000526	CF RES.	1/4W 1.5K J
R535	VE-30000718	CF RES.	1/4W 4.7K J
R536	VE-30000471	CF RES.	1/4W 10K J
R537	VE-30012641	SMD RES.	1/16W 10K J
R538	VE-30012698	SMD RES.	1/16W 5.6K J
R539	VE-30012659	SMD RES.	1/16W 2.2K J
R540	VE-30012644	SMD RES.	1/16W 12K J
R545	VE-30012644	SMD RES.	1/16W 12K J
R546	VE-30000560	CF RES.	1/4W 1.8K J
R547	VE-30012659	SMD RES.	1/16W 2.2K J
R548	VE-30012641	SMD RES.	1/16W 10K J
R555	VE-30012659	SMD RES.	1/16W 2.2K J
R556	VE-30012657	SMD RES.	1/16W 1K J
R559	VE-30000470	CF RES.	1/2W 10K J
R560	VE-30012669	SMD RES.	1/16W 22K J
R561	VE-30012692	SMD RES.	1/16W 4.7K J
R562	VE-30000471	CF RES.	1/4W 10K J
R564	VE-30012641	SMD RES.	1/16W 10K J
R601	VE-30000752	CF RES.	1/4W 56K J
R602	VE-30000820	CF RES.	1/4W 82K J
R605	VE-30000477	CF RES.	1/4W 100K J
R612	VE-30012692	SMD RES.	1/16W 4.7K J
R613	VE-30012692	SMD RES.	1/16W 4.7K J
R618	VE-30012508	SMD RES.	1/16W 1.8K J
R619	VE-30012641	SMD RES.	1/16W 10K J
R623	VE-30000607	CF RES.	1/4W 2.2R J
R624	VE-30001120	MO RES.	2W 22R J
R625	VE-30000900	MF RES.	1/4W 1.8K J
R627	VE-30000929	MF RES.	1/2W 2.2R G
R630	VE-30000828	CF RES.	1/4W 8.2M J
R631	VE-30000885	MF RES.	1/4W 1.5K J
R633	VE-30000650	CF RES.	1/4W 33R J
R634	VE-30012641	SMD RES.	1/16W 10K J
R637	VE-30000621	CF RES.	1/2W 270R J
R638	VE-30000612	CF RES.	1/4W 2.4K J
R639	VE-30000718	CF RES.	1/4W 4.7K J
R640	VE-30012662	SMD RES.	1/16W 2.7K J
R641	VE-30012649	SMD RES.	1/16W 150R J
R645	VE-30018904	MO RES.	5W 4.7K J
R646	VE-30014941	CF RES.	1/4W 16K J
R647	VE-30000466	CF RES.	1/4W 1K J
△ R648	VE-30001249	FUSE RES.	1W 4.7R J
R649	VE-30000500	CF RES.	1/4W 12K J
R650	VE-30000744	CF RES.	1/4W 560R J
R654	VE-30000458	CF RES.	1/2W 100R J
R655	VE-30000705	CF RES.	1/2W 47R J
R657	VE-30012656	SMD RES.	1/16W 18K J
R659	VE-30001151	MO RES.	3W 330R J
R660	VE-30012669	SMD RES.	1/16W 22K J
R661	VE-30012674	SMD RES.	1/16W 27K J
R662	VE-30000712	CF RES.	1/4W 470R J
R663	VE-30000459	CF RES.	1/4W 100R J
R664	VE-30007779	MO RES.	5W 47R J (RADIAL)
R665	VE-30012708	SMD RES.	1/16W 68K J
R666	VE-30001099	MO RES.	2W 15R J
R701	VE-30000459	CF RES.	1/4W 100R J
R703	VE-30000459	CF RES.	1/4W 100R J
R705	VE-30000459	CF RES.	1/4W 100R J

[AV-21BF11EJS]

△ Symbol No.	Part No.	Part Name	Description
RESISTOR			
R715	VE-30012695	SMD RES.	1/16W 470R J
R717	VE-30012695	SMD RES.	1/16W 470R J
R719	VE-30012657	SMD RES.	1/16W 1K J
R721	VE-30000459	CF RES.	1/4W 100R J
R722	VE-30000459	CF RES.	1/4W 100R J
R723	VE-30012510	SMD RES.	1/16W 100R J
R724	VE-30012510	SMD RES.	1/16W 100R J
R725	VE-30012657	SMD RES.	1/16W 1K J
R726	VE-30012657	SMD RES.	1/16W 1K J
R727	VE-30012657	SMD RES.	1/16W 1K J
R728	VE-30012657	SMD RES.	1/16W 1K J
R729	VE-30012657	SMD RES.	1/16W 1K J
R730	VE-30012657	SMD RES.	1/16W 1K J
R731	VE-30012657	SMD RES.	1/16W 1K J
R801	VE-30000466	CF RES.	1/4W 1K J
R803	VE-30012659	SMD RES.	1/16W 2.2K J
R804	VE-30000477	CF RES.	1/4W 100K J
R805	VE-30000452	CF RES.	1/4W 10R J
R806	VE-30007199	MF RES.	1/4W 4.3K F
R807	VE-30001130	MO RES.	1/2W 0.22R J
R809	VE-30007784	MO RES.	5W 33K J (RADIAL)
△ R810	VE-30001257	MG RES.	1/2W 4.7M J
R811	VE-30000594	CF RES.	1/4W 22K J
R813	VE-30000718	CF RES.	1/4W 4.7K J
R814	VE-30012662	SMD RES.	1/16W 2.7K J
R815	VE-30000452	CF RES.	1/4W 10R J
R817	VE-30001037	MF RES.	1/4W 99K F
R818	VE-30006463	MF RES.	1/4W 2K F
R819	VE-30000810	CF RES.	1/4W 820R J
R821	VE-30000470	CF RES.	1/2W 10K J
R828	VE-30001260	WW RES.	5W 2.2R J
R829	VE-30000718	CF RES.	1/4W 4.7K J
R830	VE-30012657	SMD RES.	1/16W 1K J
R831	VE-30012669	SMD RES.	1/16W 22K J
R834	VE-30012641	SMD RES.	1/16W 10K J
R835	VE-30016802	WW RES.	5W 5.6R J RAD.
R900	VE-30006712	FERRITE BEAD	3.5X4.7X0.8
R901	VE-30006712	FERRITE BEAD	3.5X4.7X0.8
R902	VE-30006712	FERRITE BEAD	3.5X4.7X0.8
R903	VE-30000525	CF RES.	1/2W 1.5K J
R904	VE-30000525	CF RES.	1/2W 1.5K J
R905	VE-30000525	CF RES.	1/2W 1.5K J
R906	VE-30000525	CF RES.	1/2W 1.5K J
△ R919	VE-30001230	FUSE RES.	1/2W 27R J

CAPACITOR

C141	VE-30000384	EL CAP.	2.2UF 50V M
C142	VE-30000384	EL CAP.	2.2UF 50V M
C143	VE-30012589	SMD CAP.	4.7NF 50V K
C144	VE-30012589	SMD CAP.	4.7NF 50V K
C145	VE-30012589	SMD CAP.	4.7NF 50V K
C146	VE-30012589	SMD CAP.	4.7NF 50V K
C147	VE-30012589	SMD CAP.	4.7NF 50V K
C148	VE-30012589	SMD CAP.	4.7NF 50V K
C149	VE-30012589	SMD CAP.	4.7NF 50V K
C150	VE-30012589	SMD CAP.	4.7NF 50V K
C155	VE-30012560	SMD CAP.	100PF 50V J
C157	VE-30012560	SMD CAP.	100PF 50V J
C159	VE-30012560	SMD CAP.	100PF 50V J
C160	VE-30000387	EL CAP.	33UF 50V M
C161	VE-30000362	EL CAP.	1UF 50V M
C162	VE-30000362	EL CAP.	1UF 50V M
C201	VE-30000400	EL CAP.	47UF 50V M
C205	VE-30000371	EL CAP.	22UF 50V M
C206	VE-30012610	SMD CAP.	10NF 50V J
C207	VE-30012610	SMD CAP.	10NF 50V J
C300	VE-30000400	EL CAP.	47UF 50V M
C302	VE-30000092	MKT CAP.	220NF 63V J
C305	VE-30000092	MKT CAP.	220NF 63V J
C404	VE-30000225	CER CAP.	220PF 50V J SL
C408	VE-30012586	SMD CAP.	22NF 50V K
C409	VE-30000345	EL CAP.	10UF 50V M
C410	VE-30000384	EL CAP.	2.2UF 50V M
C411	VE-30000345	EL CAP.	10UF 50V M
C412	VE-30012586	SMD CAP.	22NF 50V K
C413	VE-30000362	EL CAP.	1UF 50V M
C414	VE-30012585	SMD CAP.	2.2NF 50V K R
C415	VE-30012581	SMD CAP.	1NF 50V K R
C416	VE-30000362	EL CAP.	1UF 50V M
C417	VE-30000362	EL CAP.	1UF 50V M

△ Symbol No.	Part No.	Part Name	Description
CAPACITOR			
C418	VE-30012586	SMD CAP.	22NF 50V K
C419	VE-30000413	EL CAP.	4.7UF 50V M
C420	VE-30000100	MKT CAP.	330NF 63V J
C422	VE-30000400	EL CAP.	47UF 50V M
C423	VE-30000400	EL CAP.	47UF 50V M
C424	VE-30000345	EL CAP.	10UF 50V M
C425	VE-30012586	SMD CAP.	22NF 50V K
C426	VE-30016654	SMD CAP.	100NF 16V K R
C427	VE-30016654	SMD CAP.	100NF 16V K R
C429	VE-30012589	SMD CAP.	4.7NF 50V K
C431	VE-30000362	EL CAP.	1UF 50V M
C432	VE-30012586	SMD CAP.	22NF 50V K
C433	VE-30000345	EL CAP.	10UF 50V M
C434	VE-30016654	SMD CAP.	100NF 16V K R
C435	VE-30016654	SMD CAP.	100NF 16V K R
C436	VE-30000384	EL CAP.	2.2UF 50V M
C437	VE-30016654	SMD CAP.	100NF 16V K R
C438	VE-30016654	SMD CAP.	100NF 16V K R
C439	VE-30016654	SMD CAP.	100NF 16V K R
C440	VE-30000074	MKT CAP.	100NF 63V J
C441	VE-30012582	SMD CAP.	10NF 50V K R
C442	VE-30000384	EL CAP.	2.2UF 50V M
C443	VE-30000362	EL CAP.	1UF 50V M
C444	VE-30000384	EL CAP.	2.2UF 50V M
C448	VE-30012586	SMD CAP.	22NF 50V K
C449	VE-30012567	SMD CAP.	220PF 50V J
C451	VE-30012581	SMD CAP.	1NF 50V K R
C452	VE-30012581	SMD CAP.	1NF 50V K R
C454	VE-30012573	SMD CAP.	47PF 50V J
C455	VE-30012573	SMD CAP.	47PF 50V J
C456	VE-30012573	SMD CAP.	47PF 50V J
C459	VE-30012575	SMD CAP.	4.7PF 50V C GH
C460	VE-30000345	EL CAP.	10UF 50V M
C502	VE-30000396	EL CAP.	47UF 16V M
C504	VE-30012586	SMD CAP.	22NF 50V K
C505	VE-30012589	SMD CAP.	4.7NF 50V K
C510	VE-30012586	SMD CAP.	22NF 50V K
C511	VE-30012566	SMD CAP.	22PF 50V J
C513	VE-30000371	EL CAP.	22UF 50V M
C514	VE-30012586	SMD CAP.	22NF 50V K
C515	VE-30012579	SMD CAP.	82PF 50V J
C517	VE-30012586	SMD CAP.	22NF 50V K
C518	VE-30012586	SMD CAP.	22NF 50V K
C519	VE-30000352	EL CAP.	100UF 16V M
C520	VE-30012560	SMD CAP.	100PF 50V J
C521	VE-30012562	SMD CAP.	15PF 50V J
C522	VE-30012562	SMD CAP.	15PF 50V J
C523	VE-30012585	SMD CAP.	2.2NF 50V K R
C525	VE-30012566	SMD CAP.	22PF 50V J
C526	VE-30012586	SMD CAP.	22NF 50V K
C530	VE-30012589	SMD CAP.	4.7NF 50V K
C531	VE-30000384	EL CAP.	2.2UF 50V M
C532	VE-30012586	SMD CAP.	22NF 50V K
C536	VE-30000074	MKT CAP.	100NF 63V J
C541	VE-30000109	MKT CAP.	470NF 63V J
C542	VE-30000205	CER CAP.	150PF 50V J SL
C543	VE-30000205	CER CAP.	150PF 50V J SL
C545	VE-30012607	SMD CAP.	150PF 50V J
C603	VE-30000384	EL CAP.	2.2UF 50V M
C604	VE-30000400	EL CAP.	47UF 50V M
C608	VE-30000107	MKT CAP.	47NF 250V J
C610	VE-30018901	EL CAP.	100UF 50V M 105°
C611	VE-30000092	MKT CAP.	220NF 63V J
C613	VE-30016085	EL CAP.	10UF 63V 105°
C615	VE-30000359	EL CAP.	100UF 16V M
C616	VE-30000400	EL CAP.	47UF 50V M
△ C618	VE-30000134	MKP CAP.	11NF 2000V 3.5
C619	VE-30000131	MKP CAP.	100NF 250V J
C623	VE-30000404	EL CAP.	47UF 160V M (HR)
C624	VE-30000350	EL CAP.	10UF 250V M
C627	VE-30000150	MKP CAP.	270NF 250V J 15/22.5MM
C628	VE-30018380	EL CAP.	3.3UF 160V M (105°)
C631	VE-30000410	EL CAP.	470UF 50V M
C632	VE-30000100	MKT CAP.	330NF 63V J
C634	VE-30000409	EL CAP.	470UF 25V M
C635	VE-30000100	MKT CAP.	330NF 63V J
C636	VE-30000400	EL CAP.	47UF 50V M
C638	VE-30012581	SMD CAP.	1NF 50V K R
C639	VE-30000433	CER CAP.	1NF 1KV M B
C641	VE-30000345	EL CAP.	10UF 50V M
C642	VE-30012609	SMD CAP.	68NF 50V K
C643	VE-30000116	MKT CAP.	68NF 63V J

[AV-21BF11EJS]

Symbol No.	Part No.	Part Name	Description
------------	----------	-----------	-------------

CAPACITOR

C644	VE-30000362	EL CAP.	1UF 50V M
C700	VE-30012565	SMD CAP.	1.8PF 50V J CH
C701	VE-30012565	SMD CAP.	1.8PF 50V J CH
C702	VE-30012573	SMD CAP.	47PF 50V J
C703	VE-30012573	SMD CAP.	47PF 50V J
C704	VE-30012576	SMD CAP.	56PF 50V J CH
C705	VE-30000345	EL CAP.	10UF 50V M
C706	VE-30000345	EL CAP.	10UF 50V M
C707	VE-30012573	SMD CAP.	47PF 50V J
C708	VE-30012586	SMD CAP.	22NF 50V K
C710	VE-30012573	SMD CAP.	47PF 50V J
C712	VE-30000345	EL CAP.	10UF 50V M
C713	VE-30016654	SMD CAP.	100NF 16V K R
C714	VE-30016654	SMD CAP.	100NF 16V K R
C716	VE-30016654	SMD CAP.	100NF 16V K R
C717	VE-30016654	SMD CAP.	100NF 16V K R
C718	VE-30016654	SMD CAP.	100NF 16V K R
C719	VE-30012586	SMD CAP.	22NF 50V K
C720	VE-30000345	EL CAP.	10UF 50V M
C721	VE-30016654	SMD CAP.	100NF 16V K R
C723	VE-30016654	SMD CAP.	100NF 16V K R
C724	VE-30000345	EL CAP.	10UF 50V M
C729	VE-30016654	SMD CAP.	100NF 16V K R
C730	VE-30000393	EL CAP.	3.3UF 50V M
C733	VE-30000345	EL CAP.	10UF 50V M
C734	VE-30000345	EL CAP.	10UF 50V M
C735	VE-30012586	SMD CAP.	22NF 50V K
C736	VE-30000345	EL CAP.	10UF 50V M
C737	VE-30000109	MKT CAP.	470NF 63V J
C738	VE-30000109	MKT CAP.	470NF 63V J
C739	VE-30000109	MKT CAP.	470NF 63V J
C740	VE-30000109	MKT CAP.	470NF 63V J
C741	VE-30012585	SMD CAP.	2.2NF 50V K R
C742	VE-30012585	SMD CAP.	2.2NF 50V K R
C748	VE-30012560	SMD CAP.	100PF 50V J
△ C801	VE-30000094	MKT CAP.	220NF 275V M AC
△ C802	VE-30000094	MKT CAP.	220NF 275V M AC
△ C803	VE-30000433	CER CAP.	1NF 1KV M B
△ C804	VE-30000433	CER CAP.	1NF 1KV M B
C808	VE-30000295	CER CAP.	100NF 50V Z F
C809	VE-30000418	EL CAP.	100UF 400V M
C810	VE-30000400	EL CAP.	47UF 50V M
C811	VE-30000161	MKT CAP.	47NF 630V J
C812	VE-30007308	CER CAP.	220PF 1KV K (PULSE)
C813	VE-30000295	CER CAP.	100NF 50V Z F
△ C816	VE-30000447	CER CAP.	4.7NF 4KV M E
C817	VE-30000198	CER CAP.	120PF 500V J SL
C818	VE-30016654	SMD CAP.	100NF 16V K R
C819	VE-30012609	SMD CAP.	68NF 50V K
C822	VE-30009208	CER CAP.	470PF 1KV K (PULSE)
C824	VE-30000433	CER CAP.	1NF 1KV M B
C826	VE-30000404	EL CAP.	47UF 160V M (HR)
C827	VE-30000411	EL CAP.	470UF 16V M
C828	VE-30000295	CER CAP.	100NF 50V Z F
C829	VE-30000407	EL CAP.	470UF 16V M
C830	VE-30000382	EL CAP.	2200UF 16V M
C831	VE-30000431	CER CAP.	100PF 1KV M
C832	VE-30000295	CER CAP.	100NF 50V Z F
C833	VE-30000407	EL CAP.	470UF 16V M
C834	VE-30000295	CER CAP.	100NF 50V Z F
C836	VE-30000431	CER CAP.	100PF 1KV M
C838	VE-30000352	EL CAP.	100UF 16V M
C839	VE-30000352	EL CAP.	100UF 16V M
C840	VE-30000352	EL CAP.	100UF 16V M
C843	VE-30000431	CER CAP.	100PF 1KV M
C848	VE-30000352	EL CAP.	100UF 16V M
C849	VE-30000352	EL CAP.	100UF 16V M
C850	VE-30000352	EL CAP.	100UF 16V M
C855	VE-30000407	EL CAP.	470UF 16V M
C856	VE-30000433	CER CAP.	1NF 1KV M B
C858	VE-30007308	CER CAP.	220PF 1KV K (PULSE)
C859	VE-30013533	CER CAP.	100PF 1KV K (PULSE)
C907	VE-30000434	CER CAP.	1NF 2KV K B
C908	VE-30000415	EL CAP.	4.7UF 250V M
C912	VE-30000075	MKT CAP.	100NF 250V K (DC)

TRANSF

△ TR601	VE-30017788	FBT TRF
△ TR802	VE-30018592	SMPS TRF

Symbol No.	Part No.	Part Name	Description
------------	----------	-----------	-------------

COIL

L101	VE-30001971	FERRITE BEAT	
L102	VE-30001971	FERRITE BEAT	
L103	VE-30001971	FERRITE BEAT	
L106	VE-30001971	FERRITE BEAT	
L107	VE-30001971	FERRITE BEAT	
L108	VE-30001971	FERRITE BEAT	
L109	VE-30001971	FERRITE BEAT	
L110	VE-30001971	FERRITE BEAT	
L111	VE-30001971	FERRITE BEAT	
L112	VE-30001971	FERRITE BEAT	
L113	VE-30001971	FERRITE BEAT	
L114	VE-30001971	FERRITE BEAT	
L115	VE-30001971	FERRITE BEAT	
L201	VE-30001979	FIXD COIL	1UH
L210	VE-30001971	FERRITE BEAT	
L211	VE-30001971	FERRITE BEAT	
L401	VE-30001971	FERRITE BEAT	
L402	VE-30001992	FIXD COIL	10UH
L403	VE-30001971	FERRITE BEAT	
L404	VE-30001990	FIXD COIL	6.8UH
L405	VE-30014048	ADJ. COIL	44MHZ
L406	VE-30001971	FERRITE BEAT	
L603	VE-30018501	LINARITY COIL	100UH
L604	VE-30001971	FERRITE BEAT	
L700	VE-30001971	FERRITE BEAT	
L701	VE-30001971	FERRITE BEAT	
L702	VE-30001996	FIXD COIL	22UH
L703	VE-30001979	FIXD COIL	1UH
L704	VE-30001979	FIXD COIL	1UH
L802	VE-30001971	FERRITE BEAT	
L803	VE-30000580	CF RES.	1/4W 22R J
L805	VE-30001971	FERRITE BEAT	
L806	VE-30001971	FERRITE BEAT	
L807	VE-30001992	FIXD COIL	10UH
L809	VE-30001971	FERRITE BEAT	
L810	VE-30001992	FIXD COIL	10UH
L900	VE-30002171	PEAKING COIL	22UH K

DIODE

D101	VE-30007760	ZENER DIODE	
D102	VE-30007760	ZENER DIODE	
D103	VE-30007760	ZENER DIODE	
D104	VE-30007762	ZENER DIODE	
D106	VE-30001377	ZENER DIODE	
D118	VE-30009366	DIODE	
D300	VE-30001285	DIODE	
D301	VE-30001285	DIODE	
D405	VE-30007763	ZENER DIODE	
D407	VE-30001284	DIODE	
D408	VE-30001285	DIODE	
D409	VE-30007760	ZENER DIODE	
D410	VE-30007760	ZENER DIODE	
D411	VE-30007760	ZENER DIODE	
D501	VE-30001285	DIODE	
D505	VE-30001285	DIODE	
D506	VE-30001284	DIODE	
D509	VE-30001279	LED RED/GREEN	
D512	VE-30001285	DIODE	
D513	VE-30001339	ZENER DIODE	
D602	VE-30001329	DIODE	
D603	VE-30001285	DIODE	
D608	VE-30001318	DIODE	
D609	VE-30001318	DIODE	
D610	VE-30001318	DIODE	
D611	VE-30001285	DIODE	
D614	VE-30001318	DIODE	
D615	VE-30001285	DIODE	
D616	VE-30009699	ZENER DIODE	
D617	VE-30001285	DIODE	
D618	VE-30001285	DIODE	
D619	VE-30009699	ZENER DIODE	
D700	VE-30001285	DIODE	
D701	VE-30001369	ZENER DIODE	
D800	VE-30001318	DIODE	
D801	VE-30001347	ZENER DIODE	
D802	VE-30001318	DIODE	
D803	VE-30001315	DIODE	
D804	VE-30001285	DIODE	
D805	VE-30009366	DIODE	
D806	VE-30001315	DIODE	
D808	VE-30007681	DIODE	
D809	VE-30001329	DIODE	

[AV-21BF11EJS]

Symbol No.	Part No.	Part Name	Description
------------	----------	-----------	-------------

DIODE

D810	VE-20068028	HE. ASY.	
Δ D811	VE-30001329	DIODE	
Δ D812	VE-30001285	DIODE	
Δ D813	VE-30001329	DIODE	
Δ D837	VE-30001329	DIODE	
Δ D838	VE-30001329	DIODE	
D889	VE-30001384	TR	
D890	VE-30001329	DIODE	
D900	VE-30001318	DIODE	
D901	VE-30001318	DIODE	
D902	VE-30001318	DIODE	
D903	VE-30001344	ZENER DIODE	
D904	VE-30007760	ZENER DIODE	
D905	VE-30007760	ZENER DIODE	
D906	VE-30007760	ZENER DIODE	

TRANSISTOR

Q104	VE-30001457	TR	
Q106	VE-30001457	TR	
Q141	VE-30001457	TR	
Q142	VE-30001457	TR	
Q301	VE-30001458	TR	
Q302	VE-30001457	TR	
Q406	VE-30001457	TR	
Q503	VE-30001457	TR	
Q504	VE-30001458	TR	
Q601	VE-30013656	POWER TR	
Δ Q603	VE-30001448	TR	H. OUT
Q604	VE-30001457	TR	
Q606	VE-30001457	TR	
Q700	VE-30001458	TR	
Q801	VE-30001386	TR	
Q802	VE-30001457	TR	
Q804	VE-30001454	TR	

IC

IC118	VE-30001506	IC	
IC301	VE-30011824	IC	
IC403	VE-30014521	IC	
IC500	VE-20108790	IC	(MEMORY)
IC501	VE-20099539	IC	(MICOM)
IC502	VE-30001670	PREAMPLIFIER	
Δ IC600	VE-30015306	IC	
IC700	VE-30013658	IC	
IC800	VE-30011968	IC	
Δ IC801	VE-30015087	IC	
IC803	VE-30001500	IC	
IC804	VE-30001622	IC	
IC806	VE-30014346	IC	
IC900	VE-30015857	IC	

OTHER

Δ F801	VE-30001731	FUSE	2.5A
Δ PL903	VE-30001855	CRT SOCKET	
SG900	VE-30000428	SPARK GAP	300V
SG901	VE-30000428	SPARK GAP	300V
SG902	VE-30000428	SPARK GAP	300V
SW501	VE-30002178	TACK SWITCH	
SW502	VE-30002178	TACK SWITCH	
SW503	VE-30002178	TACK SWITCH	
SW504	VE-30002178	TACK SWITCH	
SW505	VE-30002178	TACK SWITCH	
Δ SW801	VE-30017848	SWITCH ON/OFF	2.5A/100A
Δ TH800	VE-30001270	PTC	9 OHM
Δ TR801	VE-30002100	LINE FILTER	
TU201	VE-30009637	TUNER	
X401	VE-30001749	XTAL	
X402	VE-30015592	XTAL	
X403	VE-30000074	MKT CAP.	100NF 63V J
X501	VE-30002851	XTAL	
X700	VE-30001756	XTAL	
Z401	VE-30003163	SAW FILTER	
Z402	VE-30004261	SAW FILTER	

**FRONT AV & HEADPHONE P.W. BOARD ASS'Y
(VE-20101564)**

Symbol No.	Part No.	Part Name	Description
------------	----------	-----------	-------------

RESISTOR

R108	VE-30000712	CF RES.	1/4W 470R J
R110	VE-30000712	CF RES.	1/4W 470R J
R113	VE-30000744	CF RES.	1/4W 560R J
R114	VE-30000744	CF RES.	1/4W 560R J
R115	VE-30000712	CF RES.	1/4W 470R J
R116	VE-30000712	CF RES.	1/4W 470R J

CAPACITOR

C103	VE-30000213	CER CAP.	180PF 50V J
C104	VE-30000213	CER CAP.	180PF 50V J
C106	VE-30000190	CER CAP.	100PF 50V J

COIL

L103	VE-30001996	FIXED COIL	22UH Q40 K
L104	VE-30001996	FIXED COIL	22UH Q40 K

OTHERS

CON102	VE-30001893	RCA JACK	
CON103	VE-30001891	RCA JACK	
CON104	VE-30001892	RCA JACK	
CON106	VE-30001900	HEADPHONE JACK	HP01/2/3/4/5/6

AV-21BF11ENS
AV-21BF11EES
AV-21BF11EPS
AV-21BF11EJS

PACKING

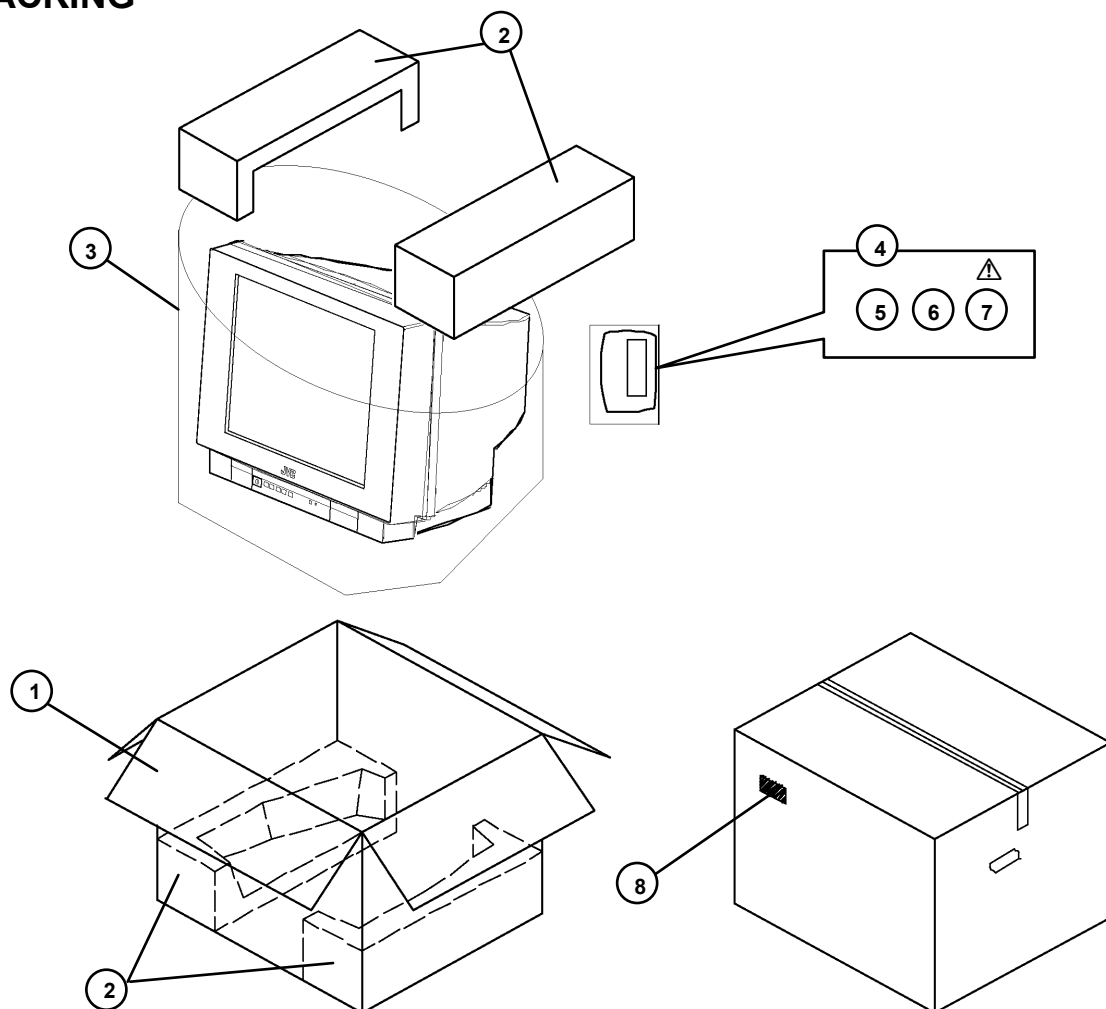

PACKING PARTS LIST

△ Ref.No.	Part No.	Part Name	Description
1	VE-50028254	CARTON BOX	(AV-21BF11ENS)
1	VE-50028331	CARTON BOX	(AV-21BF11EES)
1	VE-50028286	CARTON BOX	(AV-21BF11EPS)
1	VE-50028413	CARTON BOX	(AV-21BF11EJS)
2	VE-20068004	CUSHION ASS'Y	4pcs in 1 set
3	VE-50027456	POLY BAG	
4	VE-70000587	POLY BAG	
5	VE-30017763	REMOTE CONTROL UNIT (RM-C1100)	
6	BT-54013-2TK	WARRANTY CARD	
△ 7	VE-50028252	INST BOOK	(AV-21BF11ENS)
△ 7	VE-50028323	INST BOOK	(AV-21BF11EES)
△ 7	VE-50028287	INST BOOK	(AV-21BF11EPS)
△ 7	VE-50028290	INST BOOK	(AV-21BF11EJS)
8	VE-20101395	LABEL	(AV-21BF11ENS)
8	VE-20101660	LABEL	(AV-21BF11EES)
8	VE-20101560	LABEL	(AV-21BF11EES POLAND)
8	VE-20101548	LABEL	(AV-21BF11EPS)
8	VE-20101872	LABEL	(AV-21BF11EJS)

JVC

VICTOR COMPANY OF JAPAN, LIMITED

HOME AV NETWORK BUSINESS UNIT 12, 3-chome, Moriya-cho, Kanagawa-ku, Yokohama, Kanagawa-prefecture, 221-8528, Japan



VP 0207
DP20598051