

# SHARP SERVICE MANUAL

No. S2213WF2100WS

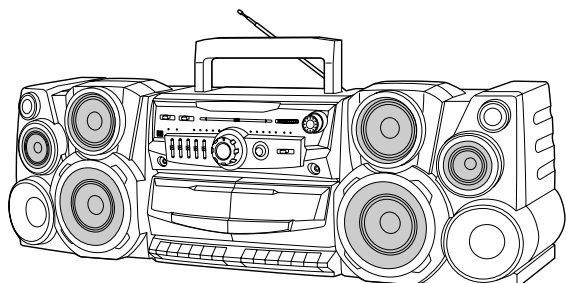

PORTABLE STEREO COMPONENT SYSTEM

## MODEL WF-2100W(S)

PORTABLE STEREO COMPONENT SYSTEM

## MODEL WF-2100W(BK)

- In the interests of user-safety the set should be restored to its original condition and only parts identical to those specified be used.

### CONTENTS

	Page
SPECIFICATIONS .....	2
VOLTAGE SELECTION .....	2
AC POWER SUPPLY CORD AND AC PLUG ADAPTOR .....	2
NAMES OF PARTS .....	3
DISASSEMBLY .....	4
REMOVING AND REINSTALLING THE MAIN PARTS .....	5
ADJUSTMENT .....	6
FITTING OF DIAL POINTER .....	8
NOTES ON SCHEMATIC DIAGRAM .....	8
TYPES OF TRANSISTOR AND LED .....	9
VOLTAGE .....	9
SCHEMATIC DIAGRAM / WIRING SIDE OF P.W.BOARD .....	10
PARTS GUIDE / EXPLODED VIEW	

## WF-2100W

FOR A COMPLETE DESCRIPTION OF THE OPERATION OF THIS UNIT, PLEASE REFER TO THE OPERATION MANUAL.

### SPECIFICATIONS

#### ● General

<b>Power source:</b>	AC 110-127 V/220-240 V, 50/60 Hz DC 15 V ["D" size (UM/SUM-1, R20 or HP-2) battery × 10]
<b>Power consumption:</b>	33 W
<b>Output power:</b>	MPO (Max.); 50 W (25 W + 25 W) (AC operation) RMS; 25 W (12.5 W + 12.5 W) (DC operation, 10 % T.H.D.)
<b>Input terminal:</b>	Mixing microphone; 1 mV/600 ohms CD/LINE; 350 mV/47 kohms
<b>Output terminal:</b>	Headphones; 16-50 ohms (recommended; 32 ohms)
<b>Dimensions:</b>	Width; 282 mm (11-1/8") Height; 217 mm (8-9/16") Depth; 207 mm (8-1/8")
<b>Weight:</b>	3.5 kg (7.7 lbs.) without batteries

#### ● Radio section

<b>Frequency range:</b>	FM; 88 - 108 MHz SW1; 2.3 - 7.3 MHz SW2; 7.3 - 22 MHz MW; 526.5 - 1,606.5 kHz
-------------------------	--

#### ● Tape recorder section

<b>Frequency response:</b>	60 - 12,000 Hz (Normal tape)
<b>Signal/noise ratio:</b>	40 dB (TAPE 1, recording/playback) 50 dB (TAPE 2, playback)
<b>Wow and flutter:</b>	0.3 % (WRMS)
<b>Motor:</b>	DC 9 V electric governor
<b>Bias system:</b>	AC bias
<b>Erase system:</b>	Magnet erase

#### ● Speaker section

<b>Speakers:</b>	9 cm (3-9/16") woofer × 1 7.5 cm (3") woofer × 1 5 cm (2") tweeter × 1 Super tweeter × 1
<b>Maximum input power:</b>	25 W
<b>Rated input power:</b>	12.5 W
<b>Impedance:</b>	8 ohms
<b>Dimensions:</b>	Width; 235 mm (9-1/4") Height; 235 mm (9-1/4") Depth; 192 mm (7-9/16")
<b>Weight:</b>	2.0 kg (4.4 lbs.)/each

Specifications for this model are subject to change without prior notice.

### VOLTAGE SELECTION

Before operating the unit on mains, check the preset voltage. If the voltage is different from your local voltage, adjust the voltage as follows. Slide the selector with a screwdriver to the appropriate voltage number. (AC 110 - 127 V or AC 220 - 240 V).

### AC POWER SUPPLY CORD AND AC PLUG ADAPTOR

QACCA0004AW00

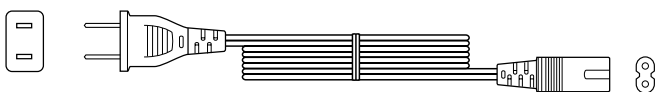

QPLGA0003AWZZ

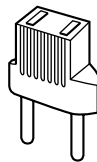

QPLGA0004AWZZ



QACCE0007AW00

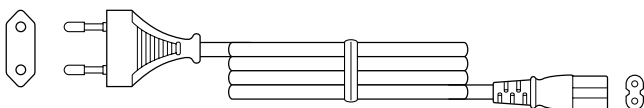

## NAMES OF PARTS

1. Function Selector Switch
2. Power/(TAPE 2) Play Direction Indicators
3. Dubbing Speed/Built-in Microphone/FM Mode Switch
4. Graphic Equalizer Controls
5. Volume Control
6. Surround Switch (with Indicator)
7. Fine Tuning Control
8. Tuning Control
9. Built-in Microphone
10. Extra Bass Control
11. Headphone Socket
12. (TAPE 1) Cassette Compartment
13. FM Stereo Indicator
14. Band Selector Switch
15. Mixing Microphone Socket
16. (TAPE 2) Cassette Compartment
17. (TAPE 1) Record Button
18. (TAPE 1) Play Button
19. (TAPE 1) Rewind Button
20. (TAPE 1) Fast Forward Button
21. (TAPE 1) Stop/Eject Button
22. (TAPE 1) Pause Button
23. (TAPE 2) Reverse Mode Switch
24. (TAPE 2) Play Button
25. (TAPE 2) Fast Wind Buttons
26. (TAPE 2) Stop/Eject Button
27. (TAPE 2) Direction Switch

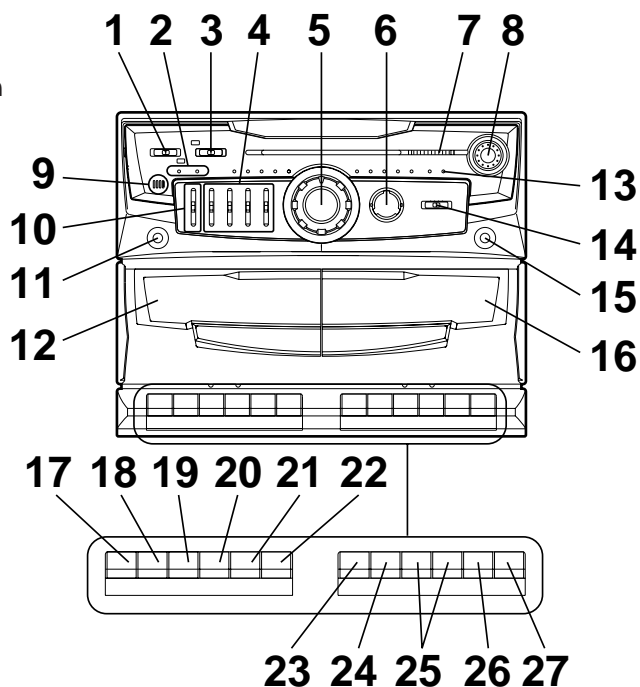

28. FM/SW Telescopic Rod Aerial
29. CD/Line Input Sockets
30. Beat Cancel Switch
31. Speaker Terminals
32. AC Voltage Selector
33. AC Power Input Socket
34. Battery Compartment

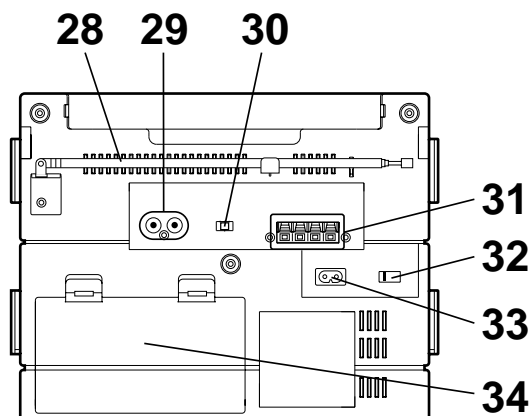

35. Woofer
36. Super Tweeter
37. Tweeter
38. Bass Reflex Duct
39. Speaker Release Lever
40. Speaker Wire

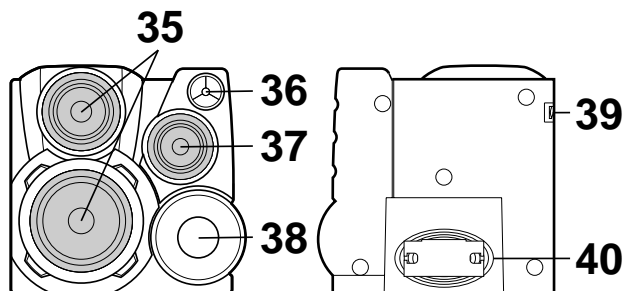

## DISASSEMBLY

### Caution on Disassembly

Follow the below-mentioned notes when disassembling the unit and reassembling it, to keep it safe and ensure excellent performance:

1. Take cassette tape out of the unit.
2. Be sure to remove the power supply plug from the wall outlet before starting to disassemble the unit and remove the batteries from the unit.
3. Take off nylon bands or wire holders where they need to be removed when disassembling the unit. After servicing the unit, be sure to rearrange the leads where they were before disassembling.
4. Take sufficient care on static electricity of integrated circuits and other circuits when servicing.

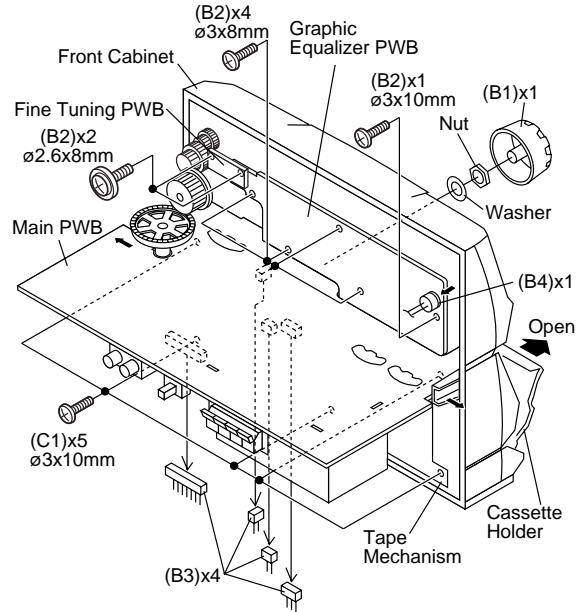

Figure 4-2

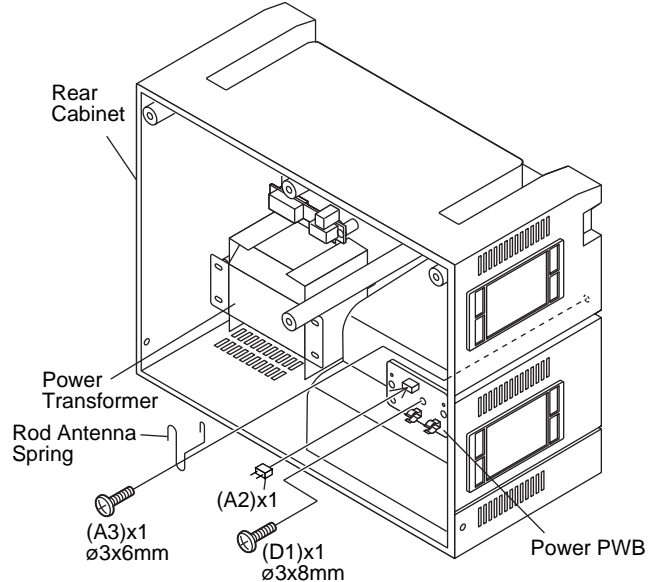

Figure 4-3

### MAIN UNIT

STEP	REMOVAL	PROCEDURE	FIGURE
1	Front Cabinet/ Rear Cabinet	1. Screw ..... (A1) x9 2. Socket ..... (A2) x1 3. Screw ..... (A3) x1	4-1 4-3
2	Main PWB/ Graphic Equalizer PWB/Fine Tuning PWB	1. Knob ..... (B1) x1 2. Screw ..... (B2) x7 3. Socket ..... (B3) x4 4. Mic ..... (B4) x1	4-2
3	Tape Mechanism	1. Open the cassette holder. 2. Screw ..... (C1) x5	4-2
4	Power PWB	1. Screw ..... (D1) x1	4-3

### SPEAKER UNIT

STEP	REMOVAL	PROCEDURE	FIGURE
1	Woofers	1. Screw ..... (A1) x5 2. Front Panel ..... (A2) x1 3. Screw ..... (A3) x8	4-4
2	Tweeter	1. Screw ..... (B1) x2	4-4

### SPEAKER UNIT

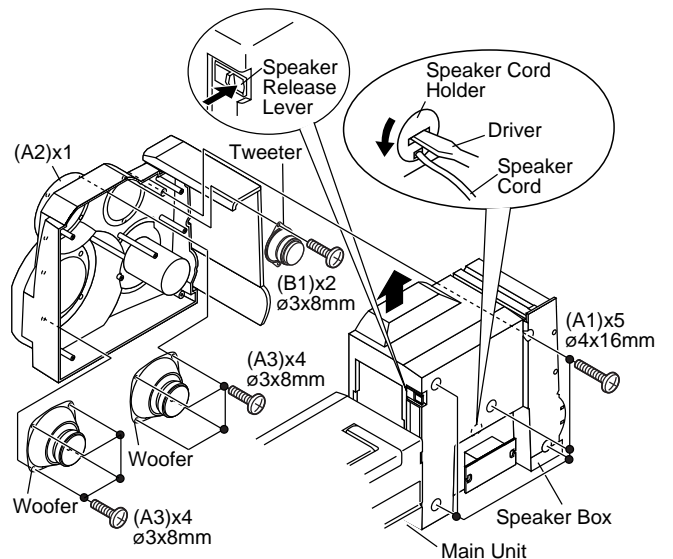

Figure 4-4

### MAIN UNIT

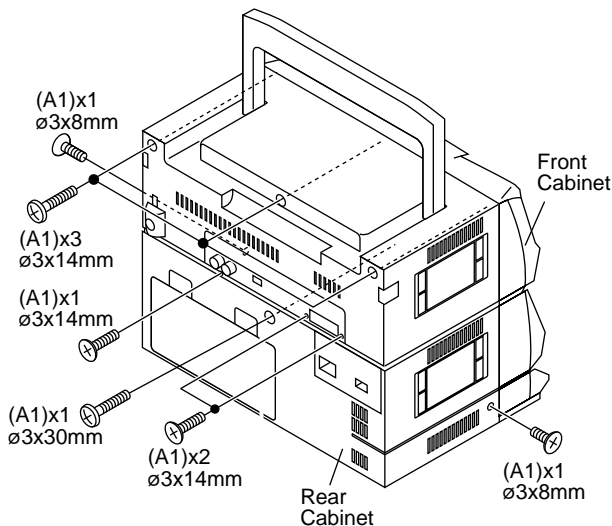

Figure 4-1

## REMOVING AND REINSTALLING THE MAIN PARTS

### TAPE MECHANISM SECTION

Perform steps 1, 2 and 3 of the disassembly method to remove the tape mechanism. (See page 4.)

#### How to remove the record/playback and erase heads (TAPE 1) (See Fig. 5-1)

1. When you remove the screws (A1) x 2 pcs., the recording/playback head can be removed.
2. Move the hooks (A2) x 2 pcs., toward the center position as shown in Fig. 5-1 and then lift the erase head.

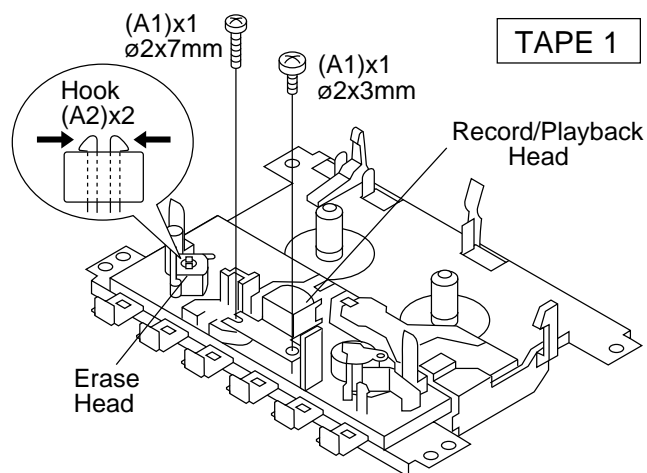

Figure 5-1

#### How to remove the playback head (TAPE 2) (See Fig. 5-2)

1. When you remove the screws (B1) x 2 pcs., the playback head can be removed.

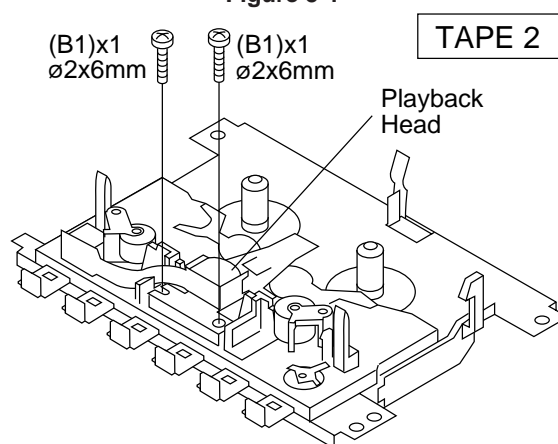

Figure 5-2

#### How to remove the pinch roller (TAPE 1/2) (See Fig. 5-3)

1. Carefully bend the pinch roller pawl in the direction of the arrow <A>, and remove the pinch roller (C1) x 1 pc. and (C2) x 1 pc., in the direction of the arrow <B>.

#### Note:

When installing the pinch roller, pay attention to the spring mounting position.

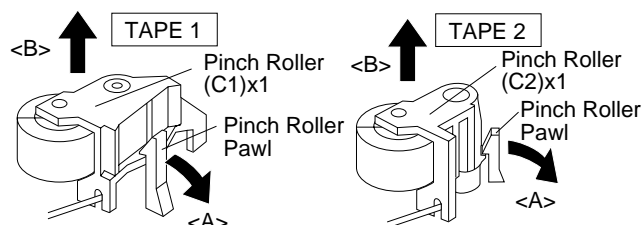

Figure 5-3

#### How to remove the motor (See Fig. 5-4)

1. Remove the belt.
2. Remove the screws (D1) x 4 pcs., to remove the motor bracket.
3. Remove the screws (D2) x 3 pcs., to remove the motor.

#### How to remove the belt (TAPE 1) (See Fig. 5-5)

1. Remove the main belt (E1) x 1 pc., from the motor side.
2. Remove the FF/REW belt (E2) x 1 pc.

#### How to remove the belt (TAPE 2) (See Fig. 5-5)

1. Remove the main belt (F1) x 1 pc., from the motor side.
2. Remove the FF/REW belt (F2) x 1 pc.

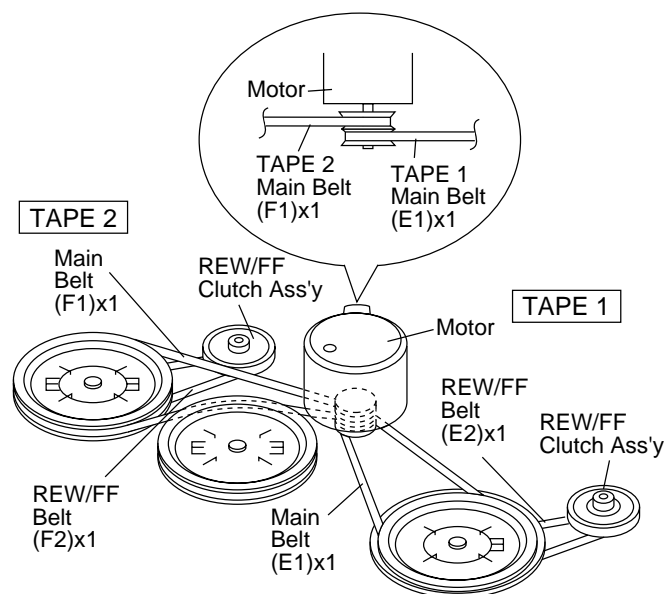

Figure 5-5

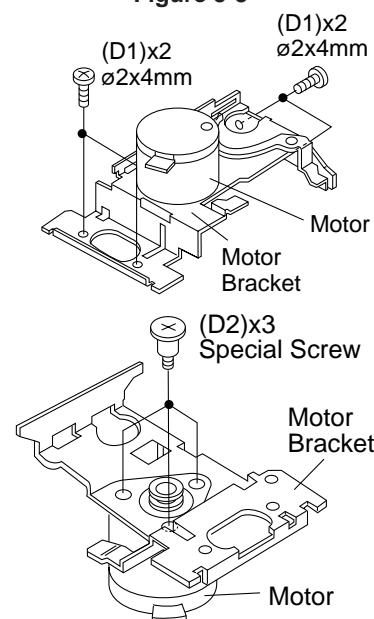

Figure 5-4

## ADJUSTMENT

### MECHANISM SECTION

#### • Driving Force Check

Torque Meter	Specified Value
Play: TW-2412	Tape 1: Over 60 g Tape 2: Over 50 g

#### • Torque Check

Torque Meter	Specified Value	
	Tape 1	Tape 2
Play: TW-2111	30 to 70 g.cm	27 to 60 g.cm
Fast Forward: TW-2231	Over 55 g.cm	55 to 120 g.cm
Rewind: TW-2231	Over 55 g.cm	55 to 120 g.cm

#### • Head Azimuth

Test Tape	Instrument Connection
MTT-114	Headphones Socket (Load resistance: 32 ohms)

#### • Tape Speed (Normal only)

Test Tape	Adjustment Point	Specified Value	Instrument Connection
MTT-111	Tape 1, Tape 2: VR501	3,000 ± 60 Hz	Headphones Socket (Load resistance: 32 ohms)

### DECK SECTION

#### • Bias Oscillation

Adjustment Point	Specified value	Instrument Connection
T201	100 kHz + 4 kHz	Pin 5 of CON202

#### • Beat Cancel Switch: A

	Specified Value
Beat Cancel	A: 100 ± 4 kHz B: 94 ± 4 kHz C: 104 ± 4 kHz

#### • Playback Amplifier Sensitivity Check

Test tape	Specified value	Instrument Connection
MTT-118	2.5 V ± 3 dB	Speaker terminal (Load resistance: 8 ohms)

### TUNER SECTION

fL: Low-range frequency  
fH: High-range frequency

#### • FM IF/RF

Test Stage	Specified Value/ Adjusting Point	Instrument Connection
FM IF	T108	Input: FM Antenna Output: Pin 9 of IC102
FM Detection	T106	
FM Band Coverage	fL: L101 fH: TC1	Input: Antenna Output: Headphones Socket (Load resistance: 32 ohms)
FM Tracking	fL (88.0 MHz): L102 fH (108 MHz): TC2	

#### • AM IF/RF

Test Stage	Specified Value/ Adjusting Point	Instrument Connection
AM IF	T107	Input: Antenna Output: Pin 9 of IC102
MW Band Coverage	fL: T103 fH: TC3	
MW Tracking	fL (600 kHz): L103 fH (1,400 kHz): TC4	Input: Antenna Output: Headphones Socket (Load resistance 32 ohms)
SW1 Band Coverage	fL (2.3 MHz): T104 fH (7.3 MHz): CT102	
SW1 Tracking	fL (2.6 MHz): T101 fH (6 MHz): CT104	
SW2 Band Coverage	fL (7.3 MHz): T105 fH (22 MHz): CT101	
SW2 Tracking	fL (8.5 MHz): T102 fH (19 MHz): CT103	

#### • VCO Frequency

Adjustment Point	Specified value	Instrument Connection
VR102	76 kHz ± 200 Hz	Pin 13, Pin 21 and ground of IC102

#### Note:

After preparing the test circuit shown in Fig. 6, connect the Pin 13, Pin 21 and ground of the IC102 with the test circuit, and measure the value.

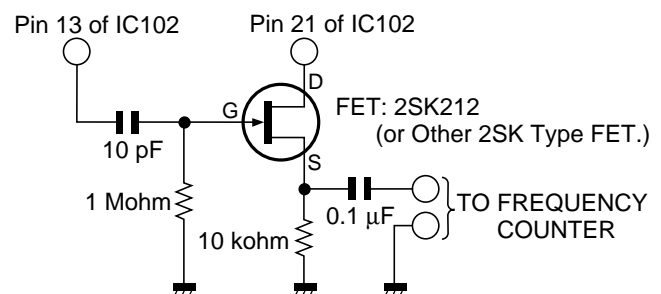

Figure 6 VCO FREQUENCY TEST CIRCUIT

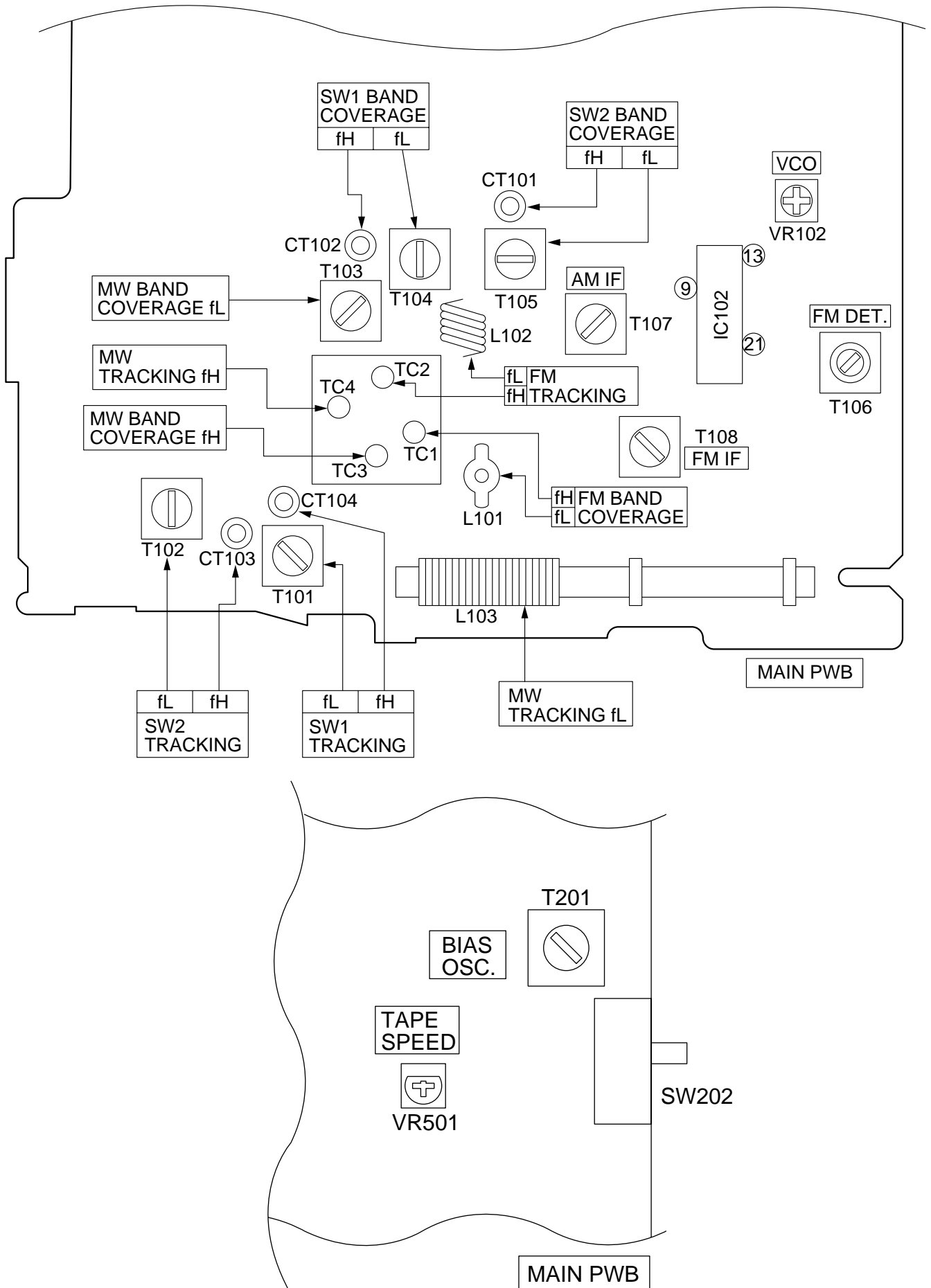

Figure 7 ADJUSTMENT POINTS

## FITTING OF DIAL POINTER

1. Remove the Main PWB, the Graphic Equalizer PWB and the Fine Tuning PWB. (See Figure 4-2 in the "Disassembly" on page 4.)
2. Remove the dial pointer guide and PWB.
3. Insert the dial pointer from (A), lead it under (B), hang it on the tuner gear and then pass it through (C).
4. Replace the Main PWB, the Graphic Equalizer PWB and the Fine Tuning PWB.
5. Rotate the tuning knob in the arrow direction until it stops. (Set the tuner variable capacitor to "0" point (F-LOW state).)
6. Adjust the dial pointer so that its stopper becomes the Figure 8-2 position. (Adjust the engagement of the pointer gear and the tuner gear to get the minimum space between the PWB and the stopper.) This position is the "0" point.
7. Screw up the PWB and the dial pointer guide.

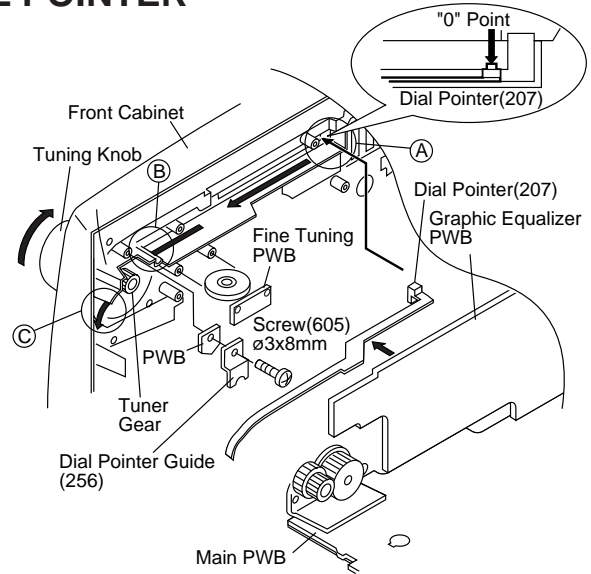

Figure 8-1

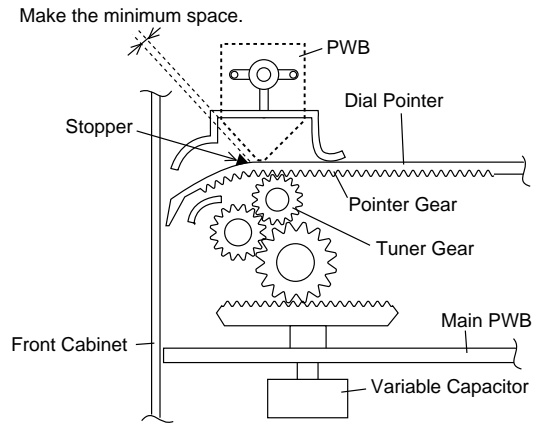

Figure 8-2

## NOTES ON SCHEMATIC DIAGRAM

- Resistor:  
To differentiate the units of resistors, The symbol as K and M are used: the symbol K means 1000 ohm and the symbol M means 1000 kohm and the resistor without any symbol is an ohm resistor. The resistor designated "Fusible" is a fuse type resistor.
- Capacitor:  
To indicate the unit of capacitor, a symbol P is used: this symbol P means pico-farad and the unit of the capacitor without such a symbol is microfarad. As to electrolytic capacitor, the expression "capacitance/withstand voltage" is used.  
(CH),(RH),(UJ): Temperature compensation  
(ML): Mylar type  
(S): Styrol type
- The indicated voltage in each section is the one measured by Digital Multimeter between such a section and the chassis with no signal given.
- Schematic diagram and Wiring Side of P.W. Board for this model are subject to change for improvement without prior notice.
- Parts marked with "⚠" ( [ ] ) are important for maintaining the safety of the set. Be sure to replace these parts with specified ones for maintaining the safety and performance of the set.

REF. NO.	DESCRIPTION	POSITION
SW1	TAPE 2 DIRECTION	A—B
SW2	TAPE 1 PLAY	ON—OFF
SW3	TAPE 1 FF/REW	ON—OFF
SW4	TAPE 1 REC	ON—OFF
SW5	TAPE 2 PLAY	ON—OFF
SW6	TAPE 2 FF/REW	ON—OFF
SW101	BAND SELECTOR	SW2—SW1—MW—FM
SW202	BEAT CANCEL	A—B
SW203	DUBBING SPEED/MIC/ FM MODE	HIGH—NORMAL—MIC/ FM STEREO—FM MONO
SW401	SURROUND	ON—OFF
SW501	FUNCTION SELECTOR/ POWER	CD/LINE—RADIO— TAPE/STAND-BY—ON
SW601	VOLTAGE SELECTOR	110-127 V—220-240 V



## TYPES OF TRANSISTOR AND LED

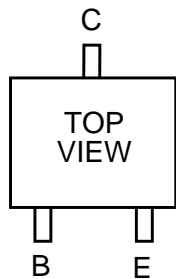

2SC2412 KR  
KTC3875 GR

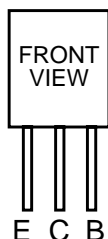

2SC945 AP  
3DA8050  
SS8550  
SS8050

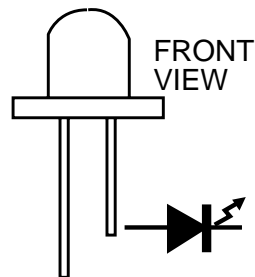

L01-224HD

## VOLTAGE

IC101	
PIN NO.	VOLTAGE
1	0.98 V
2	1.7 V
3	6.12 V
4	0 V
5	0 V
6	6.15 V
7	1.6 V
8	5.46 V
9	6.1 V

IC201	
PIN NO.	VOLTAGE
1	0 V
2	0 V
3	1.28 V
4	1.28 V
5	1.37 V
6	1.32 V
7	0 V
8	0 V
9	1.83 V
10	1.28 V
11	0 V
12	0 V
13	0.85 V
14	0 V
15	1.28 V
16	1.83 V
17	1.45 V
18	6.6 V
19	4.6 V
20	1.37 V
21	1.28 V
22	1.28 V
23	0 V
24	0 V

IC301	
PIN NO.	VOLTAGE
1	5.5 V
2	5.5 V
3	6.1 V
4	6.1 V
5	5.5 V
6	5.5 V
7	6.1 V
8	6.1 V
9	5.5 V
10	5.5 V
11	6.1 V
12	6.1 V
13	5.5 V
14	5.5 V
15	6.1 V
16	6.1 V
17	4.1 V
18	2.4 V
19	2.4 V
20	4.1 V
21	3 V
22	3 V
23	6.5 V
24	0 V

IC402	
PIN NO.	VOLTAGE
1	14.4 V
2	0 V
3	0 V
4	0 V
5	4.53 V
6	0 V
7	15 V
8	15 V
9	6.86 V
10	0 V
11	6.86 V
12	6.85 V
13	0 V
14	6.85 V

IC403	
PIN NO.	VOLTAGE
1	15 V
2	0 V
3	7.99 V

IC404	
PIN NO.	VOLTAGE
1	15 V
2	0 V
3	8.99 V

Q301	
PIN NO.	VOLTAGE
B	0 V
C	0 V
E	0 V

Q302	
PIN NO.	VOLTAGE
B	0 V
C	0 V
E	0 V

Q201	
PIN NO.	VOLTAGE
B	0.7 V
C	0 V
E	0 V

Q202	
PIN NO.	VOLTAGE
B	0.7 V
C	0 V
E	0 V

Q203	
PIN NO.	VOLTAGE
B	0.7 V
C	0 V
E	0 V

Q204	
PIN NO.	VOLTAGE
B	0.7 V
C	0 V
E	0 V

Q205	
PIN NO.	VOLTAGE
B	0.6 V
C	4.3 V
E	0.2 V

Q206	
PIN NO.	VOLTAGE
B	0.7 V
C	0 V
E	0 V

Q207	
PIN NO.	VOLTAGE
B	7.2 V
C	8 V
E	8 V

Q208	
PIN NO.	VOLTAGE
B	0 V
C	0 V
E	0 V

Q209	
PIN NO.	VOLTAGE
B	0.93 V
C	2.25 V
E	0.31 V

Q210	
PIN NO.	VOLTAGE
B	0.93 V
C	2.25 V
E	0.31 V

Q212	
PIN NO.	VOLTAGE
B	0.7 V
C	0 V
E	0 V

Q213	
PIN NO.	VOLTAGE
B	5 V
C	4.3 V
E	5 V

Q218	
PIN NO.	VOLTAGE
B	0.7 V
C	0 V
E	0 V

Q219	
PIN NO.	VOLTAGE
B	0.7 V
C	0 V
E	0 V

Q220	
PIN NO.	VOLTAGE
B	0.7 V
C	0 V
E	0 V

Q221	
PIN NO.	VOLTAGE
B	0.7 V
C	0 V
E	0 V

Q504	
PIN NO.	VOLTAGE
B	8 V
C	7.5 V
E	5.85 V

Q505	
PIN NO.	VOLTAGE
B	0 V
C	7.42 V
E	0 V

Q506	
PIN NO.	VOLTAGE
B	0.69 V
C	0 V
E	0 V

IC102	
PIN NO.	VOLTAGE
1	1.59 V
2	1.6 V
3	6.15 V
4	0.19 V
5	1.6 V
6	0 V
7	6.4 V
8	0 V
9	2.3 V
10	2.3 V
11	5.4 V
12	0.9 V
13	1.1 V
14	2.1 V
15	1 V
16	1.7 V
17	1.56 V
18	1.58 V
19	0.43 V
20	6.1 V
21	6.1 V
22	0.53 V
23	1.6 V
24	1.41 V

IC202	
PIN NO.	VOLTAGE
1	6.3 V
2	1.6 V
3	1.6 V
4	0 V
5	3.4 V
6	3.45 V
7	3.5 V
8	6.8 V

IC401	
PIN NO.	VOLTAGE
1	3.58 V
2	3.58 V
3	3.58 V
4	0 V
5	3.58 V
6	3.58 V
7	3.58 V
8	7.1 V

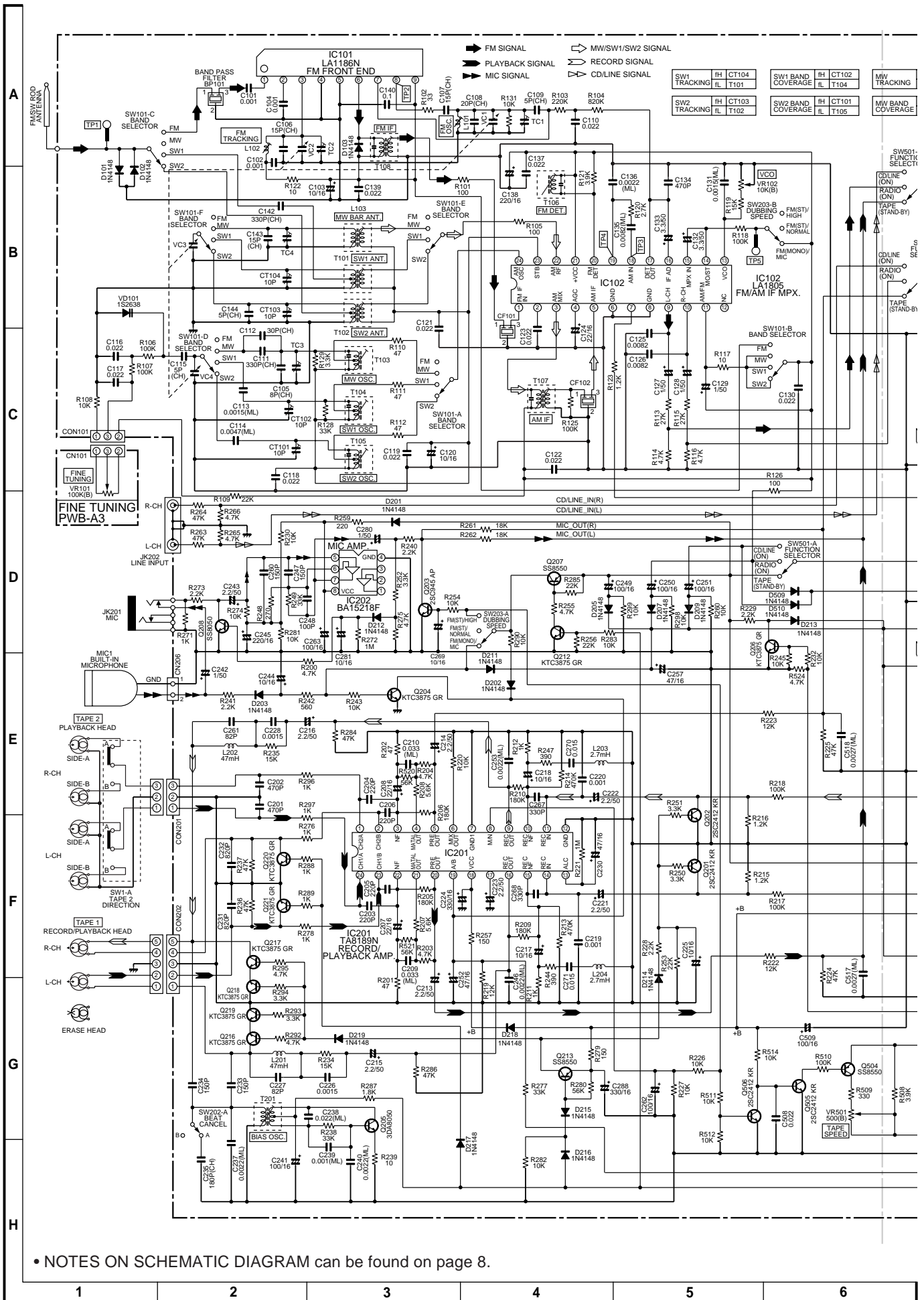
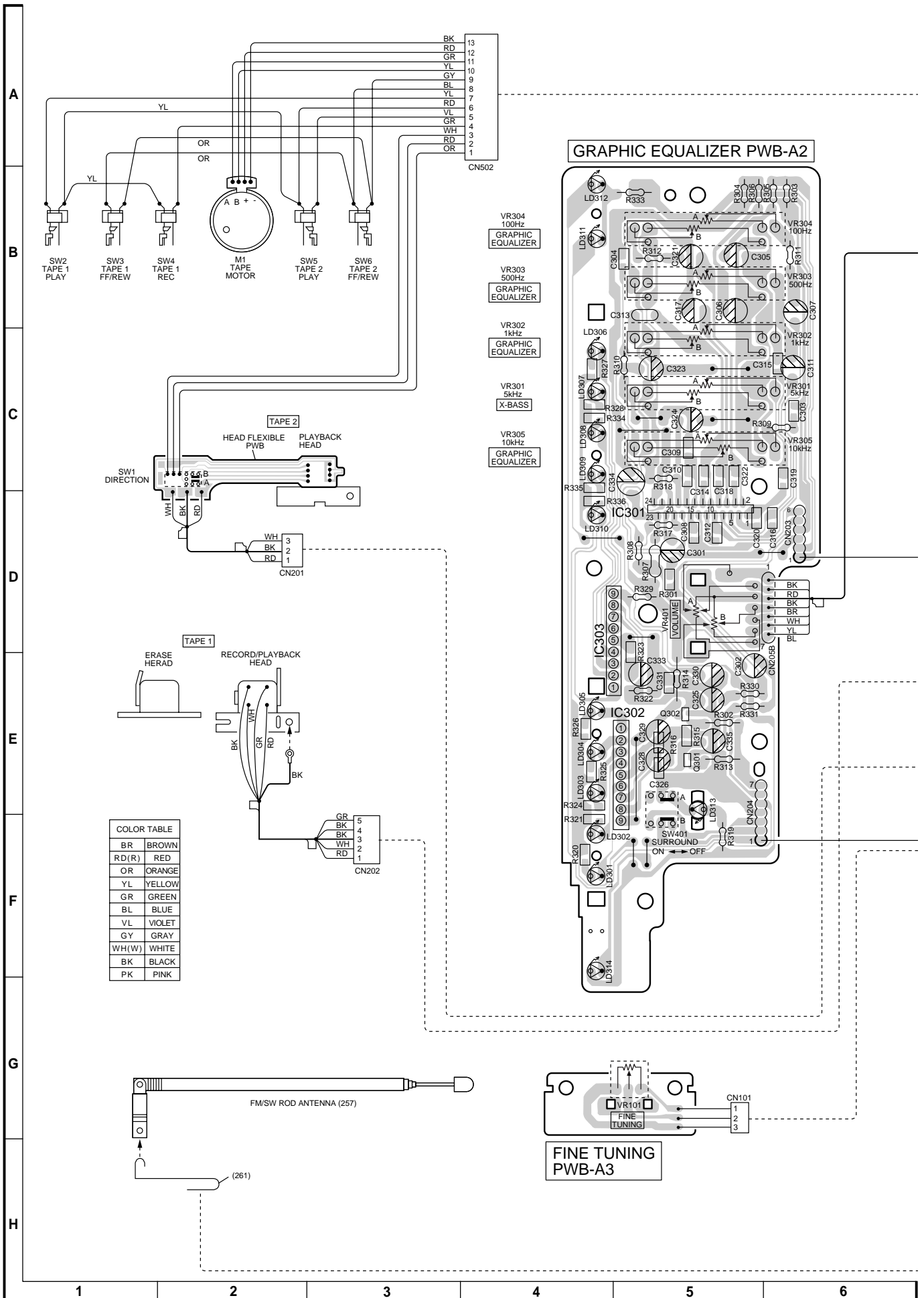

Figure 10 SCHEMATIC DIAGRAM (1/2)





COLOR TABLE

BR	BROWN
RD(R)	RED
OR	ORANGE
YL	YELLOW
GR	GREEN
BL	BLUE
VL	VIOLET
GY	GRAY
WH(W)	WHITE
BK	BLACK
PK	PINK

Figure 12 WIRING SIDE OF P.W.BOARD (1/3)

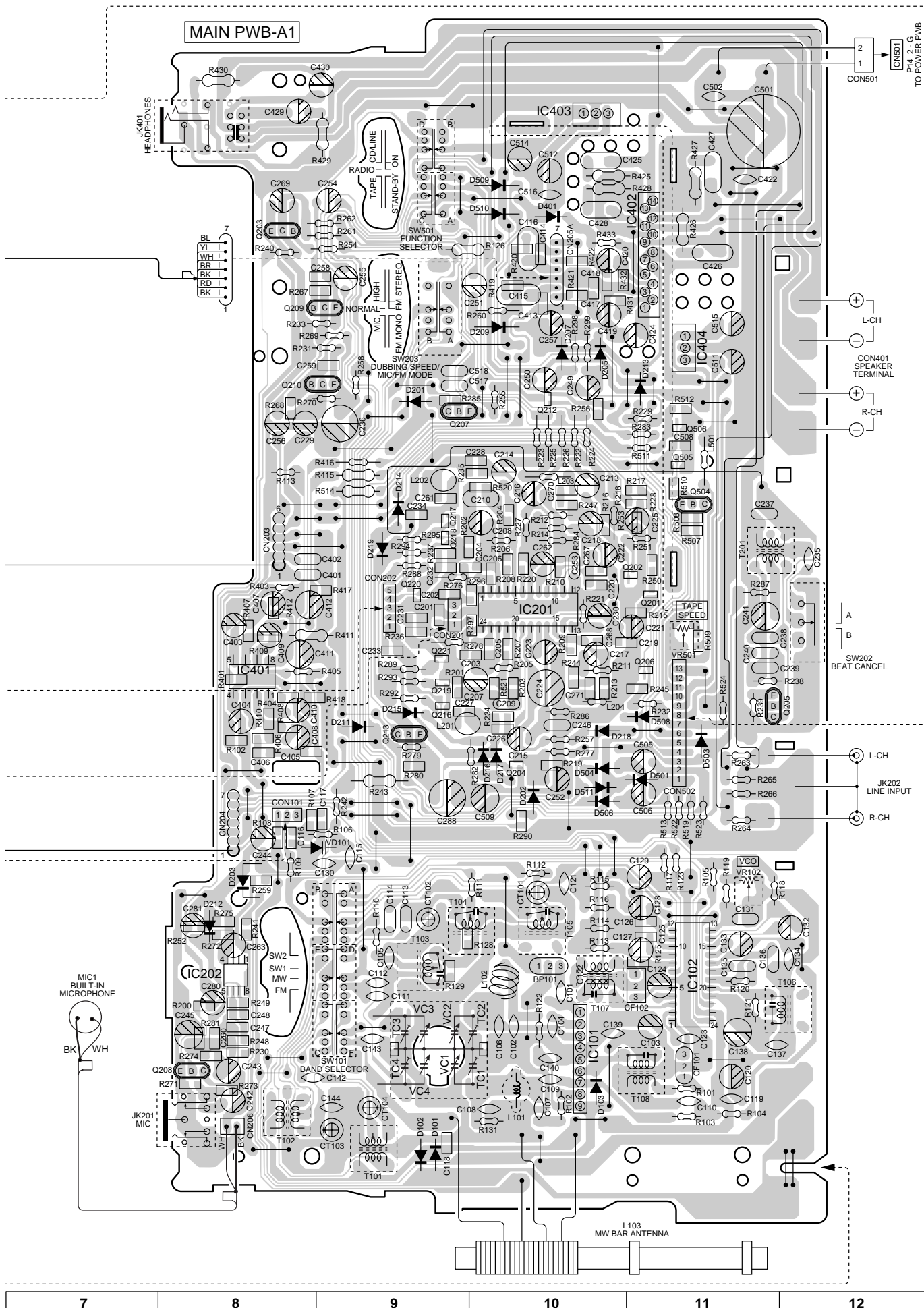

Figure 13 WIRING SIDE OF P.W.BOARD (2/3)

# WF-2100W

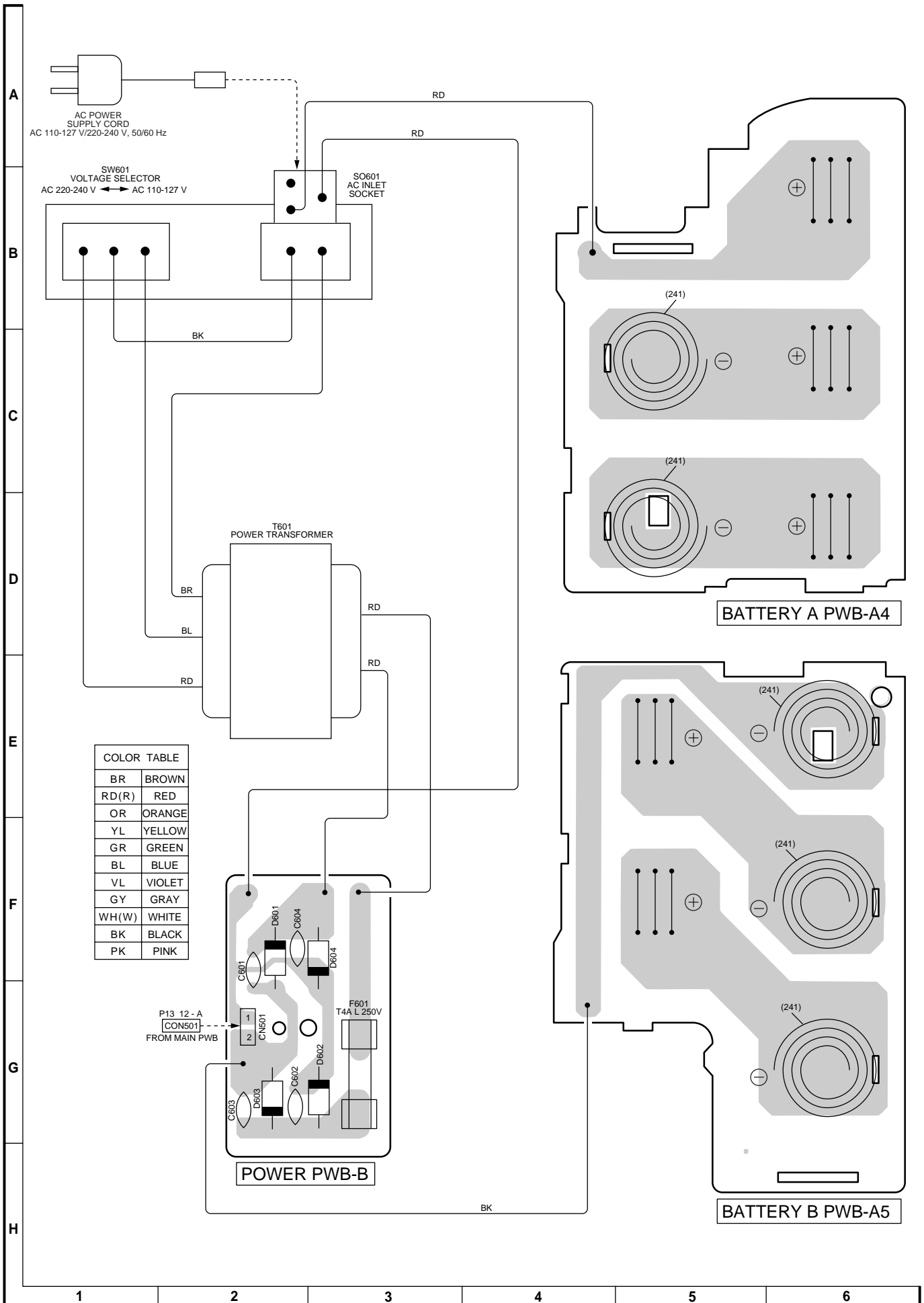

Figure 14 WIRING SIDE OF P.W.BOARD (3/3)

# SHARP PARTS GUIDE

PORTABLE STEREO COMPONENT SYSTEM

**MODEL WF-2100W(S)**

PORTABLE STEREO COMPONENT SYSTEM

**MODEL WF-2100W(BK)**

## “HOW TO ORDER REPLACEMENT PARTS”

To have your order filled promptly and correctly, please furnish the following information.

- |                 |                |
|-----------------|----------------|
| 1. MODEL NUMBER | 2. REF. No.    |
| 3. PART NO.     | 4. DESCRIPTION |

★ MARK: SPARE PARTS-DELIVERY SECTION

### For U.S.A. only

Contact your nearest SHARP Parts Distributor to order.

For location of SHARP Parts Distributor,  
Please call Toll-Free;  
1-800-BE-SHARP

## Explanation of capacitors/resistors parts codes

### Capacitors

VCC ..... Ceramic type  
 VCK ..... Ceramic type  
 VCT ..... Semiconductor type  
 VC •• MF ..... Cylindrical type (without lead wire)  
 VC •• MN ..... Cylindrical type (without lead wire)  
 VC •• TV ..... Square type (without lead wire)  
 VC •• TQ ..... Square type (without lead wire)  
 VC •• CY ..... Square type (without lead wire)  
 VC •• CZ ..... Square type (without lead wire)  
 VC •••••••• J .. The 13th character represents capacity difference.  
 ("J" ±5%, "K" ±10%, "M" ±20%, "N" ±30%,  
 "C" ±0.25 pF, "D" ±0.5 pF, "Z" +80-20%.)

If there are no indications for the electrolytic capacitors, error is ±20%.

### Resistors

VRD ..... Carbon-film type  
 VRS ..... Carbon-film type  
 VRN ..... Metal-film type  
 VR •• MF ..... Cylindrical type (without lead wire)  
 VR •• MN ..... Cylindrical type (without lead wire)  
 VR •• TV ..... Square type (without lead wire)  
 VR •• TQ ..... Square type (without lead wire)  
 VR •• CY ..... Square type (without lead wire)  
 VR •• CZ ..... Square type (without lead wire)  
 VR •••••••• J .. The 13th character represents error.  
 ("J" ±5%, "F" ±1%, "D" ±0.5%.)

If there are no indications for other parts, the resistors are ±5% carbon-film type.

### NOTE:

Parts marked with “” are important for maintaining the safety of the set.  
 Be sure to replace parts with specified ones for maintaining the safety and performance of the set.

# WF-2100W

NO.	PART CODE	★	PRICE RANK	DESCRIPTION
<b>INTEGRATED CIRCUITS</b>				
IC101	VHILA1186N/-1	J	AE	FM Front End,LA1186N
IC102	VHILA1805/-1	J	AM	FM/AM IF MPX.,LA1805
IC201	VHITA8189N/-1	J	AM	Record/Playback Amp.,TA8189N
IC202	92L2351-177001	J		Mic Amp.,BA15218F
IC301	92L2301-370001	J		Graphic Equalizer,BA3822LS
IC302,303	VHILB1403N/-1	J	AG	Meter Driver,LB1403N
IC401	VHIIKA4558P-1	J	AC	Ope Amp.,KIA4558P
IC402	VHILA4663/-1	J	AQ	Power Amp.,LA4663
IC403	92L2301-240001	J		Voltage Regulator,L7808CV
IC404	92L2301-237003	J		Voltage Regulator,L7809CV

## TRANSISTORS

Q201,202	92L2123-009001	J		Silicon,NPN,2SC2412 KR
Q203	VS2SC945AP/-1	J	AB	Silicon,NPN,2SC945 AP
Q204	VSKTC3875GR-1	J	AB	Silicon,NPN,KTC3875 GR
Q205	92L2103-109001	J	AC	Silicon,NPN,3DA8050
Q206	VSKTC3875GR-1	J	AB	Silicon,NPN,KTC3875 GR
Q207	92L2101-025001	J	AC	Silicon,PNP,SS8550
Q208	92L2103-054003	J		Silicon,NPN,SS8050
Q209,210	VS2SC945AP/-1	J	AB	Silicon,NPN,2SC945 AP
Q212	VSKTC3875GR-1	J	AB	Silicon,NPN,KTC3875 GR
Q213	92L2101-025001	J	AC	Silicon,PNP,SS8550
Q216-221	VSKTC3875GR-1	J	AB	Silicon,NPN,KTC3875 GR
Q301,302	92L2123-017001	J		Silicon,NPN,KTC3875 GR
Q504	92L2101-025001	J	AC	Silicon,PNP,SS8550
Q505,506	92L2123-009001	J		Silicon,NPN,2SC2412 KR

## DIODES

D101-103	VHD1N4148/-1	J	AA	Silicon,1N4148
D201-203	VHD1N4148/-1	J	AA	Silicon,1N4148
D205	VHD1N4148/-1	J	AA	Silicon,1N4148
D207	VHD1N4148/-1	J	AA	Silicon,1N4148
D209	VHD1N4148/-1	J	AA	Silicon,1N4148
D211-219	VHD1N4148/-1	J	AA	Silicon,1N4148
D401	VHD1N4148/-1	J	AA	Silicon,1N4148
D501	VHD1N4148/-1	J	AA	Silicon,1N4148
D503,504	VHD1N4148/-1	J	AA	Silicon,1N4148
D506	VHD1N4148/-1	J	AA	Silicon,1N4148
D508-511	VHD1N4148/-1	J	AA	Silicon,1N4148
D601-604	92L2501-089001	J		Silicon,1N5402
LD301-312	92L2509-067001	J		LED,Red,L01-224HD
LD313	92L2509-080001	J		LED,Green,
LD314	92L2509-067001	J		LED,Red,L01-224HD

## FILTERS

BP101	92L4401-008001	J	AG	Band Pass Filter
CF101	92L4403-060001	J		FM IF
CF102	92L4403-061002	J		AM IF

## TRANSFORMERS

T101	92L1111-025001	J	AE	SW1 Antenna
T102	92L1104-114001	J		SW2 Antenna
T103	92L1104-099001	J		MW OSC.
T104	92L1104-090001	J	AD	SW1 OSC.
T105	92L1104-089001	J	AD	SW2 OSC.
T106	92L1104-100001	J		FM Detection
T107	92L1104-097001	J		AM IF
T108	92L1104-038001	J	AE	FM IF
T201	92L1104-105008	J		Bias OSC.
△ T601	92L5102-126001	J		Power

## COILS

L101	92L1104-098001	J		FM OSC.
L102	92L1107-009001	J	AB	FM Tracking
L103	92L7602-006001	J		MW Bar Antenna
L201,202	92L1101-161001	J		47 mH
L203,204	92L1101-150038	J		2.7 mH
L501	92L1101-003017	J		47 μH

## VARIABLE RESISTORS

VR101	92L1701-060001	J		100 kohm (B),Semi-VR [Fine Tuning]
VR102	92L1601-001001	J	AD	10 kohm (B),Semi-VR [VCO]
VR301	92L1702-008004	J		50 kohms (B)×2,Semi-VR [X-Bass]
VR302	92L1702-008003	J		100 kohm (B)×2,Semi-VR [Graphic Equalizer]
VR303	92L1702-008002	J		100 kohm (B)×2,Semi-VR [Graphic Equalizer]
VR304	92L1702-008001	J		50 kohms (B)×2,Semi-VR [Graphic Equalizer]
VR305	92L1702-008005	J		100 kohm (B)×2,Semi-VR [Graphic Equalizer]
VR401	92L1701-059002	J		50 kohms (B)×2,Semi-VR [Volume]
VR501	92L1601-001007	J		500 ohms (B),Semi-VR [Tape Speed]

## VARIABLE CAPACITORS

CT101-104	92L1341-007001	J	AE	Trimmer,10 pF
VC1-4	92L1340-003001	J	AQ	Variable Capacitor with Trimmer (TC1-4)
VD101	92L2507-001001	J	AD	Variable Capacitance,1S2638

## CAPACITORS

C101,102	VCKYPA1HB102K	J	AA	0.001 μF,50V
C103	VCEAZA1CW106M	J	AC	10 μF,16V,Electrolytic
C104	VCKYPA1HB102K	J	AA	0.001 μF,50V
C105	VCCCPU1HH8R0C	J	AA	8 pF (CH),50V
C106,107	VCCCPU1HH150J	J	AA	15 pF (CH),50V
C108	VCCCPU1HH200J	J	AA	20 pF (CH),50V
C109	VCCCPU1HH5R0C	J	AA	5 pF (CH),50V
C110	VCKZPA1HF223Z	J	AA	0.022 μF,50V
C111	92L1321-001095	J		330 pF (CH),50V
C112	VCCCPU1HH300J	J	AA	30 pF (CH),50V
C113	VCQYKA1HM152K	J	AB	0.0015 μF,50V,Mylar
C114	VCQYKA1HM472J	J	AA	0.0047 μF,50V,Mylar
C115	VCCCPU1HH5R0C	J	AA	5 pF (CH),50V
C116-118	VCKYTV1EF223Z	J	AA	0.022 μF,25V
C119	VCKZPA1HF223Z	J	AA	0.022 μF,50V
C120	VCEAZA1CW106M	J	AC	10 μF,16V,Electrolytic
C121	VCKZPA1HF223Z	J	AA	0.022 μF,50V
C122	VCKYTV1EF223Z	J	AA	0.022 μF,25V
C123	VCKZPA1HF223Z	J	AA	0.022 μF,50V
C124	VCEAZA1CW226M	J	AC	22 μF,16V,Electrolytic
C125,126	VCKYTV1HB822K	J	AA	0.0082 μF,50V
C127-129	VCEAZA1HW105M	J	AB	1 μF,50V,Electrolytic
C130	VCKZPA1HF223Z	J	AA	0.022 μF,50V
C131	VCQYKA1HM152K	J	AB	0.0015 μF,50V,Mylar
C132,133	VCEAZA1HW335M	J	AB	3.3 μF,50V,Electrolytic
C134	VCCSPU1HL471J	J	AB	470 pF,50V
C135	VCQYKA1HM822K	J	AA	0.0082 μF,50V,Mylar
C136	VCQYKA1HM222K	J	AA	0.0022 μF,50V,Mylar
C137	VCKZPA1HF223Z	J	AA	0.022 μF,50V
C138	VCEAZA1CW227M	J	AC	220 μF,16V,Electrolytic
C139	VCKZPA1HF223Z	J	AA	0.022 μF,50V
C140	VCTYPA1EF104Z	J	AA	0.1 μF,25V
C142	92L1321-001095	J		330 pF (CH),50V
C143	VCCCPU1HH150J	J	AA	15 pF (CH),50V
C144	VCCCPU1HH5R0C	J	AA	5 pF (CH),50V
C201,202	VCKYTV1HB471K	J	AA	470 pF,50V
C203-206	VCKYTV1HB221K	J	AA	220 pF,50V
C207,208	VCEAZA1CW226M	J	AC	22 μF,16V,Electrolytic
C209,210	VCQYKA1HM333J	J	AB	0.033 μF,50V,Mylar
C213-216	VCEAZA1HW225M	J	AB	2.2 μF,50V,Electrolytic
C217,218	VCEAZA1CW106M	J	AC	10 μF,16V,Electrolytic
C219,220	VCKYTV1HB102K	J	AA	0.001 μF,50V
C221-223	VCEAZA1HW225M	J	AB	2.2 μF,50V,Electrolytic
C224	VCEAZA1CW337M	J	AC	330 μF,16V,Electrolytic
C225	VCEAZA1CW106M	J	AC	10 μF,16V,Electrolytic
C226	VCKYTV1HB152K	J	AA	0.0015 μF,50V
C227	92L1323-014021	J		82 pF,50V
C228	VCKYTV1HB152K	J	AA	0.0015 μF,50V
C229	VCEAZA1HW225M	J	AB	2.2 μF,50V,Electrolytic
C230	VCEAZA1CW476M	J	AB	47 μF,16V,Electrolytic
C231,232	VCKYTV1HB821K	J	AA	820 pF,50V



NO.	PART CODE	★ PRICE RANK	DESCRIPTION
C233,234	VCKYTV1HB151K	J AC	150 pF,50V
C235	VCCCPU1HH181J	J AA	180 pF (CH),50V
C236	VCEAZA1CW227M	J AC	220 μF,16V,Electrolytic
C237	VCQYKA1HM222K	J AA	0.0022 μF,50V,Mylar
C238	VCQYKA1HM223K	J AB	0.022 μF,50V,Mylar
C239	VCQYKA1HM102K	J AA	0.001 μF,50V,Mylar
C240	VCQYKA1HM222K	J AA	0.0022 μF,50V,Mylar
C241	VCEAZA1CW107M	J AC	100 μF,16V,Electrolytic
C242	VCEAZA1HW105M	J AB	1 μF,50V,Electrolytic
C243	VCEAZA1HW225M	J AB	2.2 μF,50V,Electrolytic
C244	VCEAZA1CW106M	J AC	10 μF,16V,Electrolytic
C245	VCEAZA1CW227M	J AC	220 μF,16V,Electrolytic
C246	VCQYKA1HM222K	J AA	0.0022 μF,50V,Mylar
C247	VCKYTV1HB151K	J AC	150 pF,50V
C248	VCKYTV1HB101K	J AA	100 pF,50V
C249-251	VCEAZA1CW107M	J AC	100 μF,16V,Electrolytic
C252	VCEAZA1CW476M	J AB	47 μF,16V,Electrolytic
C253	VCQYKA1HM222K	J AA	0.0022 μF,50V,Mylar
C254-256	VCEAZA1HW225M	J AB	2.2 μF,50V,Electrolytic
C257	VCEAZA1CW476M	J AB	47 μF,16V,Electrolytic
C258,259	VCKYTV1HB221K	J AA	220 pF,50V
C260	VCKYTV1HB151K	J AC	150 pF,50V
C261	92L1323-014021	J	82 pF,50V
C262,263	VCEAZA1CW107M	J AC	100 μF,16V,Electrolytic
C267,268	VCCSTV1HL331J	J AA	330 pF,50V
C269	VCEAZA1CW106M	J AC	10 μF,16V,Electrolytic
C270,271	VCKYTV1HB153K	J AA	0.015 μF,50V
C280	VCEAZA1HW105M	J AB	1 μF,50V,Electrolytic
C281	VCEAZA1CW106M	J AC	10 μF,16V,Electrolytic
C288	VCEAZA1CW337M	J AC	330 μF,16V,Electrolytic
C301,302	RC-EZD225AF1H	J AB	2.2 μF,50V,Electrolytic
C303,304	VCKYTV1HF223Z	J AA	0.022 μF,50V
C305-307	RC-EZD105AF1H	J AB	1 μF,50V,Electrolytic
C308	VCKYTV1HF223Z	J AA	0.022 μF,50V
C309	VCKYTV1HB183K	J AA	0.018 μF,50V
C310	VCCCTV1HH821J	J AA	820 pF (CH),50V
C311	RC-EZD334AF1H	J AB	0.33 μF,50V,Electrolytic
C312	VCKYTV1HB562K	J AA	0.0056 μF,50V
C313	VCQYKA1HM104K	J AB	0.1 μF,50V,Mylar
C314	VCKYTV1HB332K	J AA	0.0033 μF,50V
C315	VCKYTV1HF104Z	J AA	0.1 μF,50V
C316	VCKYTV1HB332K	J AA	0.0033 μF,50V
C317	RC-EZD334AF1H	J AB	0.33 μF,50V,Electrolytic
C318	VCKYTV1HB562K	J AA	0.0056 μF,50V
C319	VCKYTV1HB183K	J AA	0.018 μF,50V
C320	VCCCTV1HH821J	J AA	820 pF (CH),50V
C321	RC-EZD105AF1H	J AB	1 μF,50V,Electrolytic
C322	VCKYTV1HF223Z	J AA	0.022 μF,50V
C323,324	RC-EZY475AF1H	J AB	4.7 μF,50V,Electrolytic
C325	RC-EZD105AF1H	J AB	1 μF,50V,Electrolytic
C326	VCKYTV1HB102K	J AA	0.001 μF,50V
C328-330	RC-EZD106AF1C	J AB	10 μF,16V,Electrolytic
C331	VCKYTV1HB102K	J AA	0.001 μF,50V
C333	RC-EZD106AF1C	J AB	10 μF,16V,Electrolytic
C334	RC-GZA227AF1C	J AB	220 μF,16V,Electrolytic
C335	RC-EZD105AF1H	J AB	1 μF,50V,Electrolytic
C401,402	VCQYKA1HM153K	J AB	0.015 μF,50V,Mylar
C403,404	VCEAZA1HW225M	J AB	2.2 μF,50V,Electrolytic
C405,406	VCKYTV1HB332K	J AA	0.0033 μF,50V
C407,408	VCEAZA1HW475M	J AB	4.7 μF,50V,Electrolytic
C409,410	VCEAZA1HW225M	J AB	2.2 μF,50V,Electrolytic
C411	VCEAZA1CW107M	J AC	100 μF,16V,Electrolytic
C412	VCEAZA1CW476M	J AB	47 μF,16V,Electrolytic
C413,414	VCKYTV1HB102K	J AA	0.001 μF,50V
C415,416	VCQYKA1HM154K	J AB	0.15 μF,50V,Mylar
C417,418	VCKYTV1HB102K	J AA	0.001 μF,50V
C419,420	VCEAZA1HW225M	J AB	2.2 μF,50V,Electrolytic
C422	VCKZPA1HF223Z	J AA	0.022 μF,50V
C424	VCEAZA1EW476M	J AB	47 μF,25V,Electrolytic
C425-428	VCQYKA1HM104K	J AB	0.1 μF,50V,Mylar
C429,430	VCEAZA1CW106M	J AC	10 μF,16V,Electrolytic
C501	VCEAZA1HW336M	J AC	33 μF,50V,Electrolytic
C502	VCTYPA1EF104Z	J AA	0.1 μF,25V
C505,506	VCEAZA1CW476M	J AB	47 μF,16V,Electrolytic
C508	VCKYTV1EF223Z	J AA	0.022 μF,25V
C509	VCEAZA1CW107M	J AC	100 μF,16V,Electrolytic
C511,512	VCEAZA1CW476M	J AB	47 μF,16V,Electrolytic
C514,515	VCEAZA1HW105M	J AB	1 μF,50V,Electrolytic
C516	VCTYPA1EF104Z	J AA	0.1 μF,25V
C517,518	VCQYKA1HM272K	J AA	0.0027 μF,50V,Mylar
C601-604	VCKZPA1HF223Z	J AA	0.022 μF,50V

## RESISTORS

NO.	PARTS CODE	★ PRICE RANK	DESCRIPTION
R101	VRD-ST2CD101J	J AA	100 ohm,1/6W
R102	VRD-ST2CD330J	J AA	33 ohms,1/6W
R103	VRD-ST2CD224J	J AA	220 kohms,1/6W
R104	VRD-ST2CD824J	J AA	820 kohms,1/6W
R105	VRD-ST2CD101J	J AA	100 ohm,1/6W
R106	VRD-ST2CD104J	J AA	100 kohm,1/6W
R107	VRS-TV2AB104J	J AA	100 kohm,1/10W
R108	VRS-TV2AB103J	J AA	10 kohm,1/10W
R109	VRD-ST2CD223J	J AA	22 kohms,1/6W
R110-112	VRD-ST2CD470J	J AA	47 ohms,1/6W
R113	VRD-ST2CD273J	J AA	27 kohms,1/6W
R114	VRD-ST2CD472J	J AA	4.7 kohms,1/6W
R115	VRD-ST2CD273J	J AA	27 kohms,1/6W
R116	VRD-ST2CD472J	J AA	4.7 kohms,1/6W
R117	VRD-ST2CD100J	J AA	10 ohm,1/6W
R118	VRD-ST2CD104J	J AA	100 kohm,1/6W
R119	VRD-ST2CD153J	J AA	15 kohms,1/6W
R120	VRD-ST2CD272J	J AA	2.7 kohms,1/6W
R121	VRD-ST2CD392J	J AA	3.9 kohms,1/6W
R122	VRD-ST2CD100J	J AA	10 ohm,1/6W
R123	VRD-ST2CD122J	J AA	1.2 kohms,1/6W
R125	VRS-TV2AB104J	J AA	100 kohm,1/10W
R126	VRD-ST2EE101J	J AA	100 ohm,1/4W
R128	VRS-TV2AB333J	J AA	33 kohms,1/10W
R129	VRS-TV2AB332J	J AA	3.3 kohms,1/10W
R131	VRD-ST2CD103J	J AA	10 kohm,1/6W
R200	VRS-TV2AB472J	J AA	4.7 kohms,1/10W
R201,202	VRS-TV2AB470J	J AA	47 ohms,1/10W
R203,204	VRS-TV2AB472J	J AA	4.7 kohms,1/10W
R205,206	VRD-ST2CD184J	J AA	180 kohms,1/6W
R207,208	VRS-TV2AB562J	J AA	5.6 kohms,1/10W
R209,210	VRS-TV2AB184J	J AA	180 kohms,1/10W
R211,212	VRD-ST2CD102J	J AA	1 kohm,1/6W
R213	VRS-TV2AB474J	J AA	470 kohms,1/10W
R214	VRD-ST2CD474J	J AA	470 kohms,1/6W
R215,216	VRS-TV2AB122J	J AA	1.2 kohms,1/10W
R217	VRS-TV2AB104J	J AA	100 kohm,1/10W
R218	VRD-ST2CD104J	J AA	100 kohm,1/6W
R219	VRS-TV2AB123J	J AA	12 kohms,1/10W
R220	VRS-TV2AB103J	J AA	10 kohm,1/10W
R221	VRD-ST2CD105J	J AA	1 Mohm,1/6W
R222,223	VRD-ST2CD123J	J AA	12 kohms,1/6W
R224,225	VRD-ST2CD473J	J AA	47 kohms,1/6W
R226,227	VRD-ST2CD103J	J AA	10 kohm,1/6W
R228	VRS-TV2AB222J	J AA	2.2 kohms,1/10W
R229	VRD-ST2CD222J	J AA	2.2 kohms,1/6W
R230	VRS-TV2AB103J	J AA	10 kohm,1/10W
R231	VRD-ST2CD271J	J AA	270 ohms,1/6W
R232	VRD-ST2CD103J	J AA	10 kohm,1/6W
R233	VRD-ST2CD271J	J AA	270 ohms,1/6W
R234,235	VRS-TV2AB153J	J AA	15 kohms,1/10W
R236,237	VRS-TV2AB473J	J AA	47 kohms,1/10W
R238	VRD-ST2CD333J	J AA	33 kohms,1/6W
R239	VRD-ST2CD100J	J AA	10 ohm,1/6W
R240	VRD-ST2CD222J	J AA	2.2 kohms,1/6W
R241	VRS-TV2AB222J	J AA	2.2 kohms,1/10W
R242	VRS-TV2AB561J	J AA	560 ohms,1/10W
R243	VRD-ST2CD103J	J AA	10 kohm,1/6W
R244	VRS-TV2AB391J	J AA	390 ohms,1/10W
R245	VRS-TV2AB103J	J AA	10 kohm,1/10W
R247	VRS-TV2AB391J	J AA	390 ohms,1/10W
R248	VRS-TV2AB271J	J AA	270 ohms,1/10W
R249	VRS-TV2AB333J	J AA	33 kohms,1/10W
R250	VRS-TV2AB332J	J AA	3.3 kohms,1/10W
R251	VRD-ST2CD332J	J AA	3.3 kohms,1/6W
R252	VRS-TV2AB332J	J AA	3.3 kohms,1/10W
R253	VRS-TV2AB223J	J AA	22 kohms,1/10W
R254	VRD-ST2CD103J	J AA	10 kohm,1/6W
R255	VRD-ST2CD472J	J AA	4.7 kohms,1/6W
R256	VRS-TV2AB223J	J AA	22 kohms,1/10W
R257	VRD-ST2CD151J	J AA	150 ohms,1/6W
R258	VRD-ST2CD561J	J AA	560 ohms,1/6W
R259	VRS-TV2AB221J	J AA	220 ohms,1/10W
R260	VRD-ST2CD103J	J AA	10 kohm,1/6W
R261,262	VRD-ST2CD183J	J AA	18 kohms,1/6W
R263,264	VRD-ST2CD473J	J AA	47 kohms,1/6W
R265,266	VRD-ST2CD472J	J AA	4.7 kohms,1/6W
R267,268	VRS-TV2AB334J	J AA	330 kohms,1/10W
R269,270	VRD-ST2CD392J	J AA	3.9 kohms,1/6W

# WF-2100W

NO.	PART CODE	★ PRICE RANK	DESCRIPTION	NO.	PARTS CODE	★ PRICE RANK	DESCRIPTION
R271	VRS-TV2AB102J	J AA	1 kohm,1/10W	CN206	92L3471-000021	J	Connector Ass'y,2Pin
R272	VRS-TV2AB105J	J AA	1 Mohm,1/10W	CN501	92L3421-417002	J	Plug,2Pin
R273	VRS-TV2AB222J	J AA	2.2 kohms,1/10W	CN502	92L3421-880001	J	Connector Ass'y,13Pin
R274	VRS-TV2AB103J	J AA	10 kohm,1/10W	CON101	92L3101-171010	J AB	Plug,3Pin
R275	VRS-TV2AB472J	J AA	4.7 kohms,1/10W	CON201	92L3101-171010	J AB	Plug,3Pin
R276	VRD-ST2CD102J	J AA	1 kohm,1/6W	CON202	92L3101-171008	J AB	Plug,5Pin
R277	VRD-ST2CD333J	J AA	33 kohms,1/6W	CON401	92L3301-008001	J	Terminal,Speaker
R278	VRD-ST2CD102J	J AA	1 kohm,1/6W	CON501	92L3101-094001	J AB	Connector Ass'y,2Pin
R279	VRD-ST2CD151J	J AA	150 ohms,1/6W	CON502	92L3101-171012	J	Plug,13Pin
R280	VRS-TV2AB563J	J AA	56 kohms,1/10W	△ F601	92L5301-025002	J	Fuse,T4A L 250V
R281	VRS-TV2AB103J	J AA	10 kohm,1/10W	JK201	92L3202-036002	J	Jack,Mic
R282,283	VRD-ST2CD103J	J AA	10 kohm,1/6W	JK202	92L3201-080001	J	Jack,LINE Input
R284	VRD-ST2CD473J	J AA	47 kohms,1/6W	JK401	92L3202-036001	J	Jack,Headphones
R285	VRD-ST2CD822J	J AA	8.2 kohms,1/6W	M1(246-10)	92L195912301	J	Motor with Pulley [Tape]
R285	VRS-TV2AB223J	J AA	22 kohms,1/10W	MIC1	92L7201-002001	J AG	Built-in Microphone
R286	VRD-ST2CD473J	J AA	47 kohms,1/6W	△ SO601	92L3204-017001	J	Socket,AC Inlet
R287	VRD-ST2CD182J	J AA	1.8 kohms,1/6W	SW1(245-11)	92L54030204	J	Switch,Slide Type [Tape 2 Direction]
R288,289	VRD-ST2CD102J	J AA	1 kohm,1/6W	SW2(245-12)	92L4110-011002	J	Switch,Leaf Type [Tape 1 Play]
R290	VRS-TV2AB103J	J AA	10 kohm,1/10W	SW3(245-13)	92L4110-011001	J	Switch,Leaf Type [Tape 1 FF/REW]
R292	VRD-ST2CD472J	J AA	4.7 kohms,1/6W	SW4(245-14)	92L4110-011003	J	Switch,Leaf Type [Tape 1 Rec]
R293,294	VRD-ST2CD332J	J AA	3.3 kohms,1/6W	SW5(245-15)	92L4110-011001	J	Switch,Leaf Type [Tape 2 Play]
R295	VRD-ST2CD472J	J AA	4.7 kohms,1/6W	SW6(245-16)	92L4110-011001	J	Switch,Leaf Type [Tape 2 FF/REW]
R296,297	VRS-TV2AB102J	J AA	1 kohm,1/10W	SW101	92L4103-022001	J AF	Switch,Slide Type [Band Selector]
R298,299	VRD-ST2CD103J	J AA	10 kohm,1/6W	SW202	92L4103-025001	J	Switch,Slide Type [Beat Cancel]
R301	VRS-TV2AB102J	J AA	1 kohm,1/10W	SW203	92L4103-025002	J	Switch,Slide Type [Dubbing Speed/Mic/FM Mode]
R302	VRD-ST2CD103J	J AA	10 kohm,1/6W	SW401	92L4104-002001	J AF	Switch,Push Type [Surround]
R303-306	VRD-ST2CD222J	J AA	2.2 kohms,1/6W	SW501	92L4103-025003	J	Switch,Slide Type [Function Selector/Power]
R307	VRD-ST2EE221J	J AA	220 ohms,1/4W	△ SW601	92L4106-011001	J AH	Switch,Slide Type [Voltage Selector]
R308-310	VRD-ST2CD102J	J AA	1 kohm,1/6W				
R311,312	VRD-ST2CD332J	J AA	3.3 kohms,1/6W				
R313	VRD-ST2CD103J	J AA	10 kohm,1/6W				
R314	VRD-ST2CD121J	J AA	120 ohms,1/6W				
R315	VRS-TV2AB123J	J AA	12 kohms,1/10W				
R316	VRS-TV2AB103J	J AA	10 kohm,1/10W				
R317,318	VRD-ST2CD102J	J AA	1 kohm,1/6W				
R319	VRD-ST2CD331J	J AA	330 ohms,1/6W				
R320,321	VRS-TV2AB102J	J AA	1 kohm,1/10W				
R322	VRD-ST2CD123J	J AA	12 kohms,1/6W				
R323	VRS-TV2AB103J	J AA	10 kohm,1/10W				
R324-328	VRS-TV2AB102J	J AA	1 kohm,1/10W				
R329	VRD-ST2CD121J	J AA	120 ohms,1/6W				
R330,331	VRD-ST2CD184J	J AA	180 kohms,1/6W				
R333	VRD-ST2CD102J	J AA	1 kohm,1/6W				
R334-336	VRS-TV2AB102J	J AA	1 kohm,1/10W				
R401,402	VRS-TV2AB104J	J AA	100 kohm,1/10W				
R403	VRD-ST2CD103J	J AA	10 kohm,1/6W				
R404	VRS-TV2AB103J	J AA	10 kohm,1/10W				
R405	VRD-ST2CD272J	J AA	2.7 kohms,1/6W				
R406	VRS-TV2AB272J	J AA	2.7 kohms,1/10W				
R407-410	VRS-TV2AB123J	J AA	12 kohms,1/10W				
R411	VRD-ST2EE331J	J AA	330 ohms,1/4W				
R412	VRS-TV2AB103J	J AA	10 kohm,1/10W				
R413	VRD-ST2CD103J	J AA	10 kohm,1/6W				
R415,416	VRD-ST2CD332J	J AA	3.3 kohms,1/6W				
R417,418	VRS-TV2AB223J	J AA	22 kohms,1/10W				
R419,420	VRS-TV2AB332J	J AA	3.3 kohms,1/10W				
R421,422	VRS-TV2AB102J	J AA	1 kohm,1/10W				
R425-428	VRD-ST2EE2R2J	J AA	2.2 ohms,1/4W				
R429,430	VRD-ST2EE221J	J AA	220 ohms,1/4W				
R431,432	VRS-TV2AB153J	J AA	15 kohms,1/10W				
R433	VRD-ST2CD153J	J AA	15 kohms,1/6W				
R507	VRS-TV2AB473J	J AA	47 kohms,1/10W				
R508	VRS-TV2AB392J	J AA	3.9 kohms,1/10W				
R509	VRS-TV2AB331J	J AA	330 ohms,1/10W				
R510	VRS-TV2AB104J	J AA	100 kohm,1/10W				
R511	VRD-ST2CD103J	J AA	10 kohm,1/6W				
R512	VRS-TV2AB103J	J AA	10 kohm,1/10W				
R513,514	VRD-ST2CD103J	J AA	10 kohm,1/6W				
R519	VRD-ST2CD103J	J AA	10 kohm,1/6W				
R520,521	VRS-TV2AB563J	J AA	56 kohms,1/10W				
R522,523	VRD-ST2CD103J	J AA	10 kohm,1/6W				
R524	VRD-ST2CD472J	J AA	4.7 kohms,1/6W				
<b>OTHER CIRCUITRY PARTS</b>							
CN101	92L3421-180003	J	Connector Ass'y,3Pin	201	92L20021000101	J	Front Cabinet [WF-2100W (S)]
CN201	92L3421-882001	J	Connector Ass'y,3Pin	201	92L20021000103	J	Front Cabinet [WF-2100W (BK)]
CN202	92L3421-879001	J	Connector Ass'y,5Pin	202	92L20221000101	J	Rear Cabinet [WF-2100W (S)]
CN203	92L3461-000076	J	Flat Wire,6Pin	202	92L20221000102	J	Rear Cabinet [WF-2100W (BK)]
CN204	92L3461-000078	J	Flat Wire,7Pin	203	92L21021000101	J	Battery Compartment Lid [WF-2100W (S)]
CN205A/B	92L3421-887002	J	Connector Ass'y,7/7Pin	203	92L21021000102	J	Battery Compartment Lid [WF-2100W (BK)]
				204	92L21121000101	J	Cassette Holder [Tape 1] [WF-2100W (S)]
				204	92L21121000102	J	Cassette Holder [Tape 1] [WF-2100W (BK)]
				205	92L21121000201	J	Cassette Holder [Tape 2] [WF-2100W (S)]
				205	92L21121000202	J	Cassette Holder [Tape 2] [WF-2100W (BK)]
				206	92L23021000101	J	Panel,Display
				207	92L24021000101	J	Dial Pointer
				208	92L24821000101	J	Handle [WF-2100W (S)]
				208	92L24821000102	J	Handle [WF-2100W (BK)]
				209	92L26021000101	J	Window,Dial Pointer
				210	92L26121000101	J	Panel,Cassette Holder [Tape 1]
				211	92L26721000101	J	Lens,Volume Knob
				212	92L27021000101	J	Knob,Tuning
				213	92L27021000201	J	Knob,Fine Tuning
				214	92L27221000A01	J	Button,F FWD [Tape 2] [WF-2100W (S)]
				214	92L27221000A02	J	Button,F FWD [Tape 2] [WF-2100W (BK)]
				215	92L27221000B01	J	Button,Stop/Eject [Tape 2] [WF-2100W (S)]
				215	92L27221000B02	J	Button,Stop/Eject [Tape 2] [WF-2100W (BK)]
				216	92L27221000C01	J	Button,Direction [Tape 2] [WF-2100W (S)]
				216	92L27221000C02	J	Button,Direction [Tape 2] [WF-2100W (BK)]
				217	92L27221000101	J	Button,Record [Tape 1] [WF-2100W (S)]
				217	92L27221000102	J	Button,Record [Tape 1] [WF-2100W (BK)]
				218	92L27221000201	J	Button,Play [Tape 1] [WF-2100W (S)]



## WF-2100W

NO.	PART CODE	★	PRICE RANK	DESCRIPTION
	92L579QT800126	J	AB	Label,Japan,for Packing Case
	92L579QT800128	J		Label,Hong Kong [For Hong Kong Only]
	92L57921000101	J		Label,Bar Code [WF-2100W (S)]
	92L57921000102	J		Label,Bar Code [WF-2100W (BK)]
	92L57921000103	J		Label,Safety [For Hong Kong Only]
	92L57921000201	J		Label,Feature
	92L57921000202	J		Label,Feature
	92L58021000102	J		Operation Manual [Except for Russian]
	92L58021000103	J		Operation Manual [For Russian]
	92L59021000101	J		Warranty Card [For Philippines Only]

### P.W.B. ASSEMBLY (Not Replacement Item)

PWB-A1	92L370101G040A	J	—	Main (PWB Only)
PWB-A2	92L370101G040B	J	—	Graphic Equalizer (PWB Only)
PWB-A3	92L370101G040C	J	—	Fine Tuning (PWB Only)
PWB-A4	92L370101G040E	J	—	Battery A (PWB Only)
PWB-A5	92L370101G040F	J	—	Battery B (PWB Only)
PWB-B	92L370101G050	J	—	Power (PWB Only)

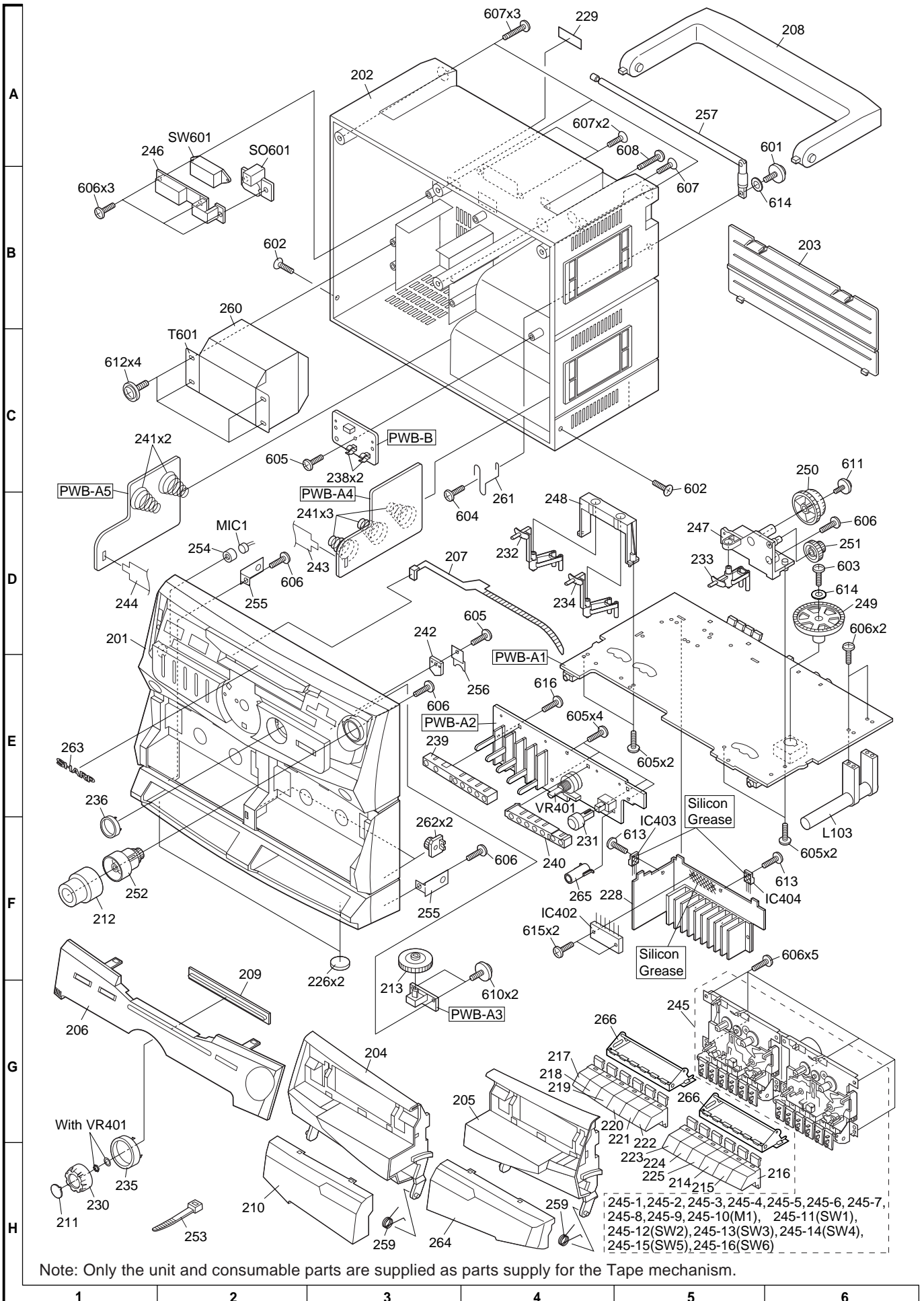

Figure 6 CABINET EXPLODED VIEW

# WF-2100W

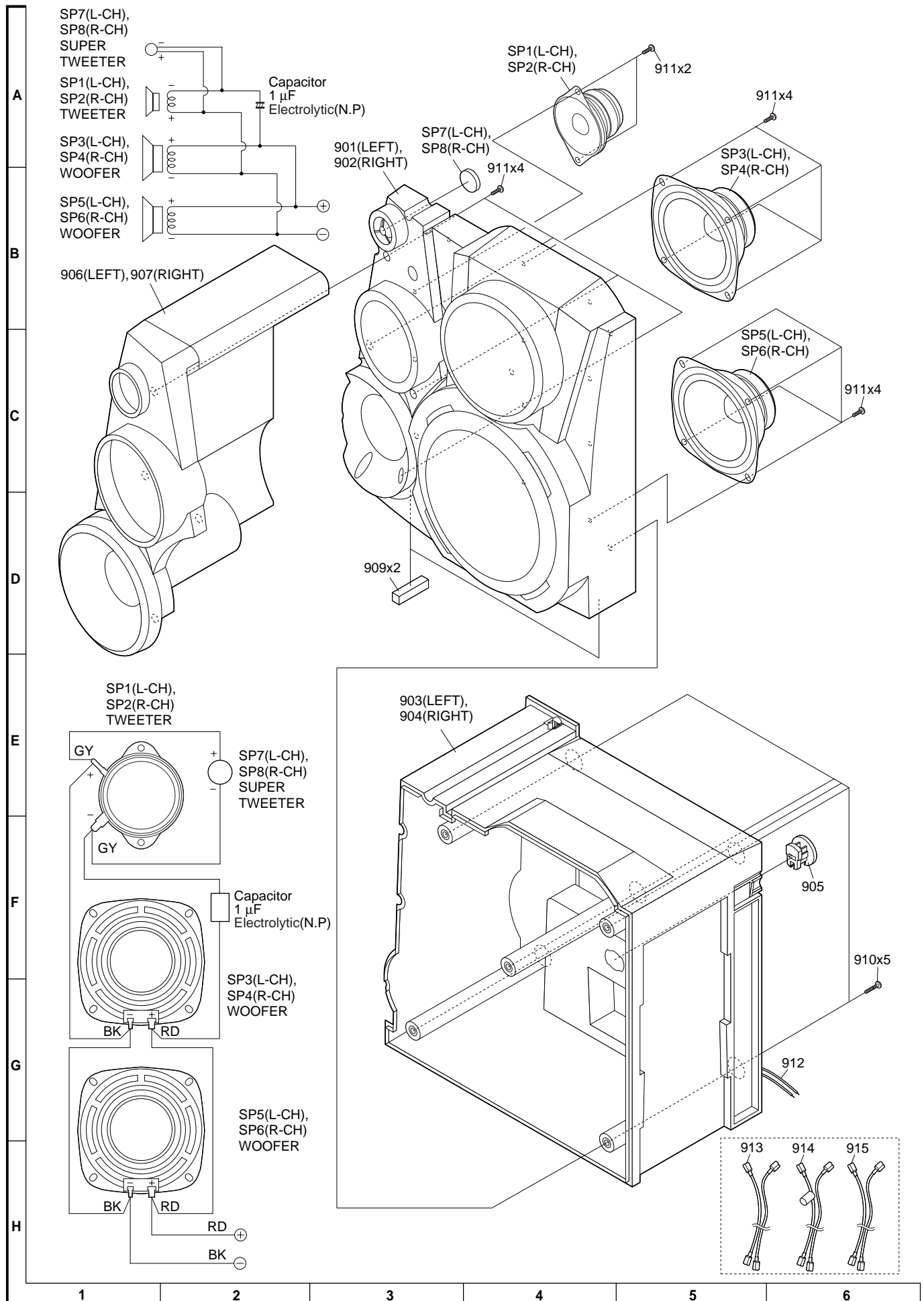

Figure 7 SPEAKER EXPLODED VIEW

— M E M O —

# SHARP

**COPYRIGHT © 2002 BY SHARP CORPORATION**

**ALL RIGHTS RESERVED.**

No part of this publication may be reproduced, stored in a retrieval system, or transmitted in any form or by any means, electronic, mechanical, photocopying, recording, or otherwise, without prior written permission of the publisher.

**SHARP CORPORATION**  
**AV Systems Group**  
**Audio Systems Division**  
**Higashihiroshima, Hiroshima 739-0192, Japan**  
**Printed in Japan**

**A0204-627DS•HA•C**

**EX**